



# QUICK CHANGERS

Datasheet

22<sup>nd</sup> November 2019

Quick Changer

Quick Changer  
for I/O

Dual Quick  
Changer

Quick Changer  
- Tool side

If not specified, the data represent the combination of the different Quick Changer types/sides.

Technical data	Min	Typical	Max	Units
Permissible force*	-	-	400*	[N]
Permissible torque*	-	-	50*	[Nm]
Rated payload*	-	-	20* 44	[kg] [lbs]
Repeatability	-	-	±0.02	[mm]
IP Classification	64			
Operating life (Tool change)	-	5.000	-	[cycles]
Operating life (Robot operation)	10	-	-	[M cycles]

\* See load capacity graph on the next page.

	Quick Changer	Quick Changer for I/O	Dual Quick Changer	Quick Changer - Tool Side	Units
Weight	0.06	0.093	0.41	0.14	[kg]
	13.22	2.05	90.39	30.86	[lb]
Dimensions	See Mechanical dimension section				[mm] [inch]

### Load capacity

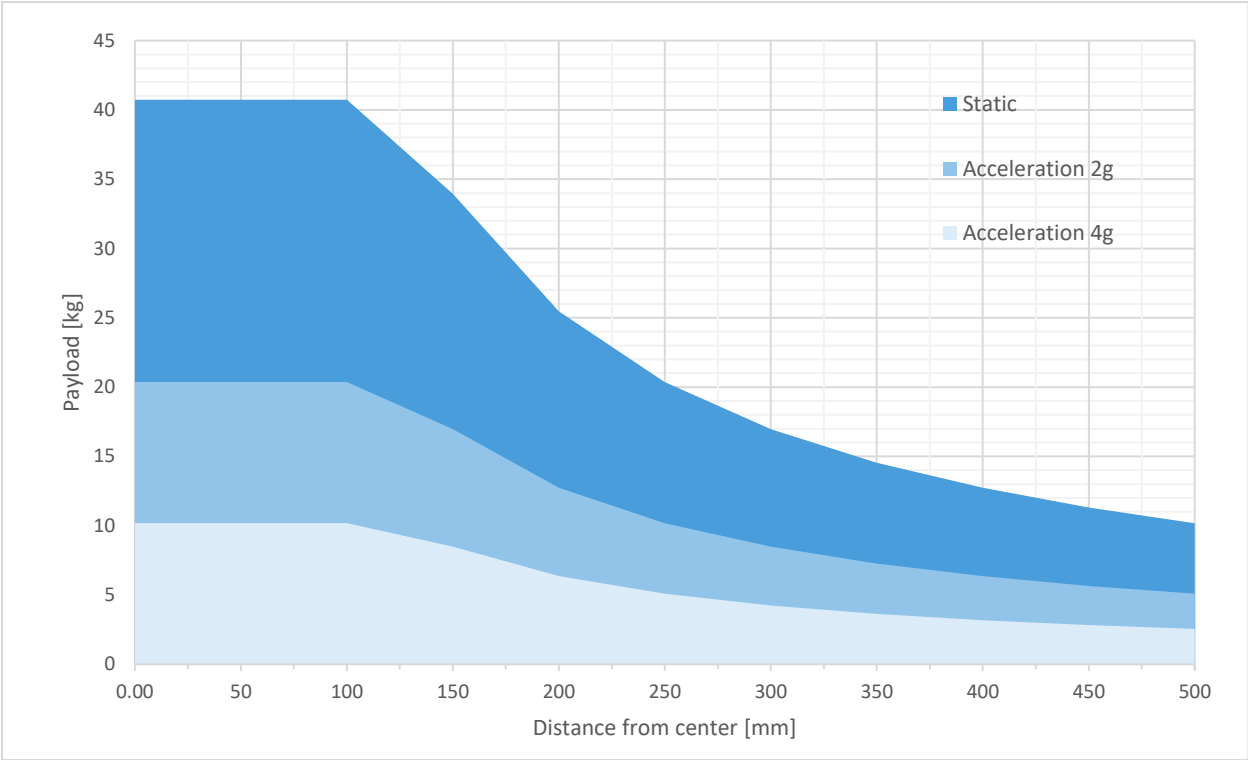

Quick Changer  
- Robot side

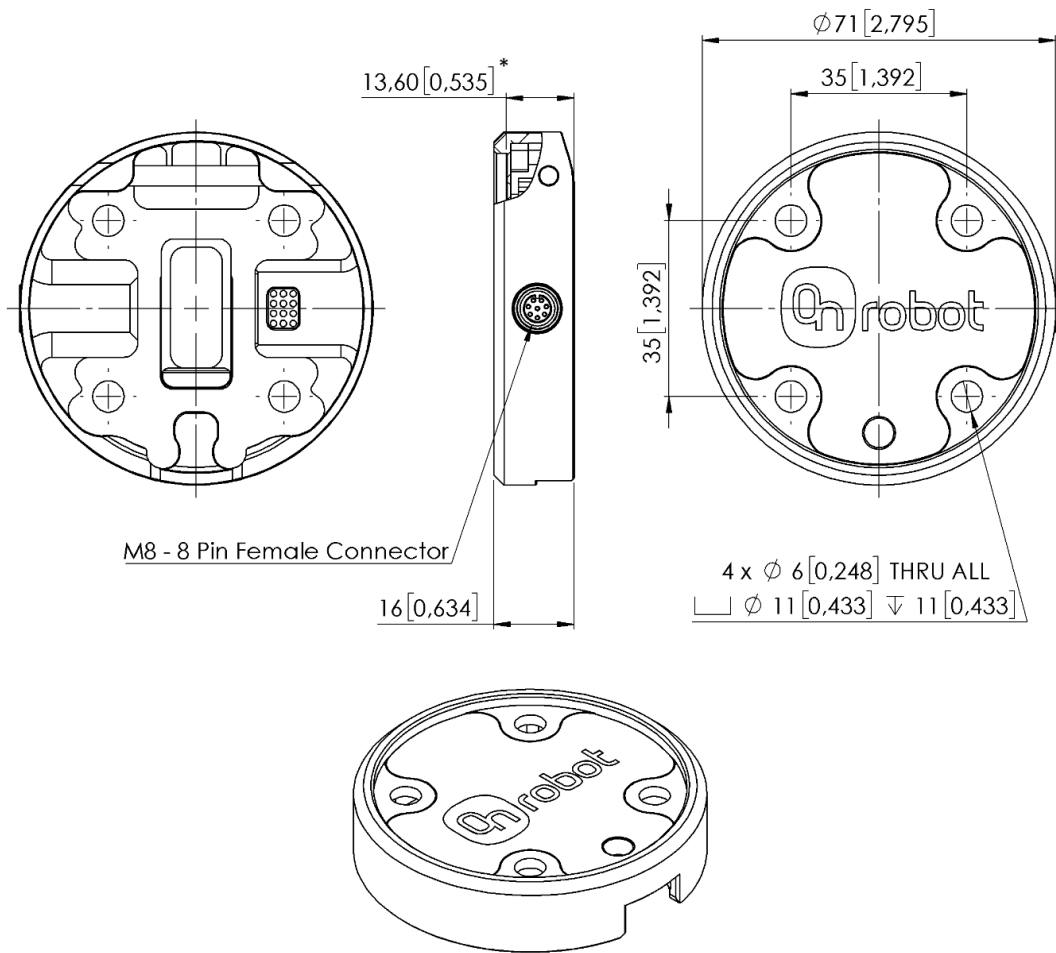

\* Distance from Robot flange interface to OnRobot tool.

All dimensions are in mm and [inches].

**Quick Changer  
for I/O - Robot  
side**

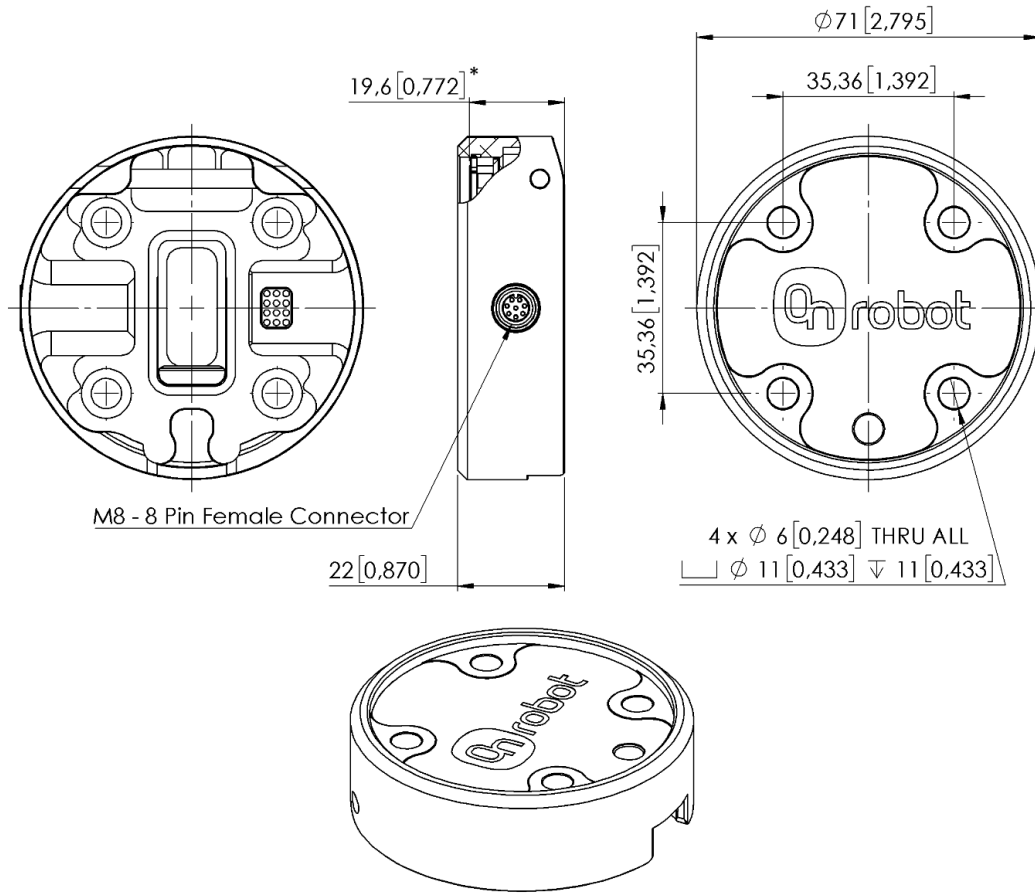

\* Distance from Robot flange interface to OnRobot tool  
All dimensions are in mm and [inches].

## Dual Quick Changer

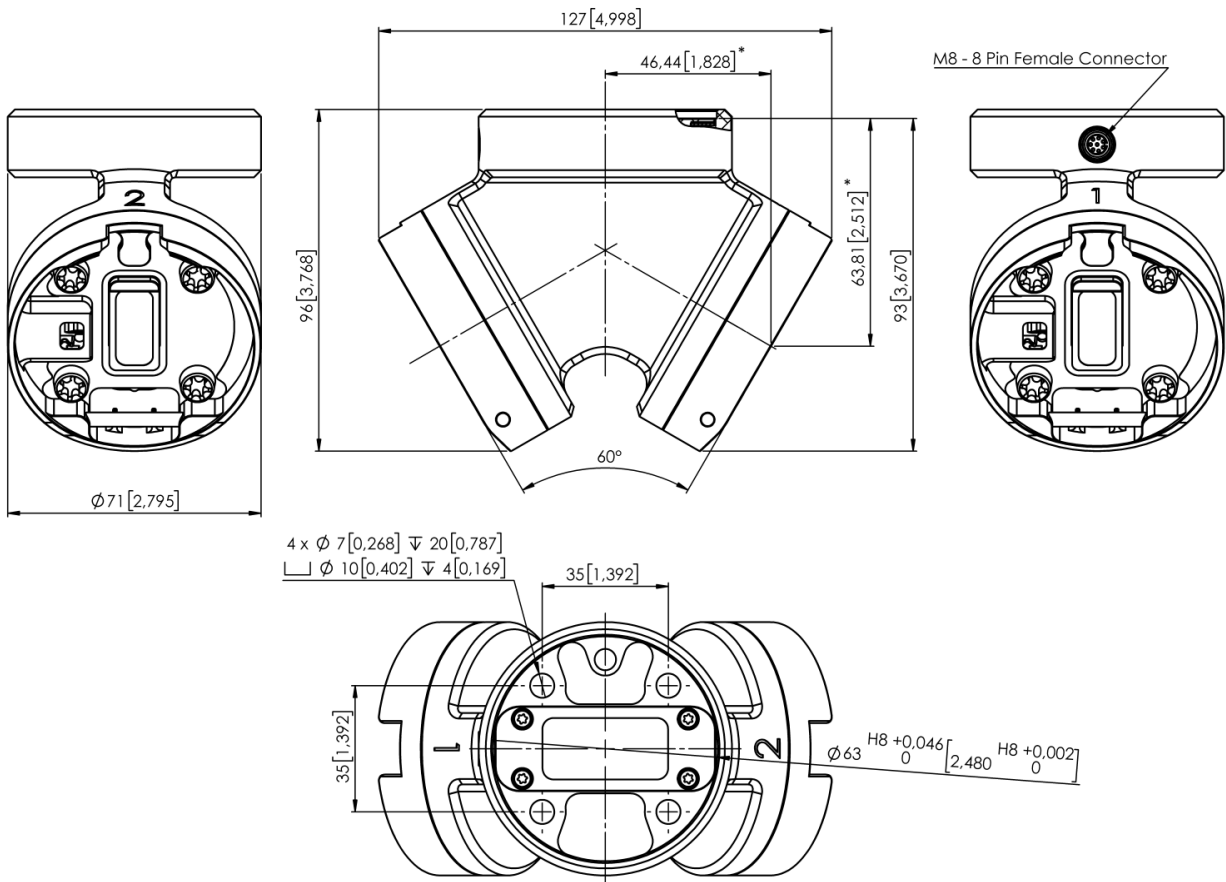

\* Distance from Robot flange interface to OnRobot tool

All dimensions are in mm and [inches].

Quick Changer  
- Tool side

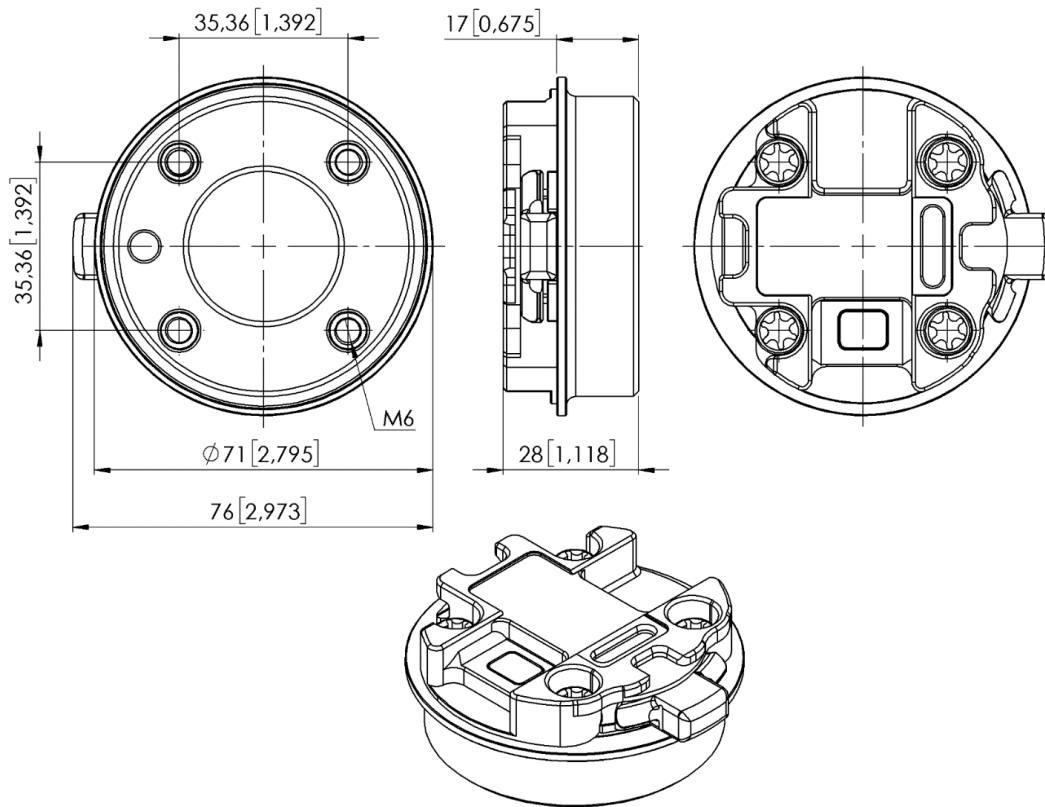

All dimensions are in mm and [inches].