



Under Drive Lifting Mobile Robot - W300

INS + QR Code Navigation + Load 300Kg

Product feature

1. Using QR code navigation, laying two-dimensional code on the ground, combining with the inertial navigation system for positioning and correction, can reach accurate positioning of ± 10 mm..
2. The load weight can reach 500kg, and most of the goods can be transported by jacking, rotating.
3. The equipment adopts the modular design of the whole machine, which makes the assembly and maintenance more convenient.
4. The battery can last for ≥ 8 hours with full load, and the robot can automatically charge with low power (set the low power value according to the customer's requirements).



- Cluster scheduling, in the robot control system, can view the working status, battery energy, location and other information of all robots at the same time, and schedule all devices through the system.
- Equipped with lidar safety barrier avoidance, front contact anti-collision bar, left and right emergency stop buttons, multiple safety protection to protect equipment and cargo safety.
- Path planning in system, realize unmanned operation, staff only need to give instructions through the control terminal.

Dimension

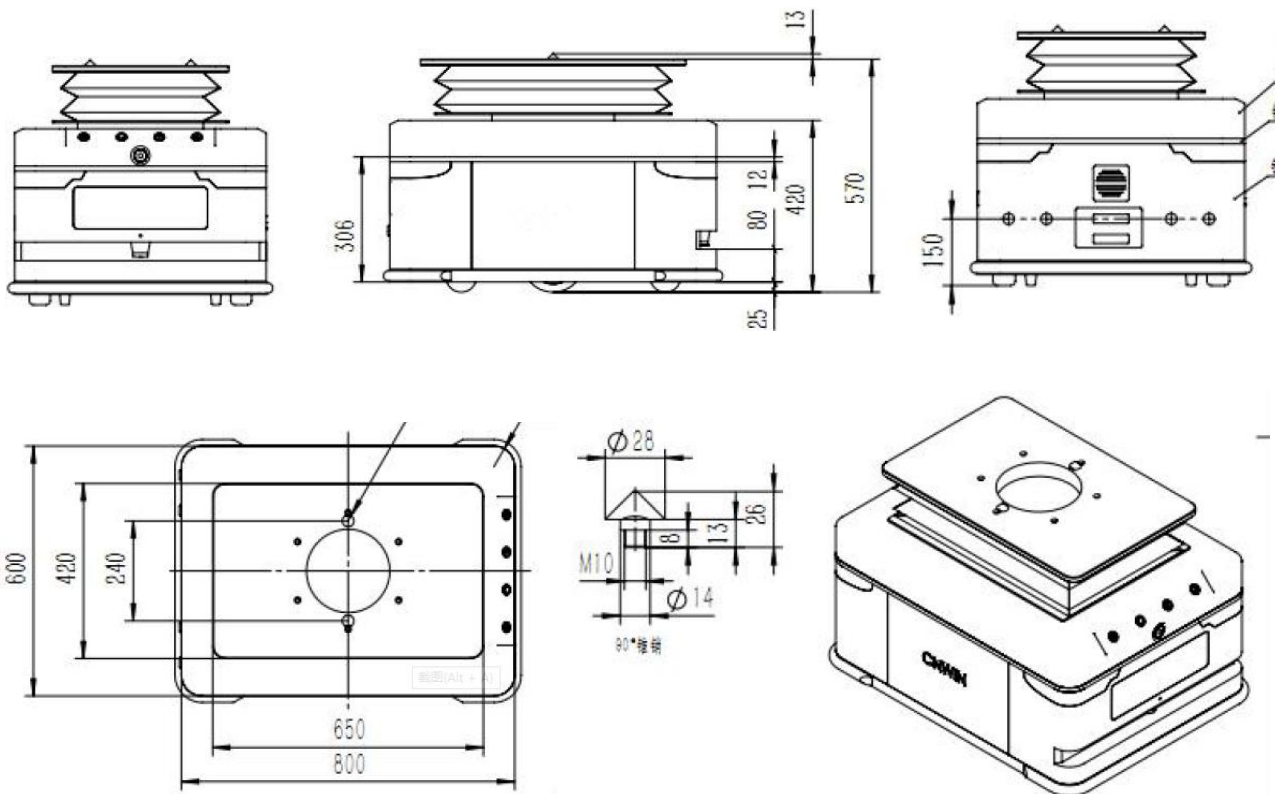

Specification



Basic parameter	Model	W300
	Weight	≤200KG
	Rated Weight	300KG
	Dimension(L*W*H)	800*600*570mm(Without Bumper)
	Lifting Height	≤60mm
	Navigation Mode	QR Code Navigation
	Drive Mode	Servo motor+Double wheel differential drive
Parameters	Positional Accuracy	±10mm
	Max.Speed(no load)	1.2m/s
	Running Speed(full load)	1.0m/s
	Trafficability	30mm gap
	Gradeability	≤2°
	Communication Mode	Wireless Communication
	Debug Interface	Open Interface
Battery	Charging Mode	Automatic/Offline charging(optional)
	Endurance	≥8h
	Battery Type	Lithium iron Phosphate
	Battery Capacity	48V ≥30AH
	Charging Time	1.5~2h
	Charging Time	1500 Cycles , Capacity≥80%
Safe	Walking Mode	Forward, backward, rotate in place
	Obstacle Avoidance	Laser obstacle sensor, Emergency stop button, Mechanical anti-collision strip
	Audible Alarm	Support
	Emergency Switch	1



深圳市井智高科机器人有限公司
Shenzhen Wellwit Robotics Co.,Ltd.



Address: 2F, building D, shengjianli Industrial Park, Dafu
community, Guanlan street, Longhua District, Shenzhen
Tel: 0755-8529-0005
Email:sales@wellwit.com.cn
website:www.wellwit.com.cn/en

