

Shibuya Hoppmann™

Standard Products Catalog

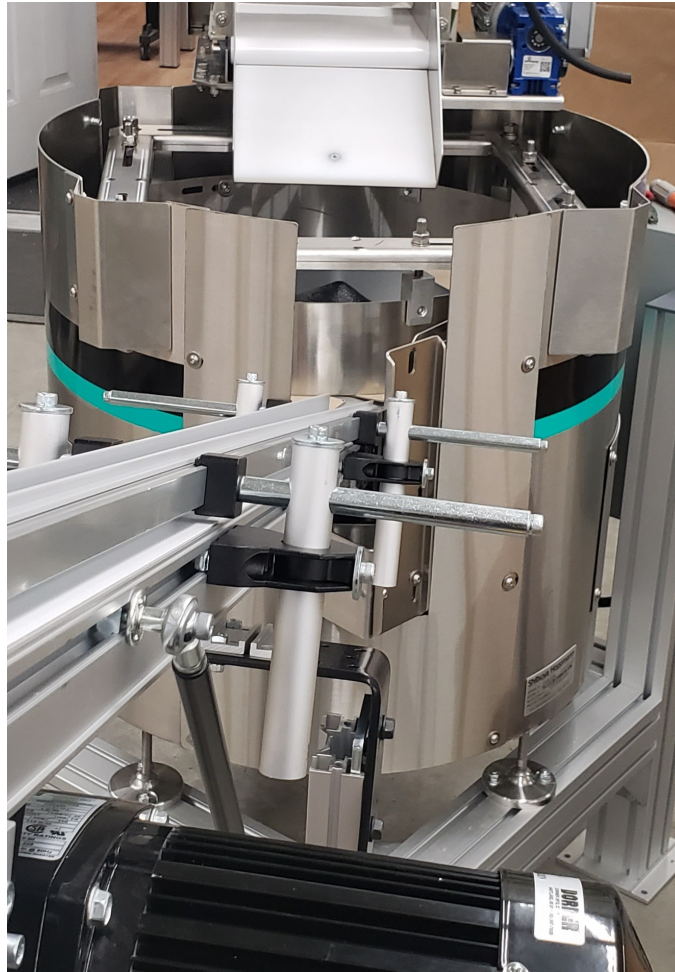

Trusted Solutions • Complete Integration • Engineering & Installation • Parts Sales & Services



INNOVATE > INTEGRATE > AUTOMATE | 800.916.0031 | flex-lineautomation.com

CUSTOMER.SERVICE@FLEX-LINEAUTOMATION.COM

Shibuya Hoppmann™

Contact Information:

Box Sales, contact Linda Marsh



Linda Marsh
Contracts Administrator

lmarsh@shibuyahoppmann.com
317.322.0754

OEMs and Dealers, contact Nick White



Nick White
OEM Manager

nwhite@shibuyahoppmann.com
317.322.0754

Service and Spares, contact our Customer Support Group:



Wendy Watts
Spare Parts Coordinator –
Customer Support

wwatts@shibuyahoppmann.com
434.929.4746, ext. 2225



Mary Galvin
Service Coordinator –
Customer Support

mgalvin@shibuyahoppmann.com
540.829.5637

Headquarters
7849 Coppermine Dr.
Manassas, VA
20109
540.829.2564 t
800.368.3582 t
540.829.1726 f

Sales
1445 Brookville Way
Suite F
Indianapolis, IN 46239
317.322.0754 t
800.368.3582 t
317.322.0794 f

Manufacturing
291 Dillard Road
Madison Heights, VA
24572
434.929.4746 t
800.543.0915 t
434.929.4959 f

Shibuya Hoppmann™

About Shibuya Hoppmann

Shibuya Hoppmann is at the forefront of automated systems development. With advanced technology and proven methods, our expert engineers and qualified staff work closely with our clients to evaluate and solve your specific and often unique needs.

We design and manufacture:

- Aseptic Fillers
- Beverage Fillers
- E-Beam Aseptic Filling System
- Cappers
- Centrifugal Feeders and Prefeeders
- Continuous Motion Assembly Systems
- Indexing and Placement Assembly Systems
- Isolator/Robotic Decontamination Units
- Print & Apply, Pressure-Sensitive Label Applicators
- Rotary and Inline Labelers

We offer reliable, world leading technologies to many industries, including pharmaceutical, cosmetic, household, food and beverage, confectionery, personal care and electronics.

Philosophy

Our three main concepts:

- Innovative ideas and technology
- Long-standing, reliable product choices
- Consistent and dependable customer service

Through a commitment to maintaining talented associates and state-of-the-art equipment, we provide advanced technology research, design and development services to help our clients meet their objectives and best execute their projects.

Innovation

Innovation is what our engineers do best. **They recognize your needs and use original, creative ideas with world-leading technology to meet them.** We are constantly improving and integrating more effective and efficient technology for our clients.

Research and Development

Through active research and development of technology solutions, we continuously acquire knowledge that benefits our company and our clients in the future. **Our product line is constantly improving to better meet the needs of the industry and improve efficiency for our customers.** Our Research and Development Team are recognized leaders of tomorrow's integrated systems solutions: Solutions that help to address problems and opportunities within the industry.

Safety Precautions and Warnings

Shibuya Hoppmann equipment has been designed to be as safe as possible for operators. However, even well-built machines can be installed or operated in a hazardous manner. Safety precautions must be observed by users.

Specific Warnings and Cautions



Do Not Service the Machine. The voltages in our equipment can cause serious injury or death. Service should be performed only by properly qualified service personnel.



Install Safety Covers. To reduce the risk of injury from moving parts, never operate the system unless all safety covers are in place.



Dress Properly. To reduce the risk of injury from moving parts, secure loose clothing. Do not wear jewelry or neckties near the equipment. Wear safety glasses or other protective eye wear when operating or performing maintenance on the system.



Avoid Moving Parts. Never place anything in the machine except the handled part(s) for which it was designed. Never put your hands, tools or other objects into the machine.



Turn Off Power and Air. Before performing maintenance on the machine, ensure that power and air cannot be accidentally turned back on. Padlock and clearly tag the main electrical and pneumatic disconnect(s) before adjusting or replacing changeover parts or performing maintenance.

Do Not Speed Up the Prefeeder. Never raise the prefeeder speed to increase the delivery rate. Too many parts in the feeder may prevent it from operating properly.

Avoid Solvents. Do not use solvents for cleaning unless specified, as they may damage surfaces, causing jams and lowered output rates.

Avoid Routine Use of EMERGENCY STOP or E-STOP. Use of emergency stop or e-stop to shut down the system may cause jams or misoriented parts.

Shibuya Hoppmann Corporation strives to improve its products and reserves the right to change or discontinue specifications & designs shown in this catalog without notice and without incurring obligation.

Shibuya Hoppmann™

Table of Contents

	Page		Page
Introduction	3	<i>FT Series (continued):</i>	
Safety Precautions/Warnings	4	FT-30-RD Centrifugal Feeder	35
Table of Contents	5	FT-40-RD Centrifugal Feeder	36
Prefeeder Introduction	7	FT-50-RD Centrifugal Feeder	37
<i>Overhead Prefeeders:</i>		FT-60-RD Centrifugal Feeder	38
LB-01	8	<i>FS Series:</i>	
LB-03/06.....	9	FS-20-RD Centrifugal Feeder	39
<i>Elevating Prefeeders:</i>		FS-30-RD Centrifugal Feeder	40
ET-02/06	10	FS-40-RD Centrifugal Feeder	41
EP-04/06	11	FS-50-RD Centrifugal Feeder	42
EP-08/15/25	12	FS-60-RD Centrifugal Feeder	43
EP-10/20/30	13	<i>FR Series:</i>	
EP-35/50	14	FR-20 Centrifugal Feeder	44
<i>Horizontal Discharge/Elevating Prefeeders:</i>		FR-30 Centrifugal Feeder	45
EH-08/15/25	15	<i>Food Grade Series:</i>	
EH-08/15/25	16	FTF-30-RD Centrifugal Feeder	46
<i>Specialty Prefeeders:</i>		FTF-40-RD Centrifugal Feeder	47
TP-30 Trough Prefeeder	17	FTF-50-RD Centrifugal Feeder	48
WB-6 Wide Belt Prefeeder.....	18	<i>Specialty Feeder Units:</i>	
WEP-40 Wide Belt Elevating Prefeeder....	19	FRS-60 Centrifugal Feeder	49
WEP-80 Wide Belt Elevating Prefeeder....	20	FD-30 Rotary Accumulation Table	50
WEP-120 Wide Belt Elevating Prefeeder....	21	FT-15-HD Heavy Duty Feeder	51
EC-Series Bulk Product Conveyor	22	CapStar Cap Feeder	52
Prefeeder Options and Accessories		Feeder Options and Accessories	
Hopper & Elevator Extensions	23	FR Series Feeder Air Ramps	54
Replacement Prefeeder Belts	24	Lexan Safety Covers	54
Lexan Elevator Covers	25	Urethane Scallop Kits	54
Lexan Hopper Covers	27	Feeder Technical Engineering Data	55
Hopper Agitators	27	Labeler Introduction	51
Belt/Chain Upgrades	27	L200A Label Applicator	58
Casters	27	L410A Label Applicator	59
Control Packages	27	L510A Label Applicator	60
Prefeeder Technical Engineering Data	28	L3500PA Label Applicator	61
Feeder Introduction	31	Motor Specifications	62
<i>FT Series:</i>		Shibuya Hoppmann Warranty	67
FT-10-RD Centrifugal Feeder	32		
FT-15-RD Centrifugal Feeder	33		
FT-20-RD Centrifugal Feeder	34		

Shibuya Hoppmann™



LB Series Prefeeder

Prefeeders

Shibuya Hoppmann has been building, designing and improving upon a variety of prefeeders for years and has a wide selection of prefeeders that will meet your part specific requirements.

Based on the needs and scope of change We have created several overhead prefeeders (LB-01 and LB-03/06), designed to handle small to medium sized parts and are engineered to interface directly with smaller style parts feeders.



EP Series Prefeeder

The EP Series elevating style prefeeders handle small, medium and large parts and deliver product at belt speeds between 23 and 35 feet per minute. The elevating prefeeders use cleated belts at varying pitches and heights to bring product from floor level up into the feeding application.

The EH-08/15/25 and EH-35/50, are innovative horizontal discharge, elevating prefeeders designed using a modular, plastic, cleated chain to vertically and horizontally transport parts. The EH's multi-dimensional discharge is closer to the feeder bowl, eliminating potential scraping of parts and is able to reach over existing equipment via the horizontal discharge chute.

The trough style prefeeders, the WB-06 and TP-30, use flat conveyor type belts to deliver the more fragile and intricate parts, or food products, into the feeding application.



WB Prefeeder

Large parts prefeeders, such as the WEP-40 and WEP-80, are designed with independently controlled variable speed drives which control the live bottom hopper conveyor belt and cleated elevating belt. The hopper capacities are large and the average belt speed of 23 feet per minute combined with the cleat pitch of 12", allows for maximum product loading.

Live Bottom Prefeeder

Product Overview:

Shibuya Hoppmann's standard LB-01 overhead prefeeder is specially designed to handle small parts and is engineered to interface directly with smaller style parts feeders. A variable speed motor drives the belt at a speed of 23.00 inches per minute. Note: Controllers are not supplied with this unit.



Part Number	LB01XXXDSA	LB01XXXASA
Motor Style	DC	AC
Motor Voltage	90VDC	208-230/460V
Horsepower	1/30hp	.12hp
Total Equipment Weight	35 lbs. / 16 kg	
Hopper Capacity	1 ft ³ / 28.32 liters	

Standard Features:

- Stainless steel construction
- Durable reinforced black neoprene belt with fiberglass cord
- Feeder mounting brackets

Available Options:

- Continuous welded seams
- Hopper covers
- Tan neoprene USDA/FDA dry contact food belt with fiberglass cord (Food Grade Unit: LB01XXXDFA)
- NEMA 1 encased controller

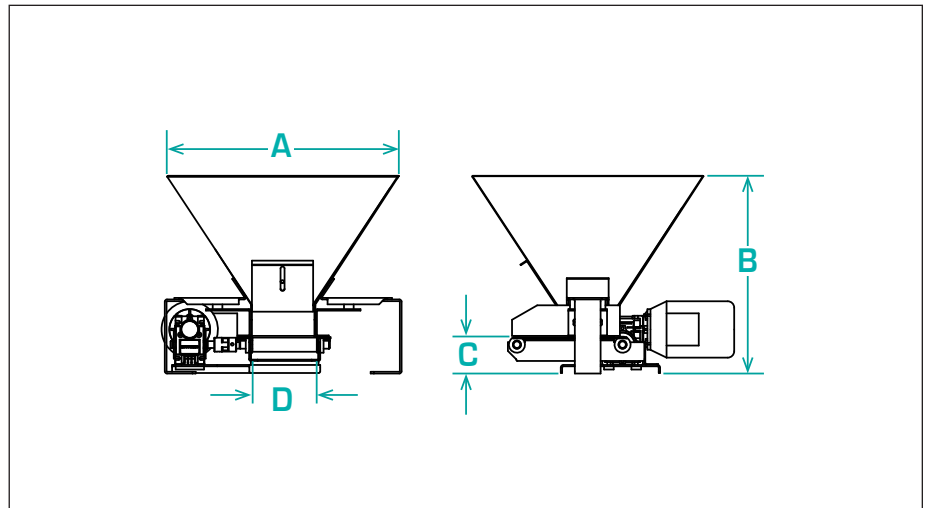

Product Specifications		ANSI	Metric
A	Hopper Width and Length	17.93" x 17.93"	455.4 x 455.4mm
B	Overall Height	15.35"	389.9mm
C	Discharge Height	2.83"	71.9mm
D	Belt Width	5.00"	127mm



Product Overview:

Shibuya Hoppmann's standard LB-03 and LB-06 overhead prefeeders are designed to handle small to medium sized parts and are engineered to interface directly with smaller style parts feeders. A variable speed motor drives the belt at a speed of 23.00 inches per minute. Note: Controllers and mechanical level sensors are not supplied with this unit.

Part Number	LB03XXXDSA	LB03XXXASA
Motor Style	DC	AC
Motor Voltage	90V	208-230/460V
Horsepower	1/30hp	1/8hp
Total Equipment Weight	110 lbs. / 50 kg	
Hopper Capacity (LB-3)	3 ft ³ / 85 liters	
Hopper Capacity (LB-6)	6 ft ³ / 170 liters	

Standard Features:

- Stainless steel construction
- Durable reinforced black neoprene belt with fiberglass cord
- Feeder mounting brackets

Available Options:

- Continuous welded seams
- Hopper covers
- Continuous welded hopper seams
- Tan neoprene USDA/FDA dry contact food belt with fiberglass cord (Food Grade Unit: LB03XXXDFA and LB03XXXAFA)
- NEMA 1 encased controller

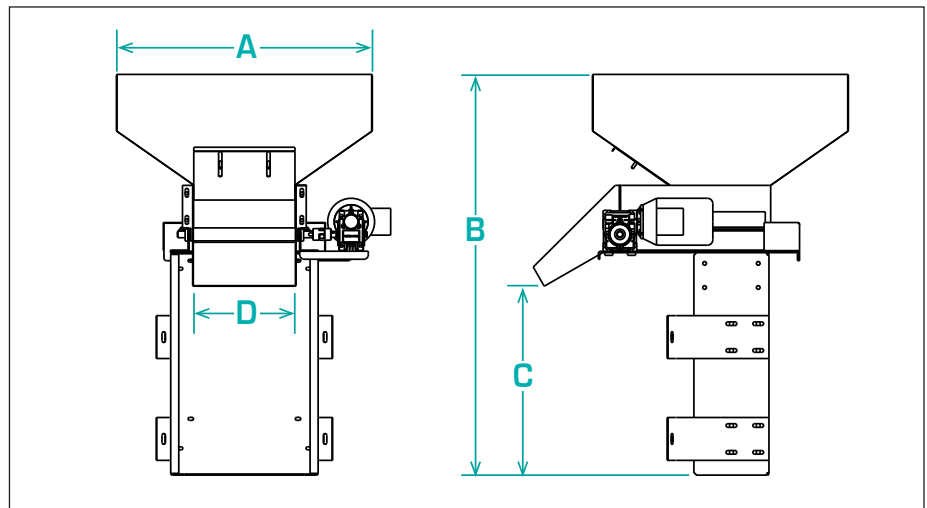

Product Specifications		ANSI	Metric
A	Hopper Width and Length	23.87" x 23.87"	606.3 x 606.3mm
B	Overall Height – LB-03	37.38"	949.5mm
B	Overall Height – LB-06	47.38"	1203.5mm
C	Discharge Height	17.62"	447.5mm
D	Belt Width	9.53"	242.1mm

Shibuya Hoppmann™

ET-02 Table Top Elevating Prefeeder



Product Overview:

The Shibuya Hoppmann ET-02 Elevating Table Top Prefeeder is designed to handle a variety of small sized, light weight parts with both an adjustable base and head chute to accommodate small product loading and delivery variances. The concept is based on the standard sized elevating prefeeders but has a more compact footprint and can be mounted on top of an existing support table.

Part Number	ET0206XDSA	ET0206XASA
Motor Style	DC	AC
Motor Voltage	90/180V	220/380V
Horsepower	1/5hp	1/4hp
Total Equipment Weight	185 lbs. / 83.9 kg	
Hopper Capacity (ET-02/04/06)	1 ft ³ / 2 ft ³ / 3 ft ³ (28 / 56 / 85 liters)	

Standard Features:

- Stainless steel construction
- Belt (6" width belt, 4" pitch with 1.5" cleat) FDA/USDA approved white 1-ply solid woven polyester fabric with 1/16" thick white PVC coating and PVC cleats
- Hopper cleanout door

Available Options:

- 1/5 hp 90/180V DC Motor
- Safety cover package
- Elevator extensions available in 12" increments
- Hopper extensions available
- Optional belt styles and widths - Standard cleat for 85° til, blue sanitary belt, super cleat belt

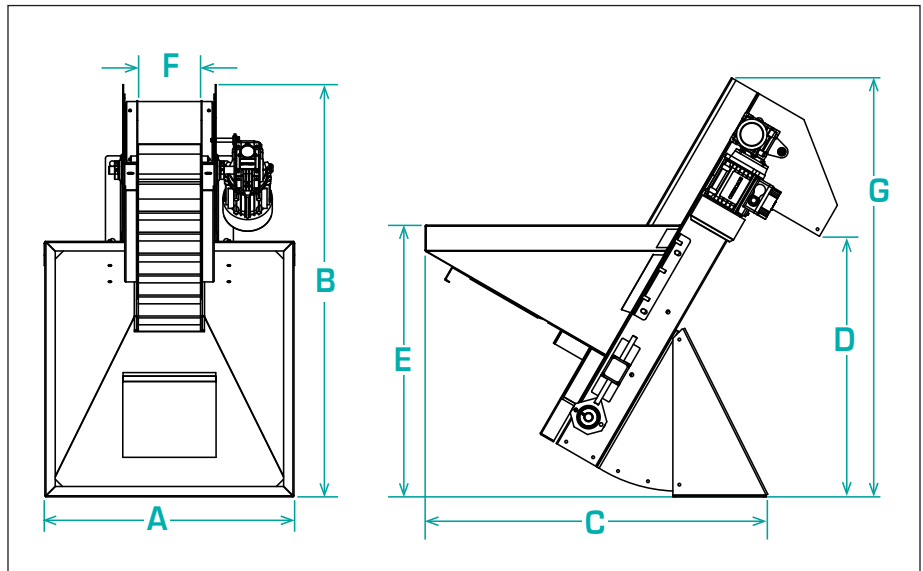

Product Specifications		ANSI	Metric
A	Overall Width	24.03"	610.3mm
B	Overall Length	39.77"	1010.2mm
C	Lower Footprint	32.90"	835.7mm
D	Discharge Height	25.13"	638.3mm
E	Hopper Load Height (Varies)	26.21"	665.7mm
F	Belt Width	6.00"	152.4mm
G	Overall Height	40.43"	1026.9mm



Product Overview:

The EP-04/EP-06 elevating prefeeder is designed to handle a variety of small, lightweight parts. Its 4 ft³ capacity hopper delivers product at an average belt speed of 35'/minute. The cleated elevator belt has a nominal cleat height of 1.50" and a cleat pitch of 6.00" allowing for maximum product loading. A heavy duty variable speed motor helps to ensure proper product metering. Note: Controllers and mechanical level sensors are not supplied with this unit.

Part Number	EP0406XDSA	EP0406XASA
Motor Style	DC	AC
Motor Voltage	130V	208-230/460V
Horsepower	1/4hp	1/4hp
Total Equipment Weight	250 lbs. / 113.4 kg	
Hopper Capacity (EP-04 / EP-06)	4 ft ³ – 6 ft ³ / 113 – 170 liters	

Standard Features:

- Stainless steel construction
- Belting is FDA/USDA approved white 1-ply solid woven polyester fabric with .156" thick white PVC coating and PVC cleats

Available Options:

- Elevator extensions*
- Hopper extension for 6 ft³ capacity
- Continuous welded hopper seams
- Elevator/hopper covers
- Washdown motor
- NEMA 1 encased controller
- Pneumatic hopper agitator (#AGITATOREP04)
- Casters

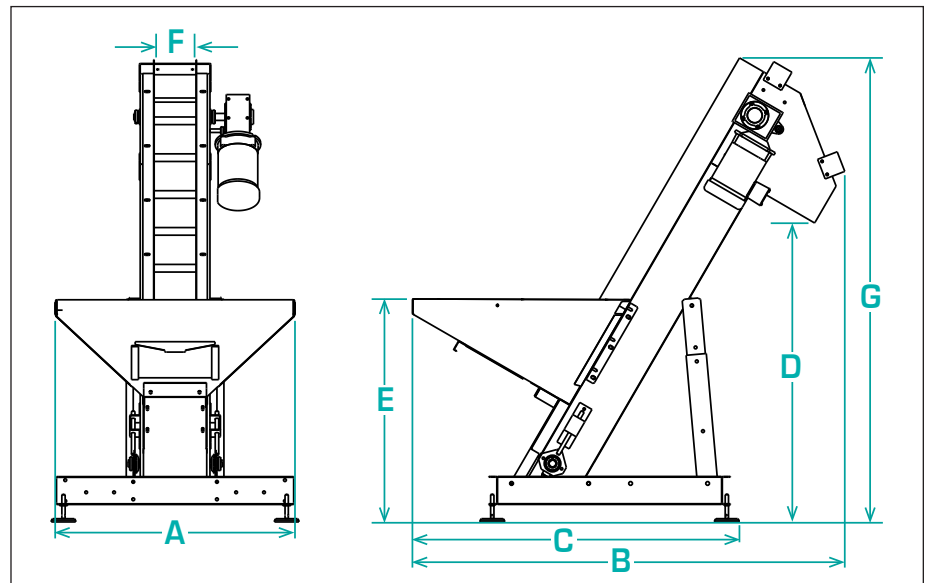

Product Specifications		ANSI	Metric
A	Overall Width	34.22"	869.2mm
B	Overall Length	61.75"	1568.5mm
C	Lower Chassis Footprint	46.66"	1185.2mm
D	Discharge Height (Adjustable)	42.69"	1084.3mm
E	Hopper Load Height (EP-04)	31.86"	809.2mm
E	Hopper Load Height (EP-06)	35.86"	910.8mm
F	Belt Width	6.00"	152mm
G	Overall Height	66.27"	1683.3mm

* It is strongly recommended that the frame of the prefeeder be reinforced and/or additionally supported for elevator extensions of 36" or greater.

EP-08/15/25 Elevating Prefeeder



Product Overview:

The EP-08/EP-15/EP-25 elevating prefeeder is designed to handle a variety of medium-sized, light weight parts. Its 8 ft³ capacity hopper delivers product at an average belt speed of 32'/minute. The cleated elevator belt has a nominal cleat height of 2.00" and a cleat pitch of 6.00" allowing for maximum product loading. A heavy duty variable speed motor helps to ensure proper product metering. Note: Controllers and mechanical level sensors are not supplied with this unit.

Part Number	EP0808XDSA	EP0808XASA
Motor Style	DC	AC
Motor Voltage	90V	230/460V
Horsepower	1/4hp	1/4 hp
Total Equipment Weight	720 lbs. / 327 kg	
Hopper Capacity (EP-08/EP-15/EP-25)	8 ft ³ – 15 ft ³ – 25 ft ³ / 227 – 425 – 708 liters	

Standard Features:

- Stainless steel construction
- Belting is FDA/USDA approved white 1-ply solid woven polyester fabric with 1/16" thick white PVC coating and PVC cleats
- Hopper cleanout door
- One piece formed hopper (8 ft³ capacity)

Available Options:

- Elevator extensions*
- Hopper extension for 15 and 25 ft³ capacity
- Continuous welded hopper seams (EP-15/25)
- Elevator/hopper covers
- Washdown motor
- NEMA 1 encased controller
- Pneumatic hopper agitator (#AGITATOREP08)
- Casters

* It is strongly recommended that the frame of the prefeeder be reinforced and/or additionally supported for elevator extensions of 54" or greater.

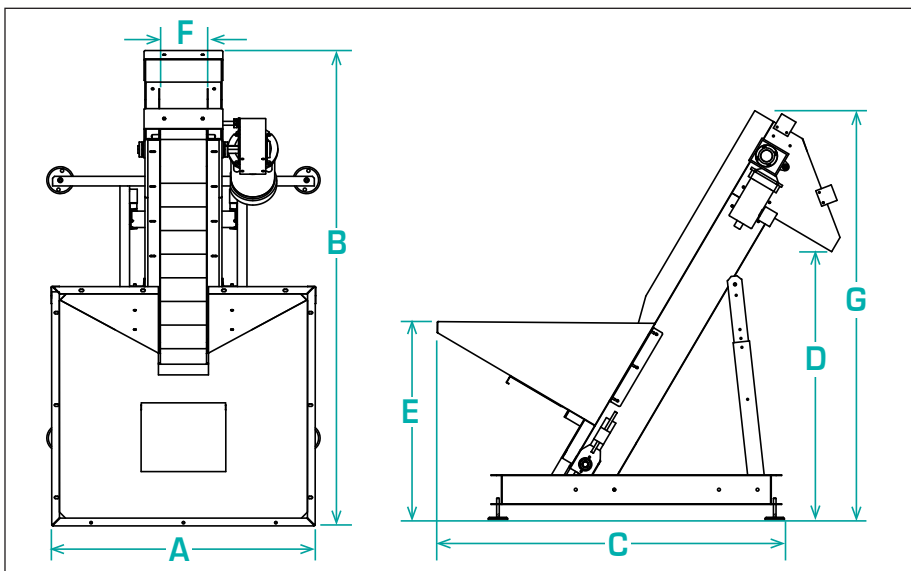

Product Specifications		ANSI	Metric
A	Overall Width	42.13"	1070.1mm
B	Overall Length	73.11"	1857.0mm
C	Lower Chassis Footprint	63.01"	1600.5mm
D	Discharge Height	48.70"	1237.0mm
E	Hopper Load Height (EP-08)	36.00"	914.4mm
E	Hopper Load Height (EP-15)	43.00"	1092.2mm
E	Hopper Load Height (EP-25)	52.00"	1320.8mm
F	Belt Width	8.00"	203.2mm
G	Overall Height	74.30"	650.2mm

Shibuya Hoppmann™

EP-10/20/30 Elevating Prefeeder



Product Overview:

The EP-10/20/30 elevating prefeeder is designed to handle a variety of medium-sized, mid-weight parts. Its 10 ft³ capacity hopper delivers product at an average belt speed of 32'/minute. The 12" wide cleated elevator belt has a nominal cleat height of 2.00" and a cleat pitch of 9.00" allowing for maximum product loading. A heavy duty variable speed motor helps to ensure proper product metering. Note: Controllers and mechanical level sensors are not supplied with this unit.

Part Number	EP1012XDSA	EP1012XASA
Motor Style	DC	AC
Motor Voltage	90V	230/460V
Horsepower	1/4hp	1/4hp
Total Equipment Weight	740 lbs. / 336 kg	
Hopper Capacity	10–20–30 ft ³ / 283–566–848 liters	

Standard Features:

- Stainless steel construction
- Belting is FDA/USDA approved white 1-ply solid woven polyester fabric with .156" thick white PVC coating and PVC cleats
- Hopper clean-out door
- One piece formed hopper (10 cubic foot capacity)

Available Options:

- Elevator extensions*
- Hopper extension for 20 and 30 ft³ capacity
- Continuous welded hopper seams
- Elevator/hopper covers
- Washdown motor
- NEMA 1 encased controller
- Pneumatic hopper agitator (#AGITATOREP08)
- Casters

* It is strongly recommended that the frame of the prefeeder be reinforced and/or additionally supported for elevator extensions of 54" or greater.

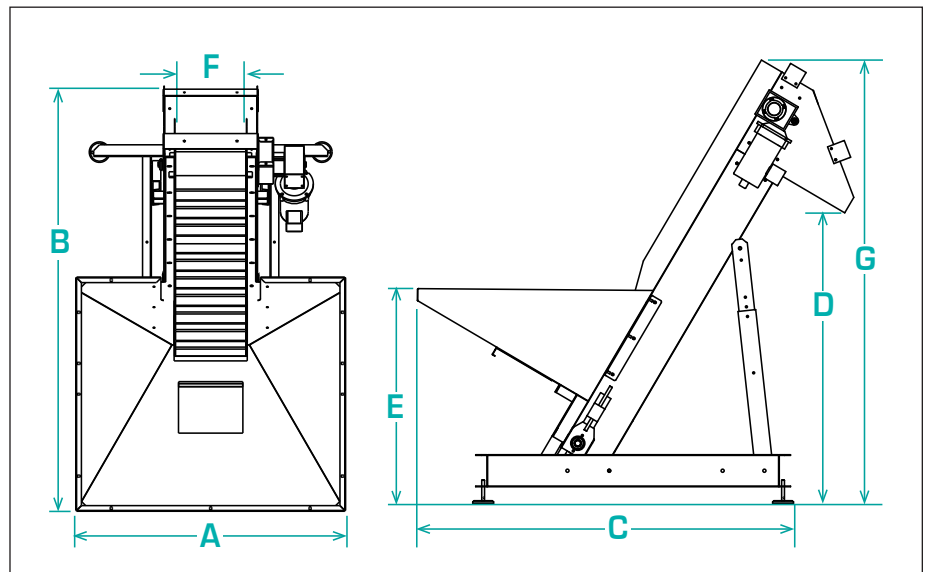

Product Specifications	ANSI	Metric
A Overall Width	46.15"	1172.2mm
B Overall Length	74.62"	1895.3mm
C Lower Chassis Footprint	61.86"	1571.2mm
D Discharge Height (Adjustable)	48.88"	1241.6mm
E Hopper Load Height (EP-10)	38.33"	973.6mm
E Hopper Load Height (EP-20)	47.33"	1202.2mm
E Hopper Load Height (EP-30)	56.33"	1430.8mm
F Belt Width	12.00"	304.8mm
G Overall Height	77.30"	1963.4mm



Product Overview:

The EP-35/EP-50 elevating prefeeder is designed to handle a variety of large, lightweight parts. Its 35 ft³ capacity hopper delivers product at an average belt speed of 23 feet per minute. The cleated elevator belt has a nominal cleat height of 3.00" and a cleat pitch of 12.00" allowing for maximum product loading. A heavy duty variable speed motor helps to ensure proper product metering. Note: Controllers and mechanical level sensors are not supplied with this unit.

Part Number	EP3518XDSA	EP3518XASA
Motor Style	DC	AC
Motor Voltage	90V	230/460V
Horsepower	1/2hp	1/2hp
Total Equipment Weight	1200 lbs. / 544 kg	544 kg
Hopper Capacity (EP-35/EP-50)	35 ft ³ – 50 ft ³ / 991 – 1416 liters	

Standard Features:

- Stainless steel construction
- Belting is FDA/USDA approved white 1-ply solid woven polyester fabric with .156" thick white PVC coating and PVC cleats
- Hopper cleanout door

Available Options:

- Elevator extensions*
- Hopper extension for 50 ft³ capacity
- Continuous welded hopper seams
- Elevator/hopper covers
- Washdown motor
- NEMA 1 encased controller
- Casters

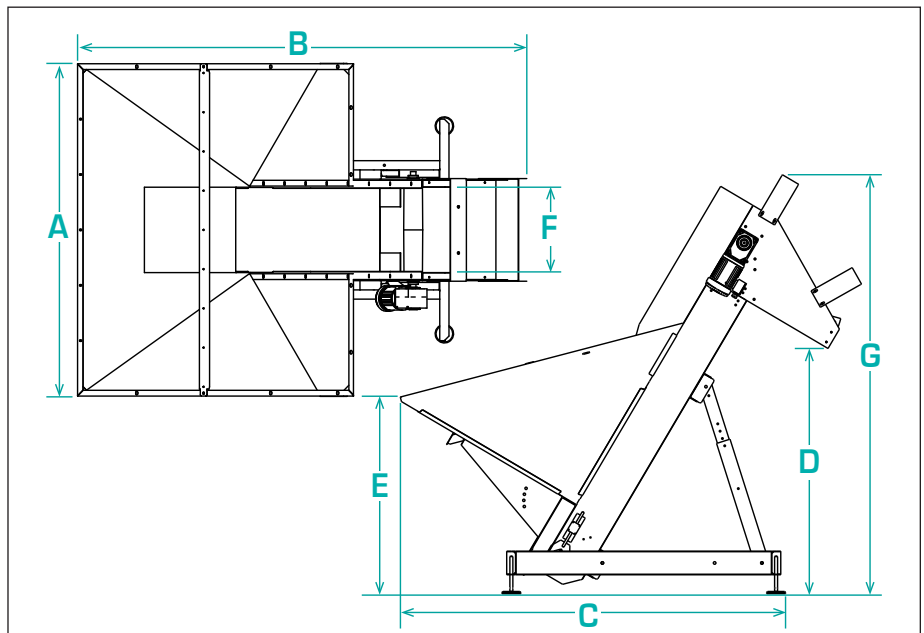

Product Specifications		ANSI	Metric
A	Overall Width	72.00"	1828.8mm
B	Overall Length	97.54"	2477.5mm
C	Lower Chassis Footprint	60.00"	1524.0mm
D	Discharge Height (Adjustable)	51.87"	1317.5mm
E	Hopper Load Height (EP-35)	41.64"	1057.7mm
E	Hopper Load Height (EP-50)	47.33"	1202.2mm
F	Belt Width	18.00"	457.2mm
G	Overall Height	88.53"	2248.7mm

* It is strongly recommended that the frame of the prefeeder be reinforced and/or additionally supported for elevator extensions of 54" or greater.

EH-08/15/25 Horizontal Discharge Elevating Prefeeder



Product Overview:

The EH-08/15/25 horizontal discharge, elevating prefeeder is designed to handle medium-sized parts. Using a modular, plastic, cleated chain to vertically and horizontally transport parts, this prefeeder allows the discharge to be closer to the bowl, eliminating potential scuffing or scraping of parts while being able to reach over existing equipment. A heavy duty variable speed motor helps to ensure proper product metering. Note: Controllers and mechanical level sensors are not supplied with this unit.

Part Number	EH0808XDSA	EH0808XASA
Motor Style	DC	AC
Motor Voltage	90V	230/460V
Horsepower	1/3hp	1/3hp
Total Equipment Weight	1000 lbs. / 454 kg	
Hopper Capacity (EH-08/EH-15/EH-25)	8 ft ³ – 15 ft ³ – 25 ft ³ / 227 – 425 – 708 liters	

Standard Features:

- Stainless steel construction
- Modular plastic chain
- Hopper cleanout door
- Elevator and hopper covers
- One piece formed hopper (8 ft³ capacity)

Available Options:

- Elevator extensions*
- Hopper extension for 15 and 25 ft³ capacity
- Continuous welded hopper seams (EH-15/25)
- Washdown motor
- NEMA 1 encased controller
- Pneumatic hopper agitator (#AGITATOREP08)
- Casters

* It is strongly recommended that the frame of the prefeeder be reinforced and/or additionally supported for elevator extensions of 36" or greater.

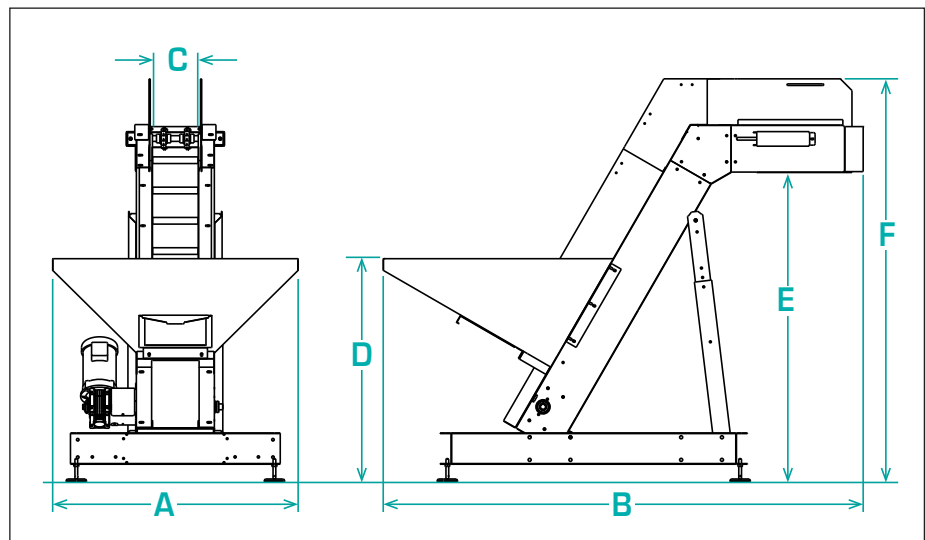

Product Specifications		ANSI	Metric
A	Overall Width	42.06"	1068.3mm
B	Overall Length	79.11"	2009.4mm
C	Modular Chain Width	8.00"	203.2mm
D	Hopper Load Height - EH-08	38.27"	972.1mm
D	Hopper Load Height - EH-15	45.27"	1149.9mm
D	Hopper Load Height - EH-25	54.27"	1378.5mm
E	Discharge Height	60.94"	1547.9mm
F	Overall Height	69.14"	1756.2mm

EH-35/50 Horizontal Discharge Elevating Prefeeder

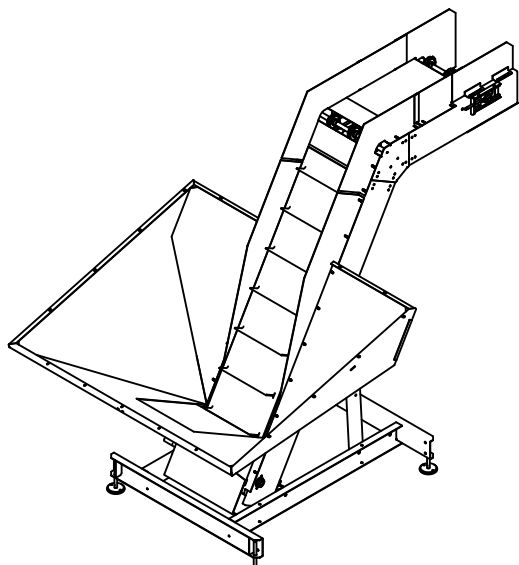

Product Overview:

The EH-35/50 horizontal discharge, elevating prefeeder is designed to handle medium-sized parts. Using a modular, plastic, cleated chain to vertically and horizontally transport parts, this prefeeder allows the discharge to be closer to the bowl, eliminating potential scuffing or scraping of parts while being able to reach over existing equipment. A heavy duty variable speed motor helps to ensure proper product metering. Note: Controllers and mechanical level sensors are not supplied with this unit.

Part Number	EH3518XDSA	EH3518XASA
Motor Style	DC	AC
Motor Voltage	90V	230/460V
Horsepower	1/3hp	1/3hp
Hopper Capacity (EH-35/EH-50)	35 ft ³ – 50 ft ³ / 991 – 1416 liters	

Standard Features:

- Stainless steel construction
- Modular plastic chain
- Hopper cleanout door

Available Options:

- Elevator extensions*
- Hopper extension for 50 ft³ capacity
- Continuous welded hopper seams (EH-35/50)
- Washdown motor
- Elevator and hopper covers
- Casters

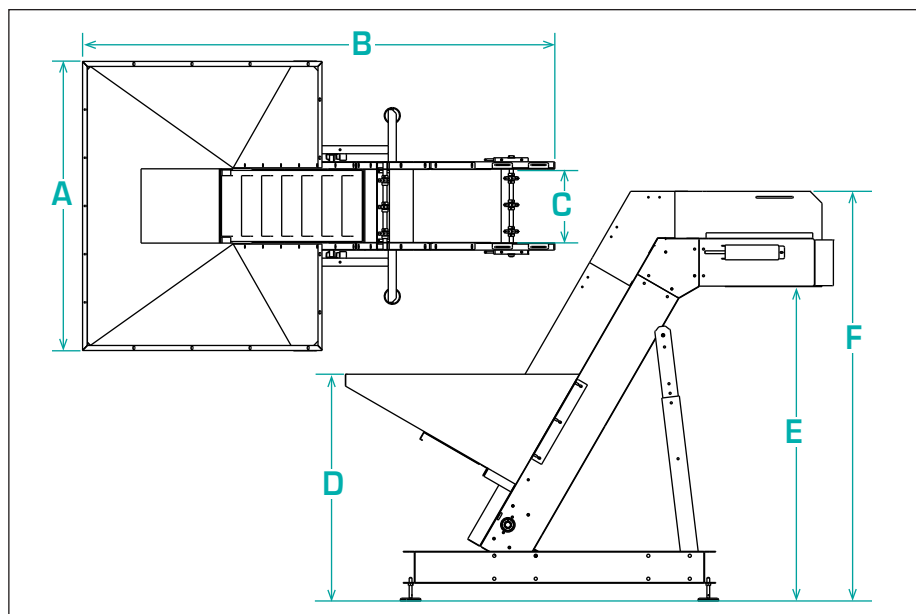

Product Specifications		ANSI	Metric
A	Overall Width	72.00"	1828.8mm
B	Overall Length	117.62"	2987.5mm
C	Modular Chain Width	17.72"	450.1mm
D	Hopper Load Height - EH-35	44.37"	1127.0mm
D	Hopper Load Height - EH-50	50.07"	1271.8mm
E	Discharge Height	76.46"	1942.1mm
F	Overall Height	93.64"	2378.5mm

* It is strongly recommended that the frame of the prefeeder be reinforced and/or additionally supported for elevator extensions of 36" or greater.

Shibuya Hoppmann™

TP-30 Trough Prefeeder

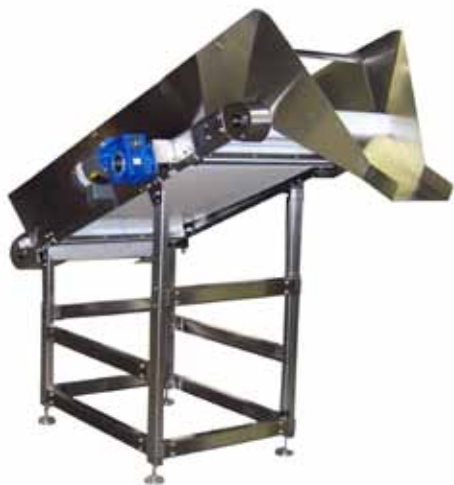

Product Overview:

Shibuya Hoppmann's standard TP-30 trough prefeeder is specially designed for handling a variety of food products or fragile parts. The prefeeder features protective sides, a food grade belt and variable speed control. Typical applications include those in which the parts may have a tendency to nest or tangle with each other, or may become damaged by a cleated belt style prefeeder. Note: Controllers and mechanical level sensors are not supplied with this unit.

Part Number	TPXX30XDSA	TPXX30XASA
Motor Style	DC	AC
Motor Voltage	90V	230/460V
Horsepower	1/2hp	1/2 hp
Total Equipment Weight	450 lbs. / 204 kg	204 kg
Hopper Capacity	30 ft ³ / 850 liters	

Standard Features:

- Stainless steel construction
- DC variable speed motor
- Belting is FDA/USDA approved white 1-ply solid woven polyester fabric with .156" thick white PVC coating and PVC cleats

Available Options:

- Washdown motor
- NEMA 1 encased controller
- Hopper covers
- Casters

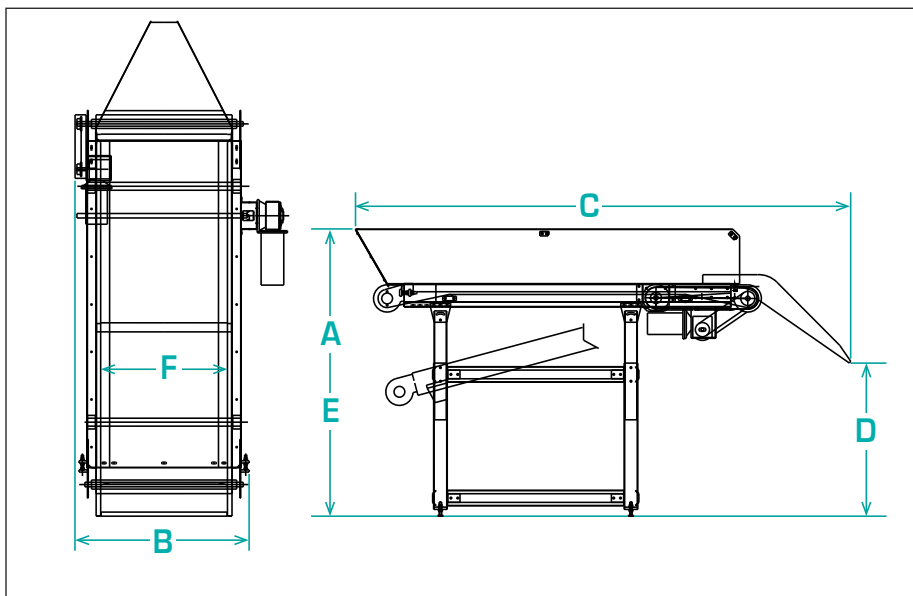

Product Specifications		ANSI	Metric
A	Overall Height	63.50" ± 7.5"	1575 ± 190mm
B	Overall Width	47.00"	940mm
C	Overall Length	109.00"	2667mm
D	Discharge Height (Adjustable)	33.50" ± 7.5"	851 ± 190mm
E	Hopper Load Height (Adjustable)	63.50" ± 7.5"	1613 ± 190mm
F	Belt Width	30.00"	762mm

Shibuya Hoppmann™

WB-6 Wide Belt Prefeeder

Product Overview:

Shibuya Hoppmann's WB-6 prefeeder is specially designed to handle fragile parts. Two independent variable speed drives and a standard level sensor ensures gentle product metering. Product drops from the upper belt to the lower belt where it is pulled away at a faster rate to assist in part separation and de-tangling. Note: Controllers and mechanical level sensors are not supplied with this unit.



Part Number	WB06XXXDSA	WB06XXXASA
Motor Style	DC	AC
Motor Voltage	90V	220/380V
Upper Belt Horsepower	1/2hp	1/2hp
Lower Belt Horsepower	1/30hp	1/4hp
Total Equipment Weight	650 lbs. / 295 kg	
Supply Hopper Capacity	6 ft ³ / 170 liters	

Standard Features:

- Stainless steel construction
- Adjustable feed angle
- Sensor controlled dual belt metering system
- FDA/USDA approved white buna-n/ polyester polyflake endless belting (upper belt)
- Durable reinforced black neoprene belt with fiberglass cord (lower belt)

Available Options:

- Continuous welded hopper seams
- Washdown motor
- NEMA 1 encased controller
- Hopper covers
- Casters

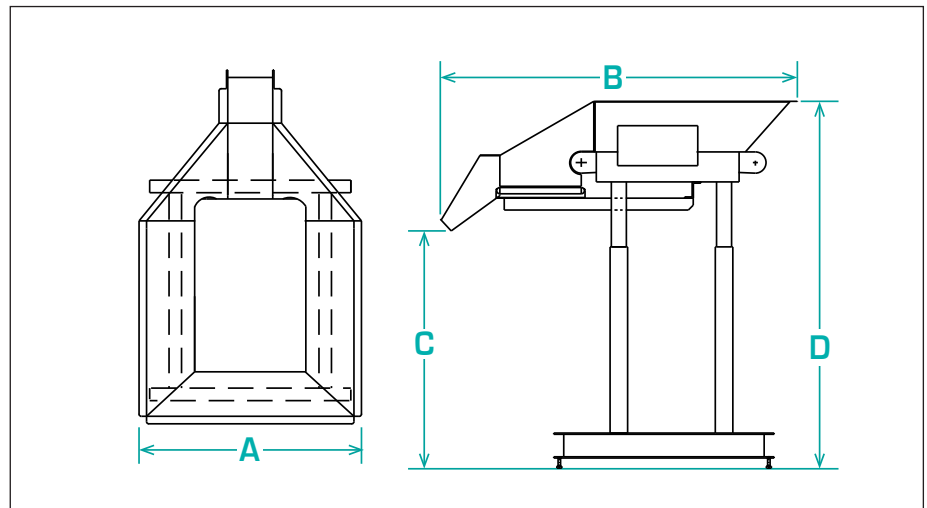

Product Specifications		ANSI	Metric
A	Overall Width	51.00"	1295mm
B	Overall Length	72.00"	1829mm
C	Discharge Height (Adjustable)	48.00" ± 10.0"	1219 ± 254mm
D	Load Height (Adjustable)	74.00" ± 10.0"	1880 ± 254mm
E	Angle of Feed	0° - 11°	0° - 11°

Shibuya Hoppmann™

WEP-40 Wide Belt Elevating Prefeeder



Product Overview:

The WEP-40 wide belt elevating prefeeder is specially designed to handle large parts. Two independently controlled variable speed drives ensure gentle product metering. Designed for floor level parts loading, the 40 ft³ capacity hopper delivers product at an average belt speed of 23 feet per minute. The cleated elevator belt has a nominal cleat height of 4" and a cleat pitch of 12", allowing for maximum product loading. Note: Controllers and mechanical level sensors are not supplied with this unit.

Part Number	WE4022XDSA	WE4022XASA
Motor Style	DC	AC
Motor Voltage	90V	230/460V
Horsepower (Horizontal)	1/2hp	1/2hp
Horsepower (Elevator)	1/2hp	1/2hp
Total Equipment Weight	2440 lbs. / 1107 kg	
Hopper Capacity	40 ft ³ / 1133 liters	

Standard Features:

- Stainless steel construction
- Sensor controlled dual belt metering system
- Horizontal belt is FDA/USDA approved white buna-n/polyester polyflake endless belting
- Elevator belt is FDA/USDA approved white 1-ply solid woven polyester fabric with .156" thick white PVC coating and PVC cleats

Available Options:

- Elevator extensions*
- Continuous welded hopper seams
- Elevator/Hopper covers
- Washdown motor
- NEMA 1 encased controller
- Clean out doors
- Casters

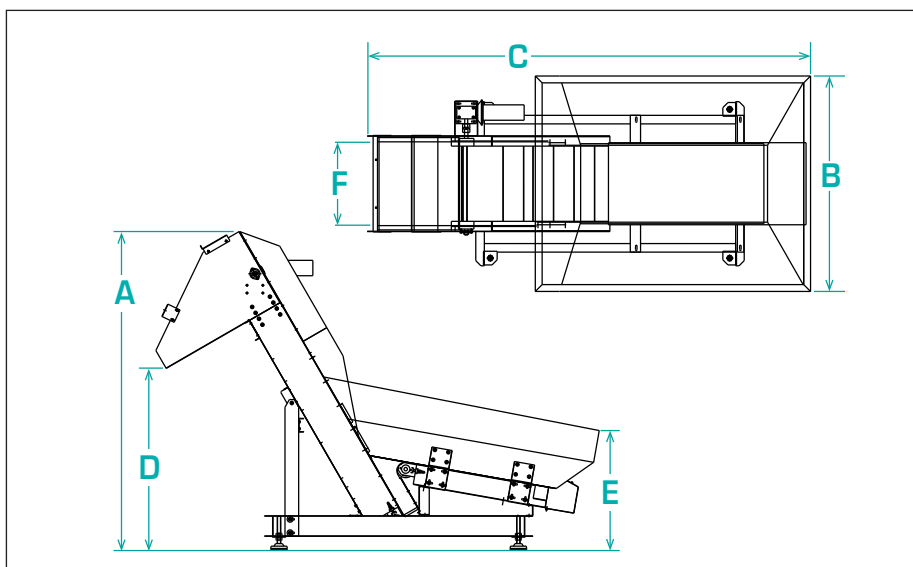

Product Specifications		ANSI	Metric
A	Overall Height	100.00"	2540mm
B	Overall Width	63.00"	1600mm
C	Overall Length	133.00"	3378mm
D	Discharge Height	60.00"	1524mm
E	Hopper Load Height	36.00"	914mm
F	Belt Width (Elevator)	22.00"	559mm

* It is strongly recommended that the frame of the prefeeder be reinforced and/or additionally supported for elevator extensions of 72" or greater.

Shibuya Hoppmann™

WEP-80 Wide Belt Elevating Prefeeder

Product Overview:

The WEP-80 wide belt elevating prefeeder is specially designed to handle large parts. Two independently controlled variable speed drives ensure gentle product metering. Designed for floor level parts loading, the 80 ft³ capacity hopper delivers product at an average belt speed of 23 feet per minute. The cleated elevator belt has a nominal cleat height of 4" and a cleat pitch of 12", allowing for maximum product loading. Note: Controllers and mechanical level sensors are not supplied with this unit.



Part Number	WE8022XDSA	WE8022XASA
Motor Style	DC	AC
Motor Voltage	90V	230/460V
Horsepower (Horizontal)	1/2hp	1/2hp
Horsepower (Elevator)	1/2hp	1/2hp
Total Equipment Weight	2462 lbs. / 1117 kg	
Hopper Capacity	80 ft ³ / 2266 liters	

Standard Features:

- Stainless steel construction
- Sensor controlled dual belt metering system
- Horizontal belt is FDA/USDA approved white buna-n/polyester polyflake endless belting
- Elevator belt is FDA/USDA approved white 1-ply solid woven polyester fabric with .156" thick white PVC coating and PVC cleats

Available Options:

- Elevator extensions*
- Continuous welded hopper seams
- Elevator/Hopper covers
- Washdown motor
- NEMA 1 encased controller
- Clean out doors
- Casters

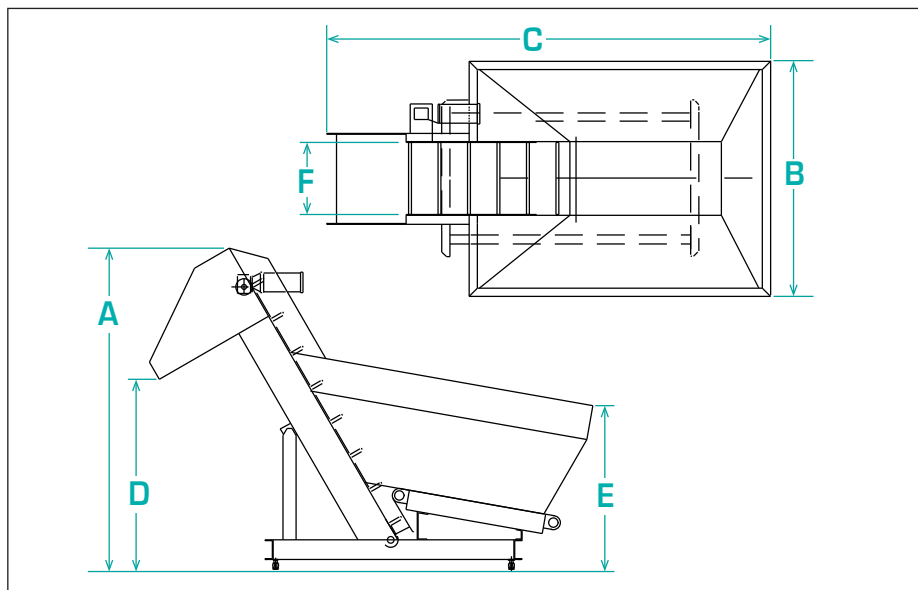

Product Specifications	ANSI	Metric
A Overall Height	100.00"	2540mm
B Overall Width	72.00"	1829mm
C Overall Length	136.00"	3454mm
D Discharge Height	60.00"	1524mm
E Hopper Load Height	50.00"	1270mm
F Belt Width (Elevator)	22.00"	559mm

* It is strongly recommended that the frame of the prefeeder be reinforced and/or additionally supported for elevator extensions of 72" or greater.

Shibuya Hoppmann™

WEP-120 Wide Belt Elevating Prefeeder



Product Overview:

The WEP-120 wide belt elevating prefeeder is specially designed to handle large parts. Two independently controlled variable speed drives ensure gentle product metering. Designed for floor level parts loading, the 120 ft³ capacity hopper delivers product at an average belt speed of 23 feet per minute. The cleated elevator belt has a nominal cleat height of 4" and a cleat pitch of 12", allowing for maximum product loading. Note: Controllers and mechanical level sensors are not supplied with this unit.

Part Number	WE12022DSA	WE12022ASA
Motor Style	DC	AC
Motor Voltage	90V	230/460V
Horsepower (Horizontal)	1/2hp	1/2hp
Horsepower (Elevator)	1/2hp	1/2hp
Total Equipment Weight	2500 lbs. / 1134 kg	
Hopper Capacity	120 ft ³ / 3400 liters	

Standard Features:

- Stainless steel construction
- Sensor controlled dual belt metering system
- Horizontal belt is FDA/USDA approved white buna-n/polyester polyflake endless belting
- Elevator belt is FDA/USDA approved white 1-ply solid woven polyester fabric with .156" thick white PVC coating and PVC cleats

Available Options:

- Elevator extensions*
- Continuous welded hopper seams
- Elevator/Hopper covers
- Washdown motor
- NEMA 1 encased controller
- Clean out doors
- Casters

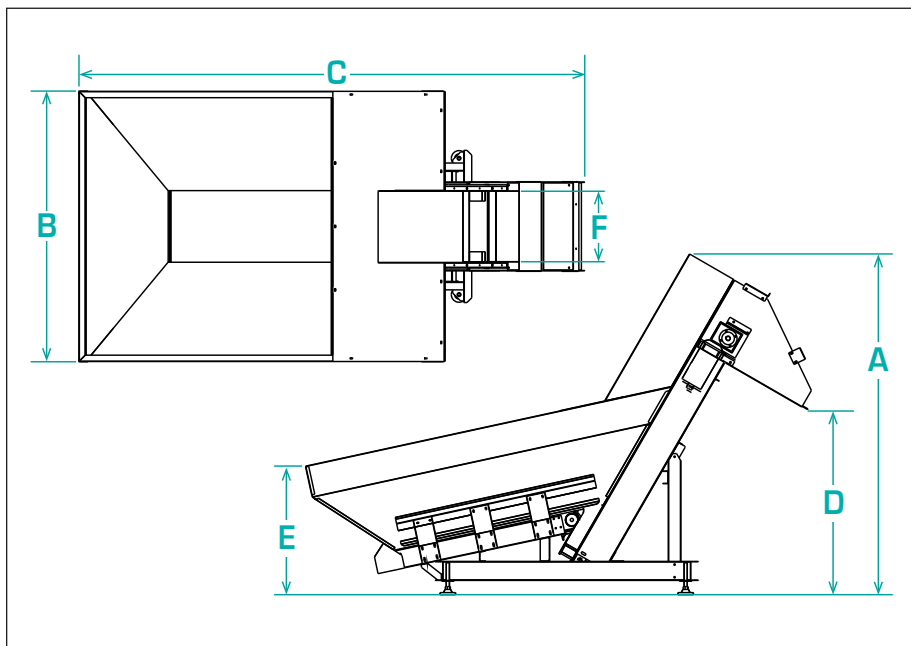

Product Specifications	ANSI	Metric
A Overall Height	100.00"	2540mm
B Overall Width	85.00"	2159mm
C Overall Length	160.00"	4064mm
D Discharge Height	60.00"	1524mm
E Hopper Load Height	40.00"	1016mm
F Belt Width (Elevator)	22.00"	559mm

* It is strongly recommended that the frame of the prefeeder be reinforced and/or additionally supported for elevator extensions of 72" or greater.



*Shown with optional stand, motor and custom chute.

Product Overview:

The Shibuya Hoppmann EC-Series Bulk Product Conveyor can be used as a bulk conveying system or can be modified to accommodate a bulk hopper for any prefeeding need. This low cost conveyor uses formed edge product rails which are slotted to adjust the amount of clearance between the belt cleats and the side walls, rugged 3/8" thick belt cleats for heavy duty applications, and a product well at the base to prevent parts from falling. Conveyor speeds of over 60 feet per minute can be achieved, allowing for the movement of large quantities of parts.

Part Number	EC0812MDSA	EC0812MASA
Motor Style	DC	AC
Motor Voltage ¹	90V	230/460V
Horsepower	1/2hp	1/2hp
Total Equipment Weight ²	500 lbs. / 227 kg	

¹ Motor is optional.

² Dependent upon length.

Standard Features:

- 304 stainless steel construction
- Four (4'0) foot through twelve (12') foot lengths available in 1 foot increments
- 4.00" diameter pulleys
- FDA/USDA white PVC belt with heavy duty 2" tall cleats
- Adjustable formed edge product rails
- Direct drive, side mount reducer (can be mounted on either side)

Available Options:

- DC/AC motors available in 90VDC, 115VAC, 230VAC and 460VAC
- Stainless steel support stand
- Washdown bearings
- Longer conveyor lengths
- Other cleat pitches available
- Custom chutes available

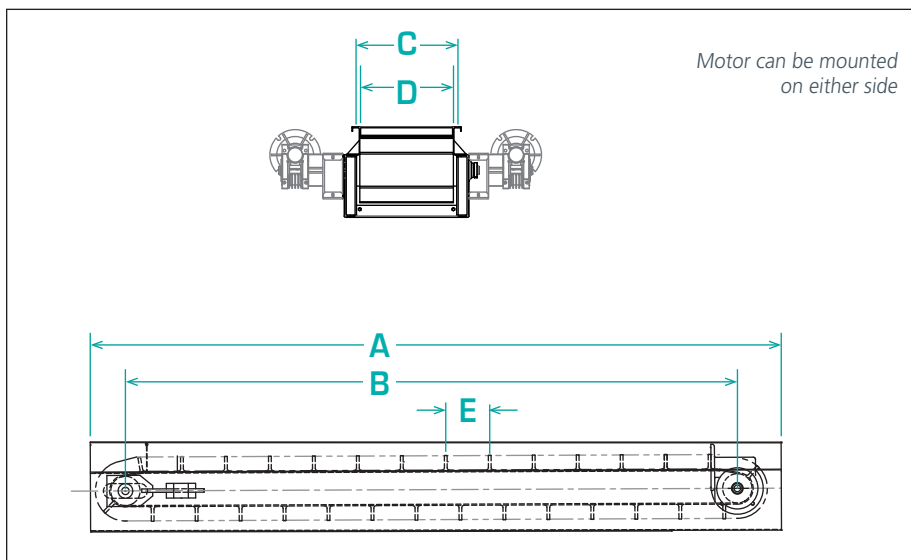

Product Specifications		ANSI	Metric
A	Overall Length of Channel	5' (60") - 13' (156")	1524mm - 3963mm
B	Pulley Center Distance	4' (48") - 12' (144")	1219mm - 3658mm
C	Channel (Bed) Width	16.00"	406mm
D	Belt Width	12.00"	305mm
E	Cleat Pitch (Standard)	12.00"	305mm

Prefeeder Options and Accessories

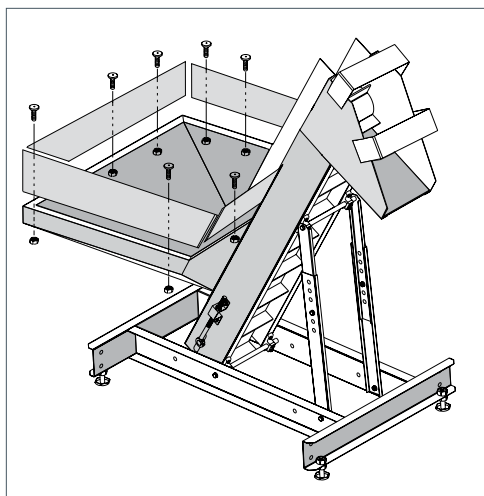

Hopper Extensions

All prefederers and prefederer options/accessories are shipped un-assembled. If assembly of the prefederer is required or desired the price PER option is \$150.00.

Hopper Extensions are available as follows:

LB-03 (6) ft ³ Hopper Extension	HX03LB03SU
EP-04 (6) ft ³ Hopper Extension	HX06EP04SU
EP-08 (15) ft ³ Hopper Extension	HX15EP08SU
EP-08 (25) ft ³ Hopper Extension	HX25EP08SU
EP-35 (50) ft ³ Hopper Extension	HX50EP35SU
EH-08 (15) ft ³ Hopper Extension	HX15EP08SU
EH-08 (25) ft ³ Hopper Extension	HX25EP08SU

Elevator Extension kits are available as follows:

EP-04 18" Elevator Extension*	EX18EP04SU
EP-04 24" Elevator Extension*	EX24EP04SU
EP-04 36" Elevator Extension*	EX36EP04SU
EP-04 54" Elevator Extension*	EX54EP04SU
EP-08 18" Elevator Extension**	EX18EP08SU
EP-08 36" Elevator Extension**	EX36EP08SU
EP-08 54" Elevator Extension**	EX54EP08SU
EH-08 12" Elevator Extension*	EX12EH08SU
EH-08 18" Elevator Extension*	EX18EH08SU
EH-08 24" Elevator Extension*	EX24EH08SU
EH-08 36" Elevator Extension*	EX36EH08SU
EP-35 18" Elevator Extension**	EX18EP35SU
EP-35 36" Elevator Extension**	EX36EP35SU
EP-35 54" Elevator Extension**	EX54EP35SU
WEP-40/80/120 24" Elevator Extension***	EX24WE80SU

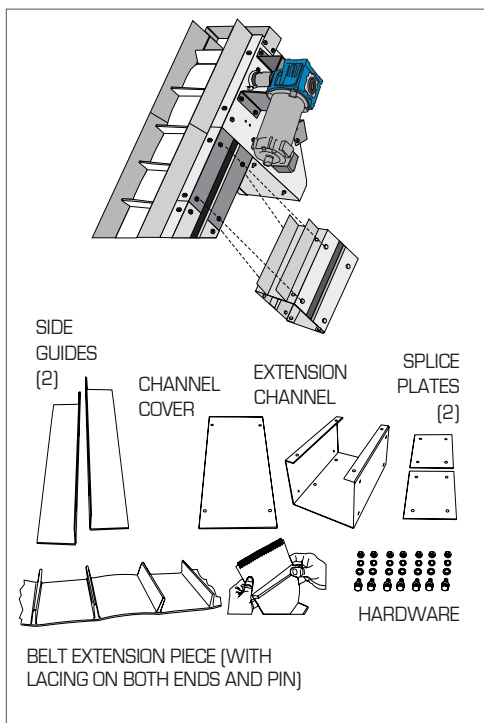

Elevator Extension Kits

EP-04 Dump Height Reference:

No Extension = 42"
 18" Extension = 58"
 24" Extension = 64"
 36" Extension = 74"
 54" Extension = 87"

EH-08 Dump Height Reference:

No Extension = 48"
 12" Extension = 58"
 18" Extension = 64"
 24" Extension = 69"
 36" Extension = 79"

EP-08/35 Dump Height Reference:

No Extension = 48"
 18" Extension = 64"
 36" Extension = 79"
 54" Extension = 95"

WEP Dump Height Reference:

No Extension = 58"
 24" Extension = 78"

*It is strongly recommended that the frame of the prefederer be reinforced and/or additionally supported for elevator extensions of 36" or greater.

**It is strongly recommended that the frame of the prefederer be reinforced and/or additionally supported for elevator extensions of 54" or greater.

***It is strongly recommended that the frame of the prefederer be reinforced and/or additionally supported for elevator extensions of 72" or greater.

Prefeeder Options and Accessories

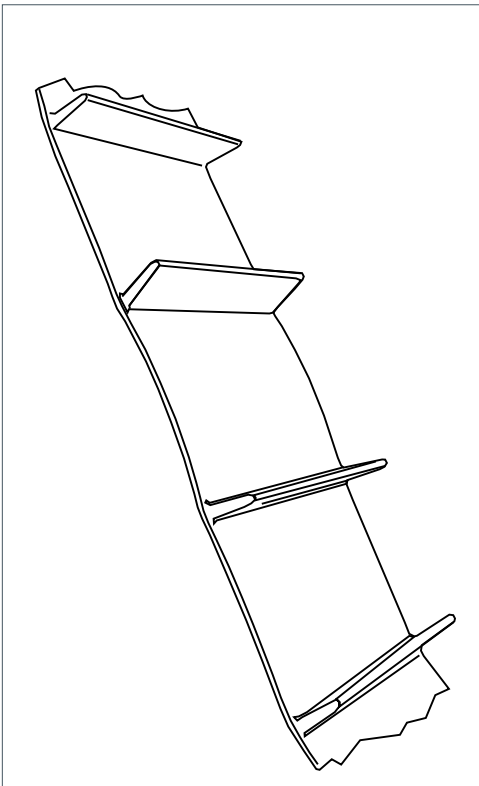

Belting (EP-Style)

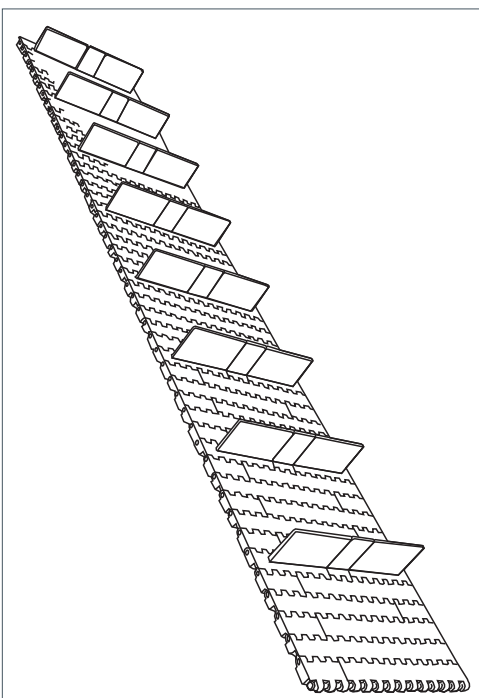

Belting (EH-Chain)

Replacement Prefeeder Belts*:

Description	Belt Length	Part Number
Standard EP-04/06 Belt	126"	BELTEP4126
Standard + 18" Extension	162"	BELTEP4162
Standard + 24" Extension	174"	BELTEP4174
Standard + 36" Extension	198"	BELTEP4198
Standard + 54" Extension	234"	BELTEP4234
Standard EP-08/15/25 Belt	144"	BELTEP8144
Standard + 18" Extension	180"	BELTEP8180
Standard + 24" Extension	216"	BELTEP8216
Standard + 36" Extension	252"	BELTEP8252
Standard EP-10/20/30 Belt	144"	BELTEP10144
Standard + 18" Extension	180"	BELTEP10180
Standard + 36" Extension	216"	BELTEP10216
Standard + 54" Extension	252"	BELTEP10252
Standard EP-35/50 Belt	168"	BELTEP35168
Standard + 18" Extension	204"	BELTEP35204
Standard + 36" Extension	240"	BELTEP35240
Standard + 54" Extension	276"	BELTEP35276
Standard EH-08/15/25 Modular Chain	180"	CHEH08A180
Standard + 18" Extension	216"	CHEH08A216
Standard + 36" Extension	252"	CHEH08A252
Standard + 54" Extension	288"	CHEH08A288
Standard EH-35/50 Modular Chain	240"	CHEH35A240
Standard + 18" Extension	276"	CHEH35A276
Standard + 36" Extension	312"	CHEH35A312
Standard + 54" Extension	348"	CHEH35A348
Standard WEP-40 Belt	180"	BELTLACE38
Standard + 24" Extension	48"	BELTLACE05
Standard WEP-80 Belt	191"	BELTLACE03
Standard + 24" Extension	48"	BELTLACE05
Standard WEP-120 Belt	191"	BELTLACE03
Standard + 24" Extension	48"	BELTLACE05

*To replace your specific belt - either know the length of your prefeeder's existing belt, or have your serial number handy.

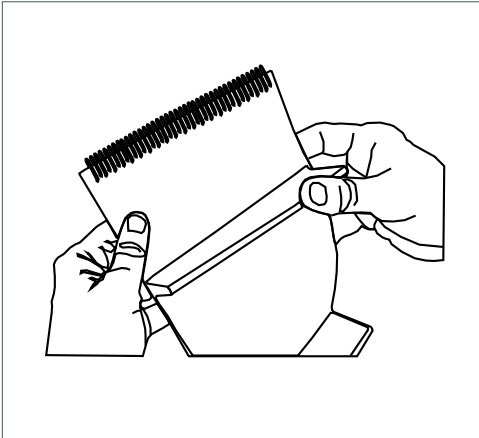

Belt Pieces/Lacing

Replacement Prefeeder Belts*:

Description	Belt Length	Part Number
EP-04/06 18" Extension Belt	36"	BELTEP4036
EP-04/06 24" Extension Belt	48"	BELTEP4048
EP-04/06 36" Extension Belt	72"	BELTEP4072
EP-04/06 54" Extension Belt	108"	BELTEP4108
EP-08/15/25 18" Extension Belt	36"	BELTEP8036
EP-08/15/25 36" Extension Belt	72"	BELTEP8072
EP-08/15/25 54" Extension Belt	108"	BELTEP8108
EP-10/20/30 9" Extension Belt	18"	BELTEP10018
EP-10/20/30 18" Extension Belt	36"	BELTEP10036
EP-10/20/30 36" Extension Belt	72"	BELTEP10072
EP-10/20/30 54" Extension Belt	108"	BELTEP10108
EP-35/50 18" Extension	36"	BELTEP35036
EP-35/50 36" Extension	72"	BELTEP35072
EP-35/50 54" Extension	108"	BELTEP35108
EH-08/15/25 18" Extension	36"	CHEH08A036
EH-08/15/25 36" Extension	72"	CHEH08A072
EH-08/15/25 54" Extension	108"	CHEH08A108
EH-35/50 18" Extension	36"	CHEH35A036
EH-35/50 36" Extension	72"	CHEH35A072
EH-35/50 54" Extension	108"	CHEH35A108
Standard WEP-40 Belt	180"	BELTLACE38
Standard + 24" Extension	48"	BELTLACE05
Standard WEP-80 Belt	191"	BELTLACE03
Standard + 24" Extension	48"	BELTLACE05
Standard WEP-120 Belt	191"	BELTLACE03
Standard + 24" Extension	48"	BELTLACE05

Prefeeder Options and Accessories

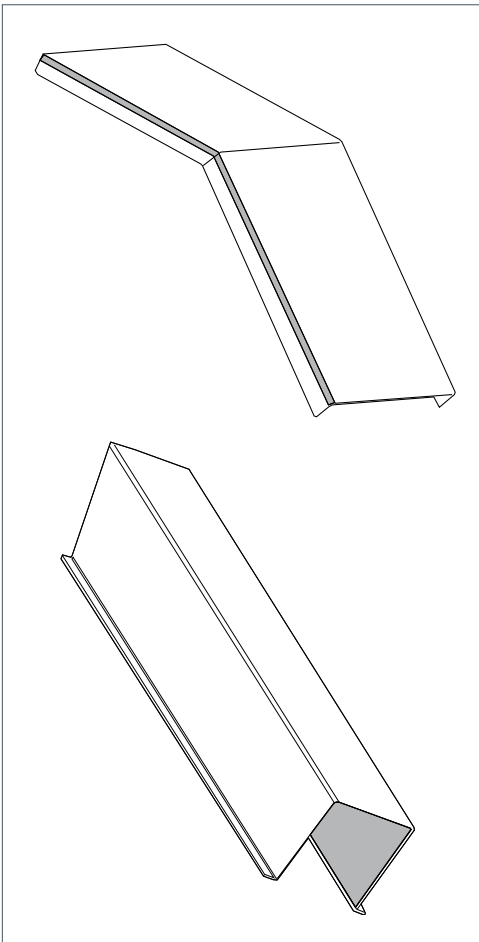

Lexan Covers

Lexan Elevator Covers are available for the following prefeeders:

EP Series prefeeder and WEP Series prefeeder

EP-04 Elevator Cover Kit	CVELEP04LU
EP-04 with 18" Extension Cover Kit	CVELEP0418
EP-04 with 24" Extension Cover Kit	CVELEP0424
EP-04 with 36" Extension Cover Kit	CVELEP0436
EP-04 with 54" Extension Cover Kit	CVELEP0454
EP-06 Elevator Cover Kit	CVELEP06LU
EP-06 with 18" Extension Cover Kit	CVELEP0618
EP-06 with 24" Extension Cover Kit	CVELEP0624
EP-06 with 36" Extension Cover Kit	CVELEP0636
EP-06 with 54" Extension Cover Kit	CVELEP0654
EP-08 Elevator Cover Kit	CVELEP08LU
EP-08 with 18" Extension Cover Kit	CVELEP0818
EP-08 with 36" Extension Cover Kit	CVELEP0836
EP-08 with 54" Extension Cover Kit	CVELEP0854
EP-15 Elevator Cover Kit	CVELEP15LU
EP-15 with 18" Extension Cover Kit	CVELEP1518
EP-15 with 36" Extension Cover Kit	CVELEP1536
EP-15 with 54" Extension Cover Kit	CVELEP1554
EP-25 Elevator Cover Kit	CVELEP25LU
EP-25 with 18" Extension Cover Kit	CVELEP2518
EP-25 with 36" Extension Cover Kit	CVELEP2536
EP-25 with 54" Extension Cover Kit	CVELEP2554
EP-35 Elevator Cover Kit	CVELEP35LU
EP-35 with 18" Extension Cover Kit	CVELEP3518
EP-35 with 36" Extension Cover Kit	CVELEP3536
EP-35 with 54" Extension Cover Kit	CVELEP3554
EP-50 Elevator Cover Kit	CVELEP50LU
EP-50 with 18" Extension Cover Kit	CVELEP5018
EP-50 with 36" Extension Cover Kit	CVELEP5036
EP-50 with 54" Extension Cover Kit	CVELEP5054
WEP-40 Elevator Cover Kit	CVELWE40LU
WEP-40 with 24" Extension Cover Kit	CVELWE4024
WEP-80 Elevator Cover Kit	CVELWE80LU
WEP-80 with 24" Extension Cover Kit	CVELWE8024
WEP-120 Elevator Cover Kit	CVELWE12LU

Prefeeder Options and Accessories

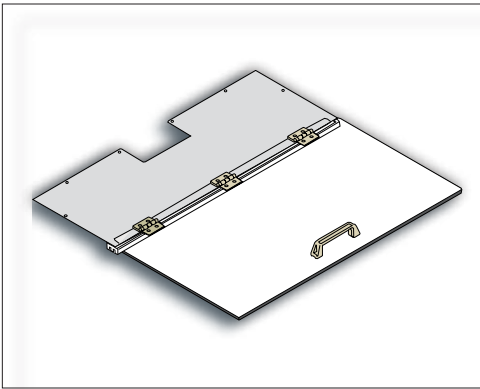

Lexan Hopper Covers

Lexan Hopper Covers are available for the following prefeeders:
EP Series, WEP Series

EP-04/06 Lexan Hopper Cover Kit	CVHPEP04LU
EP-08 Lexan Hopper Cover Kit	CVHPEP08LU
EP-15 Lexan Hopper Cover Kit	CVHPEP15LU
EP-25 Lexan Hopper Cover Kit	CVHPEP25LU
EP-35 Lexan Hopper Cover Kit	CVHPEP35LU
EP-50 Lexan Hopper Cover Kit	CVHPEP50LU
WEP-40 Lexan Hopper Cover Kit	CVHPWE40LU
WEP-80 Lexan Hopper Cover Kit	CVHPWE80LU

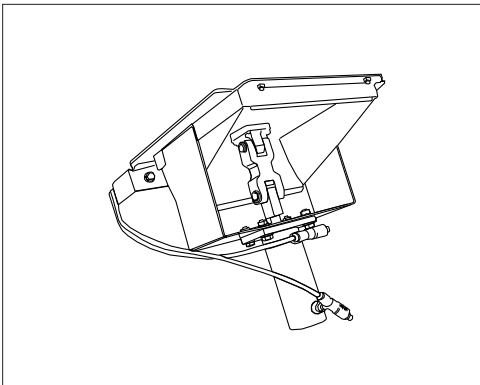

Hopper Agitator

Hopper Agitators are available for the following prefeeders:
EP-08, EP-15, EP-25, EH-08, EH-15 and EH-25

EP-08/15/25 Hopper Agitator	AGITATOREP08
EP-35/50 Hopper Agitator	AGITATOREP35
EH-08/15/25 Hopper Agitator	AGITATOREP08

Belt/Chain Upgrade Food Grade Belting for Overhead Prefeeder

Tan Neoprene USDA/FDA Dry Contact Food Belt with Fiberglass Cord for the LB-01 and LB-03/06 Live Bottom Prefeeder:

LB-01 Belt Upgrade	BELT200F50
LB-03/06 Belt Upgrade	BELT352F99



Casters

Casters

Stainless Steel Casters are available for the following prefeeders:
EP-08/15/25, EP-35/50, EH-08/15/25, WEP-40/80/120

All Prefeeder	CASTERKIT02
---------------	-------------

Control Packages

Several different control packages are available for the different prefeeders.

NEMA 1 Encased Controller (DC control package with time delay and mechanical style limit switch and paddle arm)	CU120000LS
NEMA 1 Encased Controller (DC control package with time delay and non-contact photo-electric limit switch)	CU12000000

Model No.	SHC Motor Part No.	Max. RPM @ Output Shaft	Min. RPM @ Output Shaft	Gear Ratio XX:1	Pulley Dia.	Belt Speed Max. fpm	Belt Speed Min. fpm	Cleat Height/Centers	Belt Length
LB-01 (DC)	MOTR013021	21.00	5.25	161	1.2"	6.1	1.5	N/A	20.00"
LB-01 (AC)	MOTRAC12HP	21.00	5.25	161	1.2"	6.1	1.5	N/A	20.00"
LB-03 (DC)	MOTR013021	21.00	5.15	161	1.2"	6.1	1.5	N/A	35.20"
LB-03 (AC)	MOTRAC12HP	21.00	5.15	161	1.2"	6.1	1.5	N/A	35.20"
ET-02 (DC)	MOTRP.20HP	Information Coming Soon!						1.5"/6.0"	72.00"
ET-02 (AC)	MOTRMAC.25	Information Coming Soon!						1.5"/6.0"	72.00"
EP-04 (DC)	MOTRP.25HP	43.75	10.94	40	4"	45.8	11.4	1.5"/6.0"	126.00"
EP-04 (AC)	MOTRAC0025-M	43.13	6.47	40	4"	45.1	6.8	1.5"/6.0"	126.00"
EP-08 (DC)	MOTRP.25HP	43.75	6.56	40	4"	30.5	7.6	2.0"/6.0"	144.00"
EP-08 (AC)	MOTRAC0025-M	43.13	7.29	40	4"	45.1	6.9	2.0"/6.0"	144.00"
EP-10 (DC)	MOTRP.25HP	43.75	6.56	40	4"	30.5	7.6	2.0"/9.0"	144.00"
EP-10 (AC)	MOTRAC0025-M	43.13	7.29	40	4"	45.1	6.9	2.0"/9.0"	144.00"
EP-35 (DC)	MOTRPM0102	29.17	7.29	60	4"	30.5	7.6	3.0"/12.0"	168.00"
EP-35 (AC)	MOTRAC0050-M	28.75	4.31	60	4"	30.1	4.5	3.0"/12.0"	168.00"
EH-08 (DC)	MOTRP.33HP	35.00	8.75	50	6.1"	55.9	14.0	2.0"/6.0"	180.00"
EH-08 (AC)	MOTRAC0033	34.50	5.18	50	6.1"	55.1	8.3	2.0"/6.0"	180.00"
EH-35 (DC)	MOTRP.33HP	35.00	8.75	50	6.1"	55.9	14.0	3.0"/10.0"	240.00"
EH-35 (AC)	MOTRAC0033	34.50	5.18	50	6.1"	55.1	8.3	3.0"/10.0"	240.00"
WB-06 (DC) Wide Belt	MOTRPM0102	4.83	1.46	300	4"	6.1	1.5	n/a	82.00"
WB-06 (DC) Narrow	MOTR013021	21.00	5.25	161	4"	22.0	5.5	n/a	35.20"

Model No.	SHC Motor Part No.	Max. RPM @ Output Shaft	Min. RPM @ Output Shaft	Gear Ratio XX:1	Pulley Dia.	Belt Speed Max. fpm	Belt Speed Min. fpm	Cleat Height/Centers	Belt Length
WB-06 (AC) Wide Belt	MOTRAC0050	17.50	5.25	100	4"	18.3	5.5	n/a	82.00"
WB-06 (AC) Narrow	MOTRAC12HP	17.50	5.25	80	1.2"	5.42	1.6	n/a	35.13"
TP-30 (DC)	MOTRPM0102	17.50	4.38	100	4"	18.3	4.6	n/a	174.00"
TP-30 (AC)	MOTRAC0050	17.25	2.63	100	4"	18.1	2.7	n/a	174.00"
WEP-40/22 (DC) Elevator	MOTRPM0102	29.17	7.29	60	4"	30.5	7.6	4.0"/12.0"	180.00"
WEP-40/22 (DC) Horizontal	MOTRPM0102	17.50	4.38	100	4"	18.3	4.6	12.0"	110.00"
WEP-40/22 (AC) Elevator	MOTRAC0050-M	28.75	4.38	50	4"	30.1	4.6	4.0"/12.0"	180.00"
WEP-40/22 (AC) Horizontal	MOTRAC0050-M	17.25	2.59	100	4"	18.1	2.7	12.0"	110.00"
WEP-80/22 (DC) Elevator	MOTRPM0102	29.17	7.29	60	4"	30.5	7.6	4.0"/12.0"	191.00"
WEP-80/22 (DC) Horizontal	MOTRPM0102	17.50	4.38	100	4"	18.3	4.6	12.0"	110.00"
WEP-80/22 (AC) Elevator	MOTRAC0050-M	28.75	4.31	60	4"	30.1	4.5	4.0"/12.0"	191.00"
WEP-80/22 (AC) Horizontal	MOTRAC0050-M	17.25	2.59	100	4"	18.1	2.7	12.0"	110.00"
WEP-120/22 (DC) Elevator	MOTRPM0102	29.17	7.29	60	4"	30.5	7.6	4.0"/12.0"	191.00"
WEP-120/22 (DC) Horizontal	MOTRPM0102	17.50	4.38	100	4"	18.3	4.6	n/a	132.00"
WEP-120/22 (AC) Elevator	MOTRAC0050-M	28.75	4.31	60	4"	30.1	4.5	4.0"/12.0"	191.00"
WEP-120/22 (AC) Horizontal	MOTRAC0050-M	17.25	2.59	100	4"	18.1	2.7	n/a	132.00"



FT/FS Series Feeder

Centrifugal Feeders

With over 55 years experience designing, engineering and building centrifugal feeders, Shibuya Hoppmann is the pioneer of creative solutions to your parts handling issues.

Our Hoppmann™ Centrifugal Feeders are designed to run effortlessly to meet the lowest, to highest, parts per minute rate demands. Our machines are extremely versatile - using simple designs, flexible technology and based on years of experience.

Shibuya Hoppmann offers different styles of feeders for different requirements: the FT Series for efficient handling of small, medium and large parts at high speeds; the FS Series for bottles and other cylindrical shapes; and the FR Series where air ramps are used to singulate and orient parts.

Shibuya Hoppmann continues to advance our handling capabilities with new innovative designs; the introduction of our Platform Feeder, versatile change tooling for multiple part applications, puck feeders, linear feeding, etc. Our feeders are easy to integrate with other equipment, such as continuous motion assembly turrets, placement modules, inspection stations and more.



FR Series Feeder



Specialty Feeders



Product Overview:

The FT-10-RD centrifugal feeder meets the stringent demands of pharmaceutical, cosmetic and electronics feeding applications. This feeder is ideally suited for small parts requiring a high degree of precision. The delivery rate varies from moderate to high speeds depending on part characteristics. The FT-10-RD is engineered to interface with prefeeders, accumulating conveyors, labelers and assembly equipment.

Part Number	FT101RLDSA	FT101RLASA
Motor Style	DC	AC
Motor Voltage	180V	220V
Horsepower	1/5hp	1/5hp
Total Equipment Weight	125 lbs. / 57 kg	

Standard Features:

- Unique single drive system
- Variable rim speed control
- Polyurethane bowl
- Delrin center disc

Optional Features:

- All stainless steel exterior construction

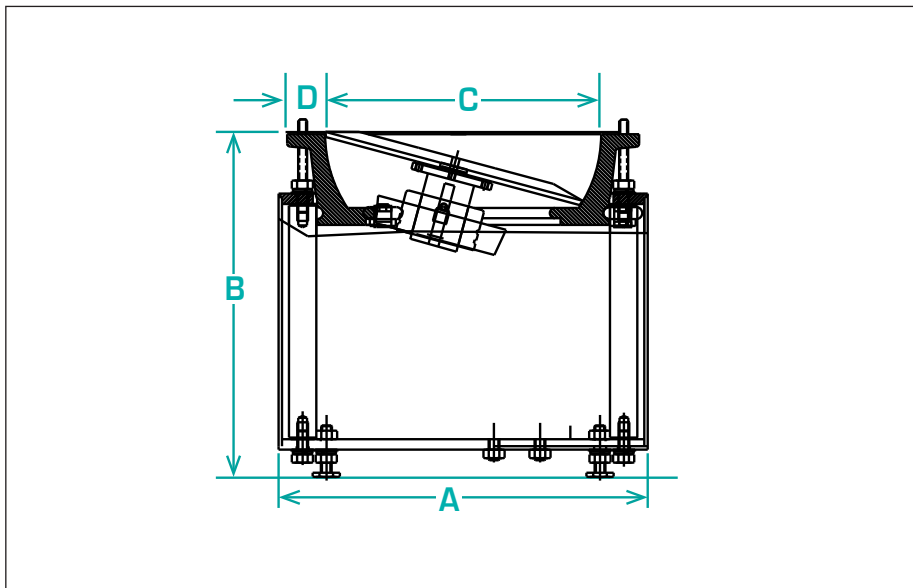

Product Specifications		ANSI	Metric
A	Frame Width and Length	13.50" x 15.50"	343.0 x 394.0mm
B	Overall Height/Discharge Height	14.50" ± 1"	358.0 ± 25mm
C	Inside Bowl Diameter	10.00"	254.0mm
D	Bowl Rim Width	1.50"	38.1mm

Shibuya Hoppmann™

FT-15-RD Centrifugal Feeder



Product Overview:

Shibuya Hoppmann's FT-15-RD centrifugal feeder, one in a series of FT feeders, is ideally suited to efficiently feed and orient small parts. The delivery rate varies from moderate to high speeds depending on part characteristics. The FT-15 is engineered to interface with prefeeders, accumulating conveyors, and assembly equipment.

Part Number	FT151RLDSA	FT151RLASA
Motor Style	DC	AC
Motor Voltage	90V	230/460V
Horsepower	1/5 hp	1/5 hp
Total Equipment Weight	134 lbs. / 61 kg	

Standard Features:

- All stainless steel exterior construction
- Square tooling frame
- Teflon Hardcoat Anodized aluminium bowl
- disc and bowl

Available Options

- Polycarbonate covers
- Dual motor drive system
- NEMA 1 encased controller
- Washdown motor(s)

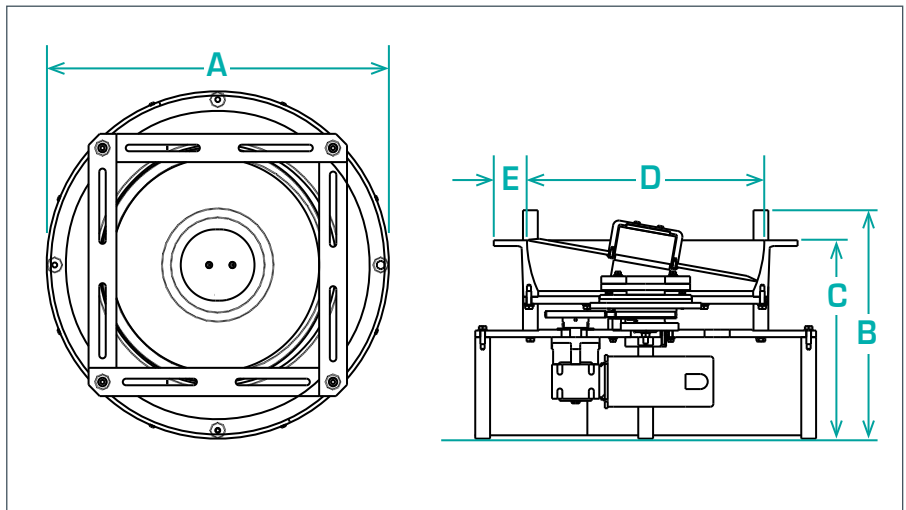

Required Accessories:

Clockwise: Square Tooling Frame	BUCWFT15SU
Counter-Clockwise: Square Tooling Frame	BUCCF15SU

Product Specifications		ANSI	Metric
A	Overall Diameter	23.00"	584.0mm
B	Overall Height	16.00" ± 1"	405.0 ± 25mm
C	Bowl Discharge Height	12.75" ± 1"	324.0 ± 25mm
D	Bowl Inner Diameter	16.00"	406.0mm
E	Rim Width	2.25"	57.0mm

Shibuya Hoppmann™

FT-20-RD Centrifugal Feeder



Product Overview:

Shibuya Hoppmann's standard FT-20 rigid disc centrifugal feeder is designed to feed a variety of products with its unique bowl design. Product is metered into the bowl and brought out to the bowl rim where a series of qualifiers gently orient the part for transfer to various downstream inline devices. Note: Tooling is not included with this unit.

Part Number	FT201RLDSA	FT201RLASA
Motor Style	DC	AC
Motor Voltage	90V	230/460V
Horsepower	1/5hp	1/3hp
Total Equipment Weight	150 lbs. / 68 kg	

Standard Features:

- All stainless steel exterior construction
- Square tooling frame
- FDA approved ABS vacuum formed disc
- Teflon Hardcoat Anodized aluminium bowl

Available Options:

- Polycarbonate covers
- Dual motor drive system
- Washdown motor(s)
- NEMA 1 encased controller

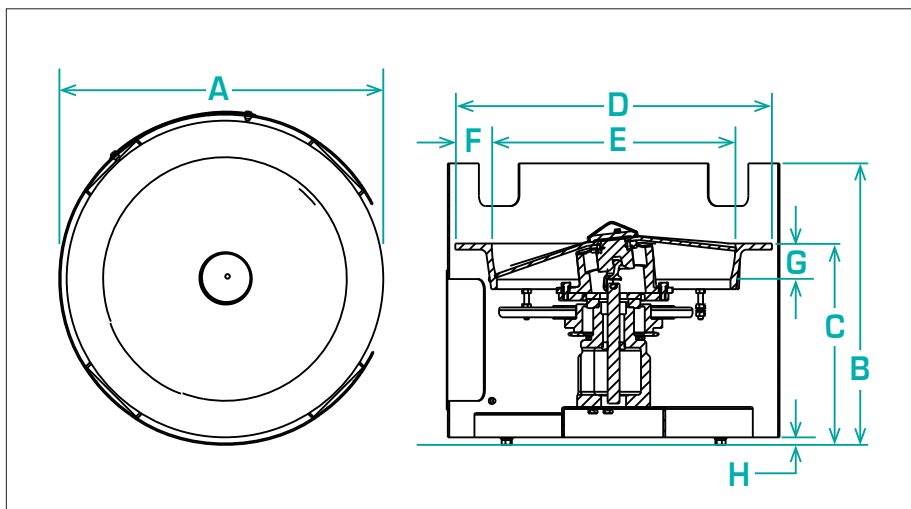

Required Accessories:

Clockwise: Square Tooling Frame	BUCWFT20SU
Counter-Clockwise: Square Tooling Frame	BUCCT20SU

Product Specifications		ANSI	Metric
A	Outside Diameter	27.24"	692.0mm
B	Overall Height	24.25"	616.0mm
C	Bowl Discharge Height	15.66" ± 2"	398.0 ± 51mm
D	Bowl Outside Diameter	25.75"	654.0mm
E	Bowl Inside Diameter	20.25"	514.0mm
F	Rim Width	2.75"	70.0mm
G	Bowl Depth	2.50"	64.0mm
H	Level Foot Adjustment	1.75"	44.0mm

FT-30-RD Centrifugal Feeder

Product Overview:

Shibuya Hoppmann's standard FT-30 rigid disc centrifugal feeder is designed to feed a variety of products with its unique bowl design. Product is metered into the bowl and brought out to the bowl rim where a series of qualifiers gently orient the part for transfer to various downstream inline devices. Note: Tooling is not included with this unit.



Part Number	FT301RLDSA	FT301RLASA
Motor Style	DC	AC
Motor Voltage	90V	230/460V
Horsepower	1/3hp	1/3hp
Total Equipment Weight	350 lbs. / 159 kg	

Standard Features:

- All stainless steel exterior construction
- Square tooling frame
- FDA approved ABS vacuum formed disc
- Teflon Hardcoat Anodized aluminium bowl

Available Options:

- Polycarbonate covers
- Dual motor drive system
- Washdown motor(s)
- NEMA 1 encased controller

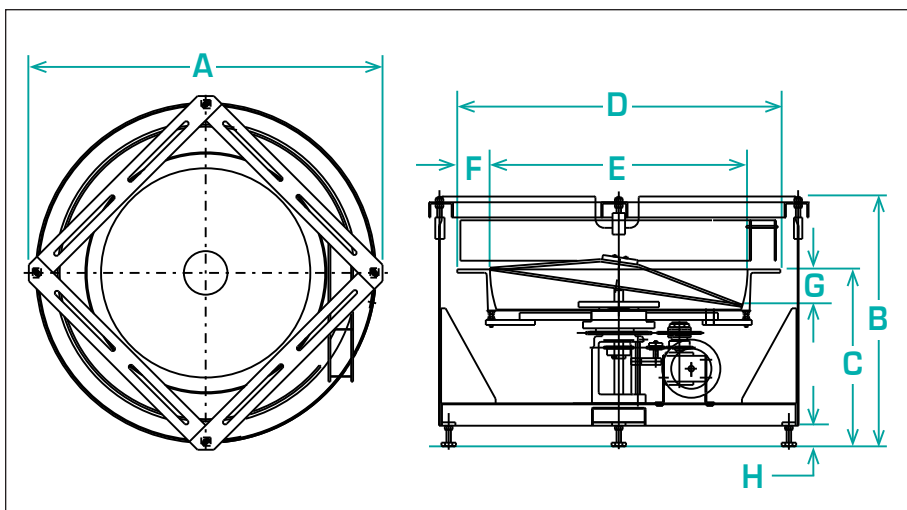

Required Accessories:

Clockwise: Square Tooling Frame	BUCWFT30SU
Counter-Clockwise: Square Tooling Frame	BUCCT30SU

Product Specifications		ANSI	Metric
A	Outside Diameter	42.26"	1073.4mm
B	Overall Height	27.42"	696.5mm
C	Bowl Discharge Height	19.93"	506.2mm
D	Bowl Outside Diameter	36.13"	917.7mm
E	Bowl Inside Diameter	28.80"	731.5mm
F	Rim Width	3.67"	93.2mm
G	Bowl Depth	3.90"	99.1mm
H	Level Foot Adjustment	2.29"	58.2mm

Shibuya Hoppmann™

FT-40-RD Centrifugal Feeder



Product Overview:

Shibuya Hoppmann's standard FT-40 rigid disc centrifugal feeder is designed to feed a variety of products with its unique bowl design. Product is metered into the bowl and brought out to the bowl rim where a series of qualifiers gently orient the part for transfer to various downstream inline devices. Note: Tooling is not included with this unit.

Part Number	FT401RLDSA	FT401RLASA
Motor Style	DC	AC
Motor Voltage	90V	230/460V
Horsepower	1/2hp	1/2hp
Total Equipment Weight	850 lbs. / 385 kg	

Standard Features:

- All stainless steel exterior construction
- FDA approved ABS vacuum formed disc
- Teflon Hardcoat Anodized aluminium bowl

Available Options:

- Polycarbonate covers
- Dual motor drive system
- Washdown motor(s)
- NEMA 1 encased controller

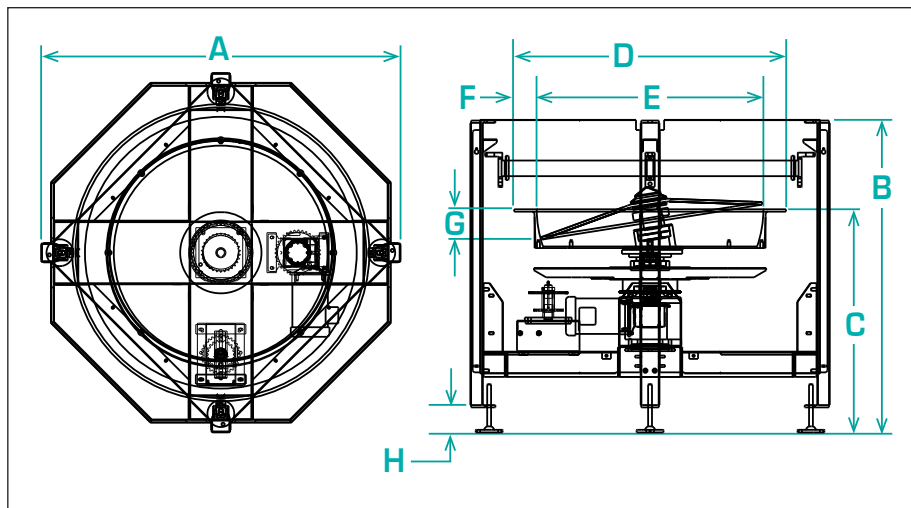

Required Accessories:

Clockwise: Backup Ring	BUCWFT40SU
Counter-Clockwise: Backup Ring	BUCCF40SU

Product Specifications		ANSI	Metric
A	Outside Diameter	57.48"	1460.0mm
B	Overall Height	49.88"	1267.0mm
C	Bowl Discharge Height	35.68"	906.3mm
D	Bowl Outside Diameter	43.46"	1103.9mm
E	Bowl Inside Diameter	36.25"	920.8mm
F	Rim Width	3.61"	91.7mm
G	Bowl Depth	6.20"	157.5mm
H	Level Foot Adjustment	4.00"	101.6mm

FT-50-RD Centrifugal Feeder



Product Overview:

Shibuya Hoppmann's standard FT-50 rigid disc centrifugal feeder is designed to feed a variety of products with its unique bowl design. Product is metered into the bowl and brought out to the bowl rim where a series of qualifiers gently orient the part for transfer to various downstream inline devices. Note: Tooling is not included with this unit.

Part Number	FT501RLDSA	FT501RLASA
Motor Style	DC	AC
Motor Voltage	90V	208-230/460V
Horsepower	1/2hp	1/2hp
Total Equipment Weight	1050 lbs. / 476 kg	

Standard Features:

- All stainless steel exterior construction
- FDA approved ABS vacuum formed disc
- Teflon Hardcoat Anodized aluminium bowl

Available Options:

- Polycarbonate covers
- Dual motor drive system
- Washdown motor(s)
- NEMA 1 encased controller

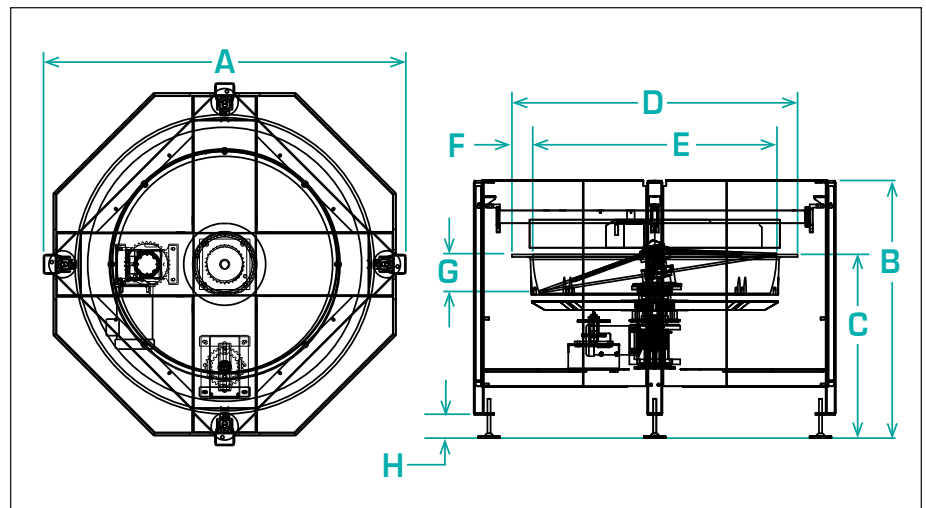

Required Accessories:

Clockwise: Backup Ring	BUCWFT50SU
Counter-Clockwise: Backup Ring	BUCCF50SU

Product Specifications		ANSI	Metric
A	Outside Diameter	71.00"	1803.4mm
B	Overall Height	50.45"	1281.4mm
C	Bowl Discharge Height	36.00"	914.4mm
D	Bowl Outside Diameter	56.00"	1422.4mm
E	Bowl Inside Diameter	47.75"	1212.9mm
F	Rim Width	4.13"	104.9mm
G	Bowl Depth	7.88"	200.2mm
H	Level Foot Adjustment	4.57"	116.1mm

Shibuya Hoppmann™

FT-60-RD Centrifugal Feeder



Product Overview:

Shibuya Hoppmann's standard FT-60 rigid disc centrifugal feeder is designed to feed a variety of products with its unique bowl design. Product is metered into the bowl and brought out to the bowl rim where a series of qualifiers gently orient the part for transfer to various downstream inline devices. Note: Tooling is not included with this unit.

Part Number	FT601RLDSA	FT601RLASA
Motor Style	DC	AC
Motor Voltage	90V	208-230/460V
Horsepower	3/4hp	3/4hp
Total Equipment Weight	1400 lbs. / 635 kg	

Standard Features:

- All stainless steel exterior construction
- FDA approved ABS vacuum formed disc
- Teflon Hardcoat Anodized aluminium bowl

Available Options:

- Polycarbonate covers
- Dual motor drive system
- Washdown motor(s)
- NEMA 1 encased controller

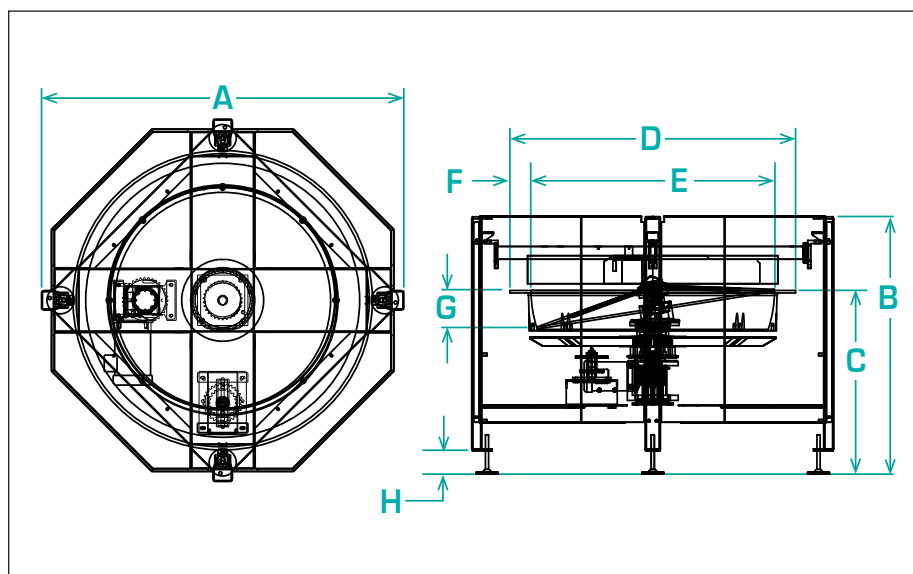

Required Accessories:	
Clockwise: Backup Ring	BUCWFT60SU
Counter-Clockwise: Backup Ring	BUCCT60SU

Product Specifications		ANSI	Metric
A	Outside Diameter	85.12"	2162.0mm
B	Overall Height	50.13"	1273.3mm
C	Bowl Discharge Height	35.76"	908.3mm
D	Bowl Outside Diameter	70.00"	1778.0mm
E	Bowl Inside Diameter	60.00"	1524.0mm
F	Rim Width	5.00"	127.0mm
G	Bowl Depth	10.00"	254.0mm
H	Level Foot Adjustment	3.58"	90.9mm

FS-20-RD Centrifugal Feeder

Product Overview:

The standard FS-20 scallop feeder is designed to feed and orient bottles and other cylindrical parts with the use of urethane scallops. Parts are radially oriented and gently qualified in the scallop pockets by means of sweeps, wipers, pneumatic and/or electric devices depending on specific product characteristics. Oriented parts are discharged and carried away by various downstream in-line devices. Note: Tooling is not included with this unit.



Part Number	FS201RLDSA	FS201RLASA
Motor Style	DC	AC
Motor Voltage	90V	230/460V
Horsepower	1/3hp	1/3hp
Total Equipment Weight	400 lbs. / 181 kg	

Standard Features:

- All stainless steel exterior construction
- FDA approved ABS vacuum formed disc
- Teflon Hardcoat Anodized aluminium bowl
- Air clutch
- Hinged polycarbonate cover with safety interlocks
- Backup Ring

Available Options:

- Washdown motor(s)
- NEMA 1 encased controller

*Scallops - please contact Shibuya Hoppmann for more information.

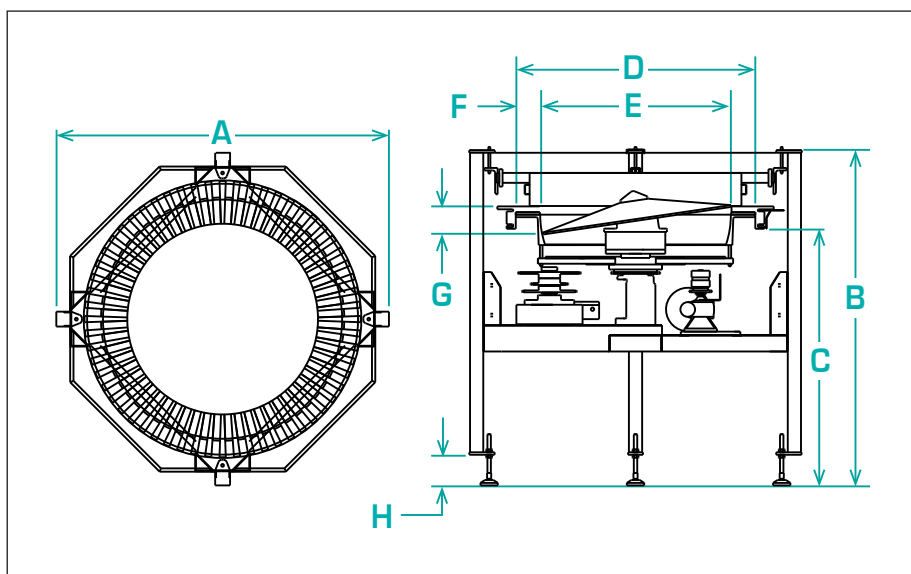

Product Specifications		ANSI	Metric
A	Outside Diameter	40.00"	1016.0mm
B	Overall Height	42.00"	1067.0mm
C	Bowl Discharge Height	32.25"	819.2mm
D	Bowl Outside Diameter	25.50"	648.0mm
E	Bowl Inside Diameter	20.25"	514.0mm
F	Rim Width	2.63"	67.0mm
G	Bowl Depth	3.36"	85.3mm
H	Level Foot Adjustment	5.00" ± 2.5"	127.0 ± 64mm

FS-30-RD Centrifugal Feeder



Product Overview:

The standard FS-30 scallop feeder is designed to feed and orient bottles and other cylindrical parts with the use of urethane scallops. Parts are radially oriented and gently qualified in the scallop pockets by means of sweeps, wipers, pneumatic and/or electric devices depending on specific product characteristics. Oriented parts are discharged and carried away by various downstream in-line devices. Note: Tooling is not included with this unit.

Part Number	FS301RLDSA	FS301RLASA
Motor Style	DC	AC
Motor Voltage	90V	230/460V
Horsepower	1/3hp	1/3hp
Total Equipment Weight	450 lbs. / 204 kg	

Standard Features:

- All stainless steel exterior construction
- FDA approved ABS vacuum formed disc
- Teflon Hardcoat Anodized aluminium bowl
- Air clutch
- Hinged polycarbonate cover with safety interlocks
- Backup Ring

Available Options:

- Washdown motor(s)
- Urethane scallop kit
- NEMA 1 encased controller

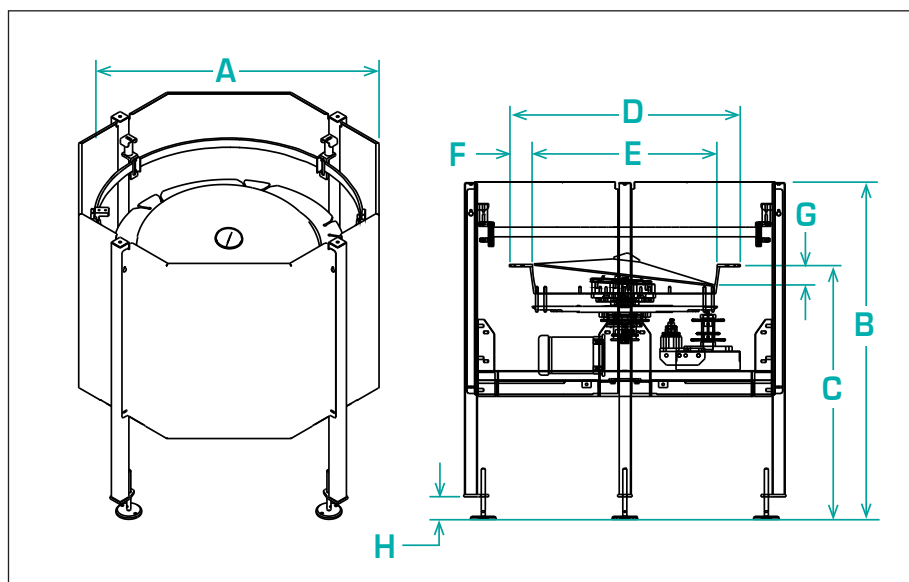

Accessories:

FS Series Scallop Kit	FS30SCALXX
-----------------------	------------

(includes segment plates and one of the following number of scallops: 36, 48, 54, 60 or 72)

Product Specifications		ANSI	Metric
A	Outside Diameter	50.24"	1276.1mm
B	Overall Height	52.49"	1333.2mm
C	Bowl Discharge Height	39.76"	1010.0mm
D	Bowl Outside Diameter	36.00"	914.4mm
E	Bowl Inside Diameter	28.79"	731.3mm
F	Rim Width	3.60"	91.4mm
G	Bowl Depth	4.60"	116.9mm
H	Level Foot Adjustment	3.50"	88.9mm

Shibuya Hoppmann™

FS-40-RD Centrifugal Feeder



Product Overview:

The FS-40 scallop feeder is designed to feed and orient bottles and other cylindrical parts with the use of urethane scallops. Parts are radially oriented and gently qualified in the scallop pockets by means of sweeps, wipers, pneumatic and/or electric devices depending on specific product characteristics. Oriented parts are discharged and carried away by various downstream in-line devices. Note: Tooling is not included with this unit.

Part Number	FS401RLDSA	FS401RLASA
Motor Style	DC	AC
Motor Voltage	90V	230/460V
Horsepower	1/2hp	1/2hp
Total Equipment Weight	1050 lbs. / 476 kg	

Standard Features:

- All stainless steel exterior construction
- FDA approved ABS vacuum formed disc
- Teflon Hardcoat Anodized aluminium bowl predrilled for scallop mounting
- Air clutch
- Hinged polycarbonate cover with safety interlocks
- Backup Ring

Available Options:

- Washdown motor(s)
- Urethane scallop kit
- NEMA 1 encased controller

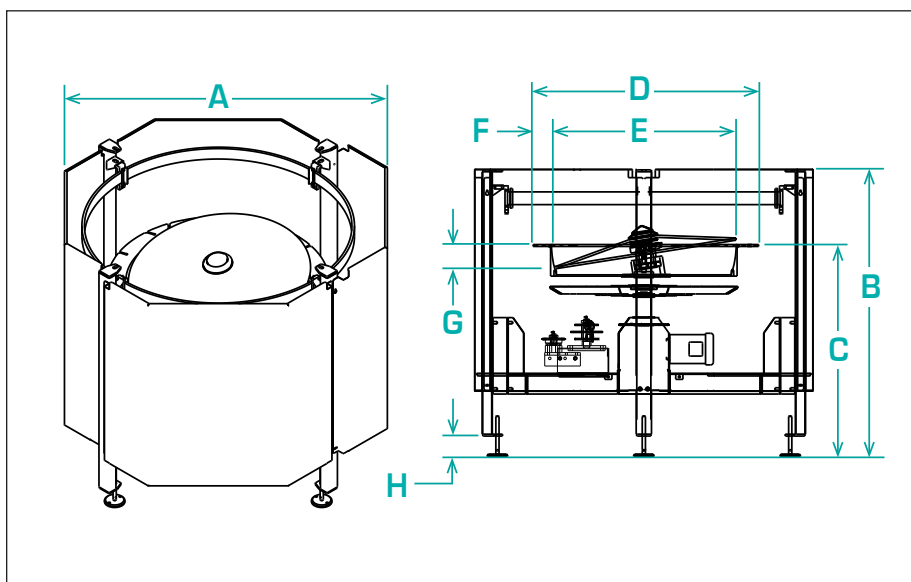

Accessories:	
FS Series Scallop Kit	FS40SCALXX
(includes segment plates and one of the following number of scallops: 36, 48, 54, 60 or 72)	

Product Specifications		ANSI	Metric
A	Outside Diameter	63.48"	1612.4mm
B	Overall Height	56.25"	1428.8mm
C	Bowl Discharge Height	38.75"	984.3mm
D	Bowl Outside Diameter	43.46"	1103.9mm
E	Bowl Inside Diameter	36.25"	920.8mm
F	Rim Width	3.61"	91.7mm
G	Bowl Depth	6.20"	157.5mm
H	Level Foot Adjustment	4.00"	101.6mm

Shibuya Hoppmann™

FS-50-RD Centrifugal Feeder



Product Overview:

Shibuya Hoppmann's standard FS-50 scallop feeder is designed to feed and orient bottles and other cylindrical parts with the use of urethane scallops. Parts are radially oriented and gently qualified in the scallop pockets by means of sweeps, wipers, pneumatic and/or electric devices depending on specific product characteristics. Oriented parts are discharged and carried away by various downstream in-line devices. Note: Tooling is not included with this unit.

Part Number	FS501RLDSA	FS501RLASA
Motor Style	DC	AC
Motor Voltage	90V	230/460V
Horsepower	3/4hp	3/4hp
Total Equipment Weight	1200 lbs. / 545 kg	

Standard Features:

- All stainless steel exterior construction
- FDA approved ABS vacuum formed disc
- Teflon Hardcoat Anodized aluminium bowl predrilled for scallop mounting
- Air clutch
- Hinged polycarbonate cover with safety interlocks
- Backup Ring

Available Options:

- Washdown motor(s)
- Urethane scallop kit
- NEMA 1 encased controller

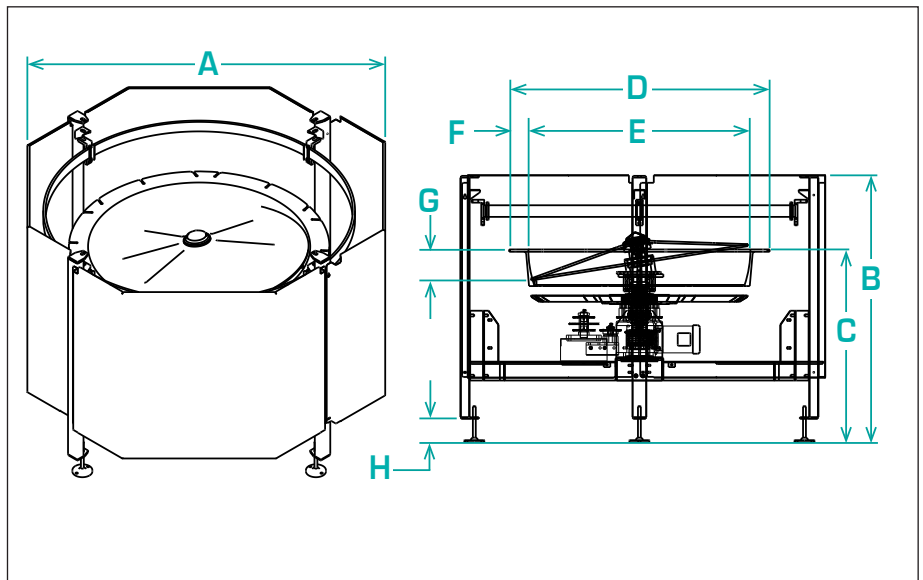

Accessories:

FS Series Scallop Kit	FS50SCALXX
(includes segment plates and one of the following number of scallops: 36, 48, 54, 60 or 72)	

Product Specifications	ANSI	Metric
A Outside Diameter	77.00"	1955.8mm
B Overall Height	57.25"	1454.2mm
C Bowl Discharge Height	41.43"	1052.3mm
D Bowl Outside Diameter	55.90"	1419.7mm
E Bowl Inside Diameter	47.75"	1212.9mm
F Rim Width	4.13"	104.9mm
G Bowl Depth	7.88"	200.2mm
H Level Foot Adjustment	5.00"	127.0mm

Shibuya Hoppmann™

FS-60-RD Centrifugal Feeder



Product Overview:

Shibuya Hoppmann's standard FS-60 scallop feeder is designed to feed and orient bottles and other cylindrical parts with the use of urethane scallops. Parts are radially oriented and gently qualified in the scallop pockets by means of sweeps, wipers, pneumatic and/or electric devices depending on specific product characteristics. Oriented parts are discharged and carried away by various downstream in-line devices. Note: Tooling is not included with this unit.

Part Number	FS601RLDSA	FS601RLASA
Motor Style	DC	AC
Motor Voltage	90V	230/460V
Horsepower	1hp	1hp
Total Equipment Weight	1600 lbs. / 726 kg	

Standard Features:

- All stainless steel exterior construction
- FDA approved ABS vacuum formed disc
- Teflon Hardcoat Anodized aluminium bowl predrilled for scallop mounting
- Air clutch
- Hinged polycarbonate cover with safety interlocks
- Backup Ring

Available Options:

- Washdown motor(s)
- Urethane scallop kit
- NEMA 1 encased controller

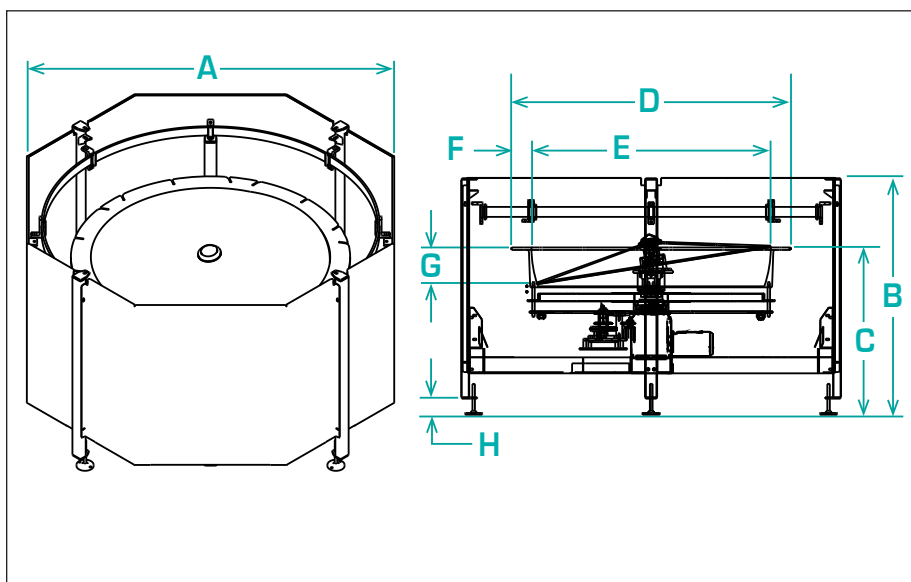

Accessories:

FS Series Scallop Kit	FS60SCALXX
(includes segment plates and one of the following number of scallops: 36, 48, 54, 60 or 72)	

Product Specifications	ANSI	Metric
A Outside Diameter	95.20"	2418.1mm
B Overall Height	59.25"	1504.9mm
C Bowl Discharge Height	41.90"	1064.3mm
D Bowl Outside Diameter	70.00"	1778.0mm
E Bowl Inside Diameter	60.00"	1524.0mm
F Rim Width	5.00"	127.0mm
G Bowl Depth	10.00"	254.0mm
H Level Foot Adjustment	4.00"	101.6mm

FR-20 Centrifugal Feeder



Product Overview:

The standard FR-20 feeds and orients a wide variety of parts utilizing a stationary loading ramp and the products natural weight bias. The delivery rate varies from moderate to high speed depending on part characteristics.

Part Number	FR20XXXDSA	FR20XXXASA
Motor Style	DC	AC
Motor Voltage	90V	230/460V
Horsepower	1/5hp	1/4hp
Total Equipment Weight	210 lbs. / 95 kg	

Standard Features:

- All stainless steel exterior construction
- Teflon Hardcoat Anodized aluminium bowl

Available Options:

- Washdown motor(s)
- Polycarbonate covers
- NEMA 1 encased controller
- Air ramp

Required Accessories:	
Clockwise Air Ramp	ARCWFR20SU
Clockwise Square Frame Backup Ring	BUCWFR20SU
Counter-Clockwise Air Ramp	ARCCFR20SU
Counter-Clockwise Square Backup Ring	BUCCFR20SU

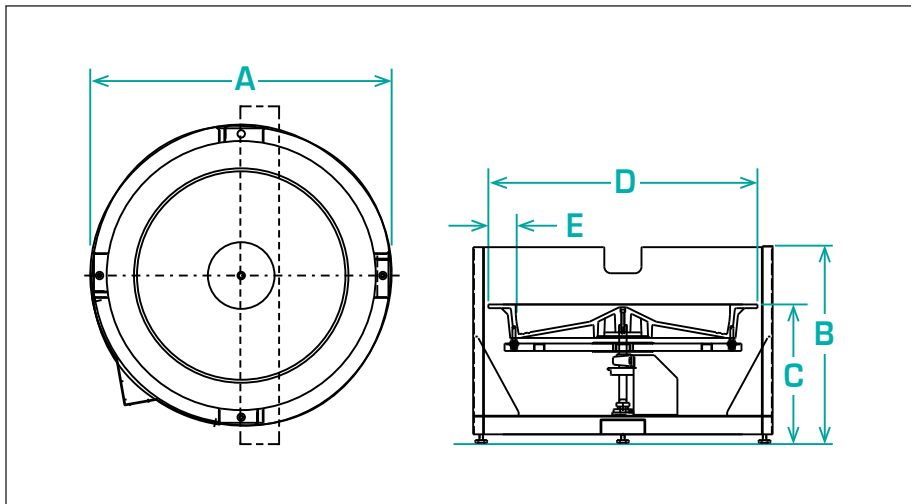

Product Specifications		ANSI	Metric
A	Outer Wall Diameter	27.25"	693.0mm
B	Overall Height	24.25" ± 1"	615.0 ± 25mm
C	Bowl Discharge Height	17.50"	445.0mm
D	Bowl Outside Diameter	24.81"	631.0mm
E	Rim Width	2.32"	59.0mm

FR-30 Centrifugal Feeder



Product Overview:

The standard FR-30 feeds and orients a wide variety of parts utilizing a stationary loading ramp and the products natural weight bias. The delivery rate varies from moderate to high speed depending on part characteristics.

Part Number	FR30XXXDSA	FR30XXXASA
Motor Style	DC	AC
Motor Voltage	90V	230/460V
Horsepower	1/5hp	1/4hp
Total Equipment Weight	350 lbs. / 159 kg	

Standard Features:

- All stainless steel exterior construction
- Teflon Hardcoat Anodized aluminium bowl

Available Options:

- Washdown motor(s)
- Polycarbonate covers
- NEMA 1 encased controller
- Air ramp

Required Accessories:	
Clockwise Air Ramp	ARCWFR30SU
Clockwise Square Frame Backup Ring	BUCWFR30SU
Counter-Clockwise Air Ramp	ARCCFR30SU
Counter-Clockwise Square Backup Ring	BUCCFR30SU

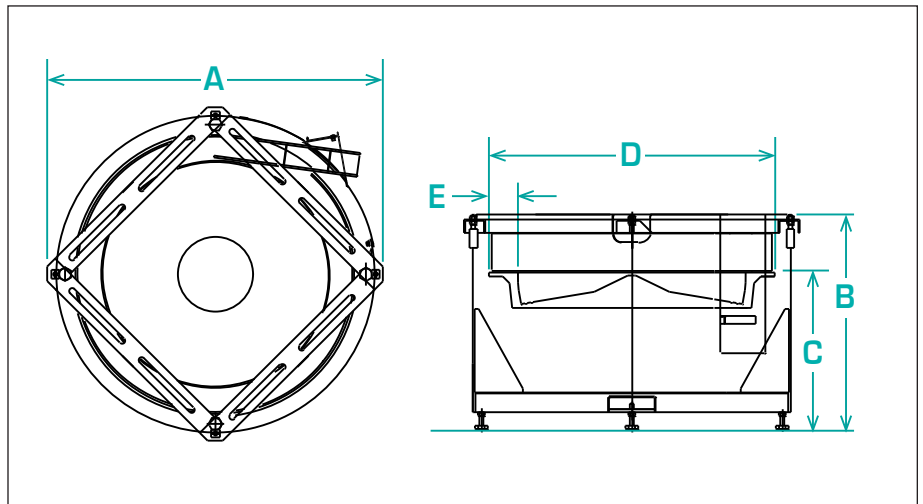

Product Specifications		ANSI	Metric
A	Outer Wall Diameter	40.50"	1029.0mm
B	Overall Height	25.25" ± 1.0"	667.0 ± 25mm
C	Bowl Discharge Height	18.50"	470.0mm
D	Bowl Outside Diameter	36.13"	918.0mm
E	Rim Width	3.63"	92.0mm

Shibuya Hoppmann™

FTF-30-RD Centrifugal Feeder



Product Overview:

Shibuya Hoppmann's standard FTF-30 rigid disc centrifugal feeder is designed to feed a variety of products in a food-grade environment with its unique bowl design. Product is metered into the bowl and brought out to the bowl rim where a series of qualifiers gently orient the part for transfer to various downstream inline devices. Note: Tooling is not included with this unit.

Part Number	FT301RLDFA	FT301RLAFA
Motor Style	DC	AC
Motor Voltage	90V	230/460V
Horsepower	1/3hp	1/3hp
Total Equipment Weight	350 lbs. / 159 kg	

Standard Features:

- All stainless steel exterior construction
- Square tooling frame
- FDA approved ABS vacuum formed disc
- Teflon Hardcoat Anodized aluminium bowl
- Washdown motors and drive assembly
- Upgraded drive components

Available Options:

- Polycarbonate covers
- NEMA 1 encased controller

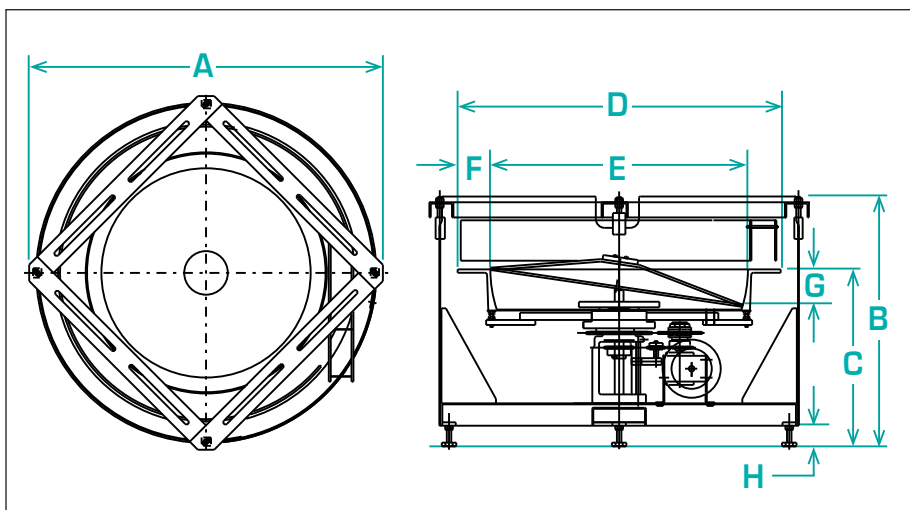

Required Accessories:	
Clockwise: Square Tooling Frame	BUCWFT30FU
Counter-Clockwise: Square Tooling Frame	BUCCF30FU

Product Specifications		ANSI	Metric
A	Outside Diameter	40.21"	1021.0mm
B	Overall Height	22.79"	579.0mm
C	Bowl Discharge Height	17.51"	445.0mm
D	Bowl Outside Diameter	36.13"	918.0mm
E	Bowl Inside Diameter	28.79"	731.0mm
F	Rim Width	3.67"	93.0mm
G	Bowl Depth	5.65"	144.0mm
H	Level Foot Adjustment	3.00" ± 1.5"	76.0 ± 38mm

Shibuya Hoppmann™

FTF-40-RD Centrifugal Feeder



Product Overview:

Shibuya Hoppmann's standard FTF-40 rigid disc centrifugal feeder is designed to feed a variety of products in a food-grade environment with its unique bowl design. Product is metered into the bowl and brought out to the bowl rim where a series of qualifiers gently orient the part for transfer to various downstream inline devices. Note: Tooling is not included with this unit.

Part Number	FT401RLDFA	FT401RLAFA
Motor Style	DC	AC
Motor Voltage	90V	230/460V
Horsepower	1/2hp	1/2hp
Total Equipment Weight	850 lbs. / 385 kg	

Standard Features:

- All stainless steel exterior construction
- Square tooling frame
- FDA approved ABS vacuum formed disc
- Teflon Hardcoat Anodized aluminium bowl
- Square tooling frame
- Washdown motors and drive assembly
- Upgraded drive components

Available Options:

- Polycarbonate covers
- Dual motor drive system

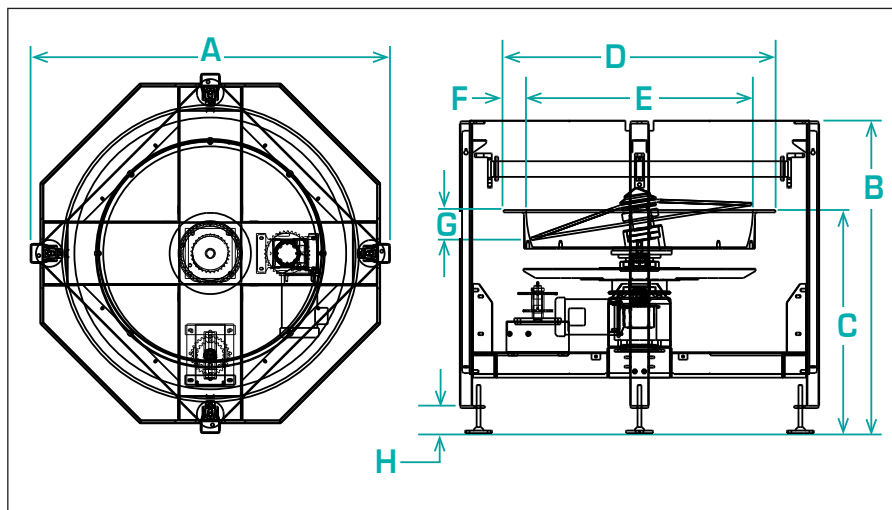

Required Accessories:	
Clockwise: Backup Ring	BUCWFT40FU
Counter-Clockwise: Backup Ring	BUCCF40FU

Product Specifications		ANSI	Metric
A	Outside Diameter	59.00"	1499.0mm
B	Overall Height	47.00" ± 1.5"	1194.0 ± 38mm
C	Bowl Discharge Height	36.00" ± 2.0"	914.0 ± 51mm
D	Bowl Outside Diameter	43.46"	1104.0mm
E	Bowl Inside Diameter	36.25"	921.0mm
F	Rim Width	3.61"	92.0mm
G	Bowl Depth	5.40"	137.0mm
H	Level Foot Adjustment	5.00" ± 2.5"	127.0 ± 64mm

FTF-50-RD Centrifugal Feeder

Product Overview:

Shibuya Hoppmann's standard FTF-50 rigid disc centrifugal feeder is designed to feed a variety of products in a food-grade environment with its unique bowl design. Product is metered into the bowl and brought out to the bowl rim where a series of qualifiers gently orient the part for transfer to various downstream inline devices. Note: Tooling is not included with this unit.



Part Number	FT501RLDFA	FT501RLAFA
Motor Style	DC	AC
Motor Voltage	90V	208-230/460V
Horsepower	1/2hp	1/2hp
Total Equipment Weight	1050 lbs. / 476 kg	

Standard Features:

- All stainless steel exterior construction
- FDA approved ABS vacuum formed disc
- Teflon Hardcoat Anodized aluminium bowl
- Square tooling frame
- Washdown motor(s)
- Upgraded drive components

Available Options:

- Polycarbonate covers
- Dual motor drive system

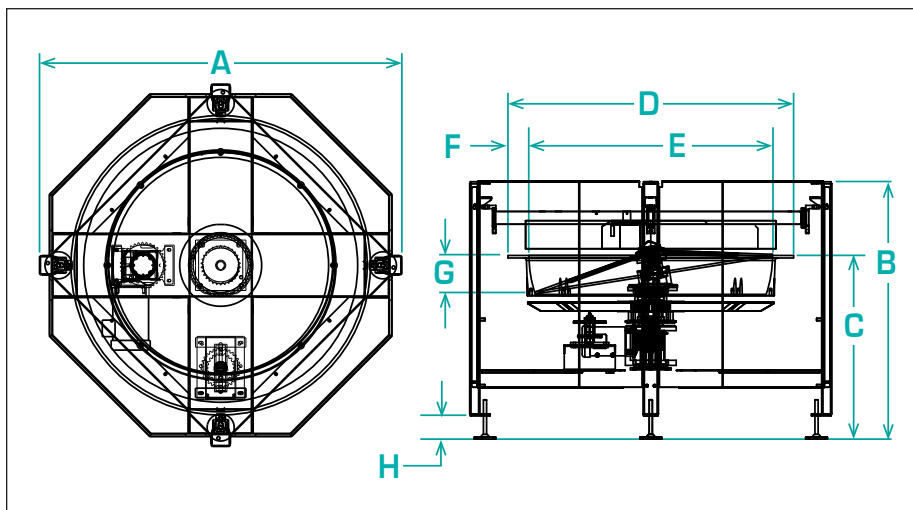

Required Accessories:	
Clockwise: Backup Ring	BUCWFT50FU
Counter-Clockwise: Backup Ring	BUCCF50FU

Product Specifications		ANSI	Metric
A	Outside Diameter	71.00"	1803.4mm
B	Overall Height	50.45"	1281.4mm
C	Bowl Discharge Height	36.00"	914.4mm
D	Bowl Outside Diameter	56.00"	1422.4mm
E	Bowl Inside Diameter	47.75"	1212.9mm
F	Rim Width	4.13"	104.9mm
G	Bowl Depth	7.88"	200.2mm
H	Level Foot Adjustment	4.57"	116.1mm

Product Overview:

Shibuya Hoppmann's standard FRS-60 is specifically designed to feed a wide range of large bottles and parts. The delivery rate varies from moderate to high speed depending on part characteristics. The FRS-60 is engineered to interface with Shibuya Hoppmann prefeeders, accumulating conveyors, assembly systems and other downstream equipment. Note: Tooling is not included with this unit.



Part Number	RS60XXXDSA	RS60XXXASA
Motor Style	DC	AC
Motor Voltage	90V	208-230/460V
Horsepower	3/4hp	3/4hp
Total Equipment Weight	2500 lbs. / 1134 kg	

Standard Features:

- All stainless steel exterior construction
- Air clutch
- Teflon Hardcoat Anodized aluminium bowl predrilled for scallop mounting
- Backup ring
- Polycarbonate safety covers

Available Options:

- Washdown motor
- Urethane scallop kit
- NEMA 1 encased controller

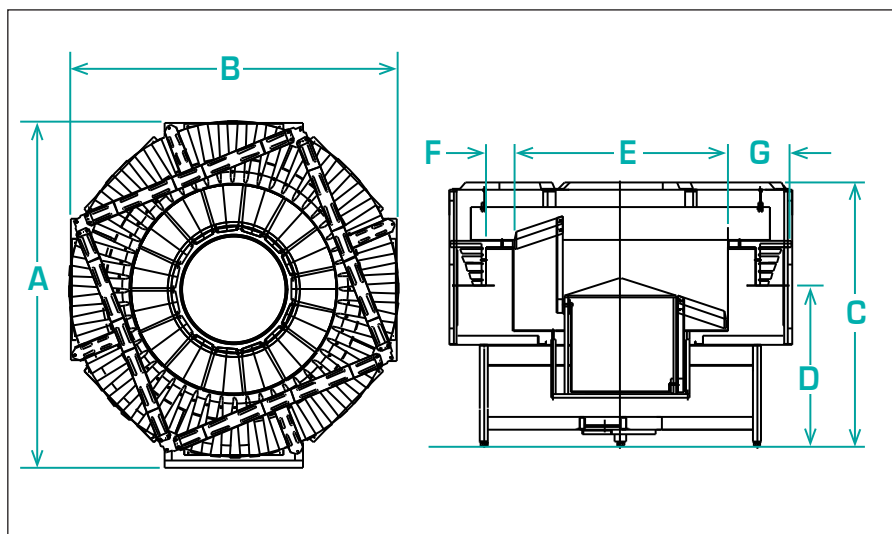

Required Accessories:	
FRS Series Scallop Kit (both styles)	URTHCAST64

Product Specifications		ANSI	Metric
A	Overall Width at Exit Zone	85.00"	2159.0mm
B	Overall Width	82.00"	2083.0mm
C	Overall Height	66.00" ± 5"	1676.0 ± 127mm
D	Discharge Height	40.00" ± 5"	1016.0 ± 127mm
E	Bowl Inside Diameter	51.79"	1315.0mm
F	Rim Width	8.00"	203.0mm
G	Scallop Length	12.00"	305.0mm

FD-30 Accumulation Table

Product Overview:

Shibuya Hoppmann's FD-30, is a flat disc centrifugal accumulation/feeder. Its low profile and large diameter disc is ideally suited for use as an inline accumulator, a parts turn table or feeder. The FD-30 is engineered to interface with Shibuya Hoppmann prefeeders, accumulating conveyors, assembly systems and other downstream equipment.



Part Number	FD30XXXDSA	FD30XXXASA
Motor Style	DC	AC
Motor Voltage	90V	230/460V
Horsepower	1/3hp	1/3hp
Total Equipment Weight	300 lbs. / 136 kg	

Standard Features:

- Stainless steel exterior construction
- PVC low friction flat disc
- C-Face motor/reducer

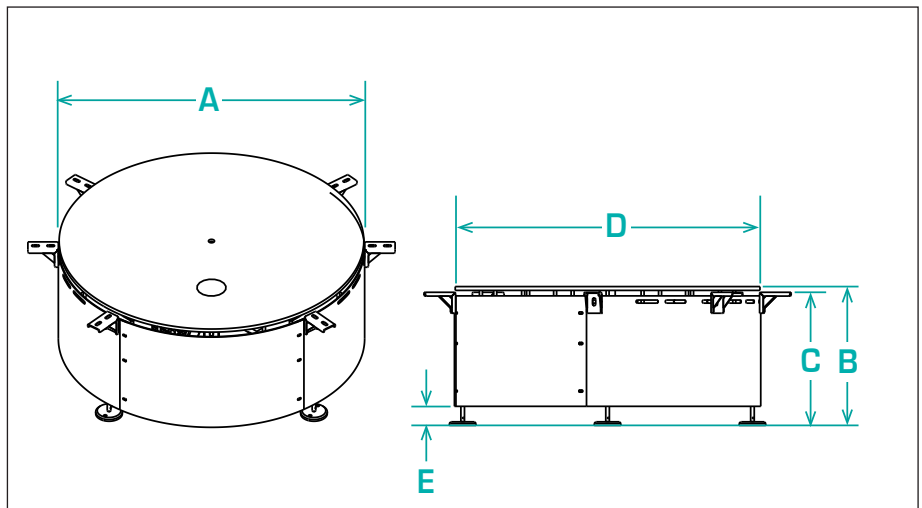

Product Specifications		ANSI	Metric
A	Outside Diameter	40.24"	1022.1mm
B	Overall Height	18.22" ± 2.5"	462.8 ± 63mm
C	Discharge Height	18.00" ± 2.5"	457.2 ± 63mm
D	Disc Diameter	40.00"	1016.0mm
E	Level Foot	2.50"	63.5mm

Shibuya Hoppmann™

FT-15-HD Heavy Duty Centrifugal Feeder



*Shown with optional prefeeder

Product Overview:

The new Hoppmann Heavy Duty FT-15 centrifugal feeder is engineered to handle small, metal parts traditionally oriented in vibratory feeders. The FT-15-HD offers greatly reduced noise output and smooth operation in comparison to a vibratory feeder, extremely accurate operational tolerances, and easily handles multiples sizes of parts with minor change over and no reduction in feed rate. Designed on the same premise as our standard centrifugal feeder, the Heavy Duty feeder uses motors for speed, not springs and vibrators, which limits maintenance (retuning) and replacement requirements.

Part Number	FT151RLDSA	FT151RLASA
Motor Style	DC	AC
Motor Voltage	90V	230/460V
Horsepower	1/15 hp	1/15 hp
Total Equipment Weight	134 lbs. / 61 kg	

Standard Features:

- All stainless steel exterior construction
- Adjustable tooling frame
- Polyurethane hybrid bowl and disc
- Ball bearing spindle
- Poly-V belt drive system

Available Options

- Polycarbonate covers
- Dual motor drive system
- NEMA 1 encased controller
- Washdown motor(s)

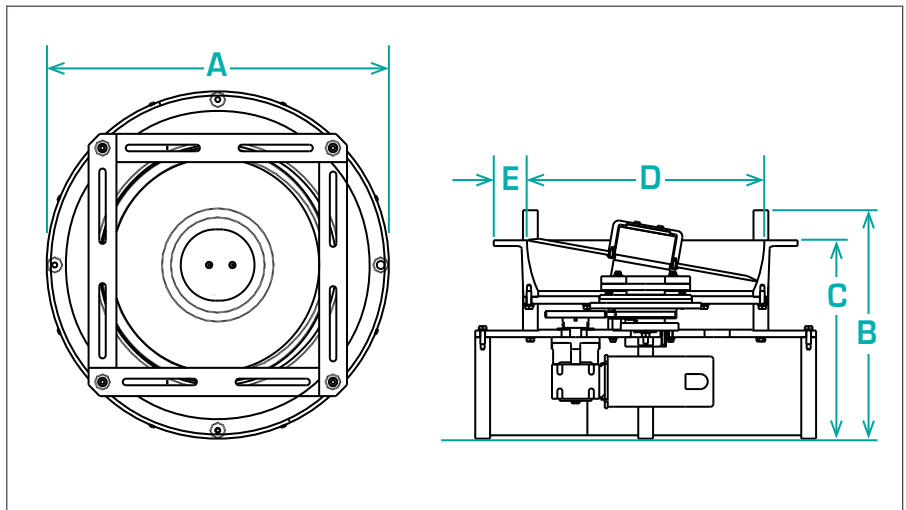

Product Specifications		ANSI	Metric
A	Overall Diameter	23.00"	584.0mm
B	Overall Height	16.00" ± 1"	405.0 ± 25mm
C	Bowl Discharge Height	12.75" ± 1"	324.0 ± 25mm
D	Bowl Inner Diameter	16.00"	406.0mm
E	Rim Width	2.25"	57.0mm

CapStar Cap Feeder



Product Overview:

The Capstar cap feeder is designed and engineered to feed and orient flat screw caps, tamper evident caps and other minimal featured products at speeds ranging from 40 to 600 parts per minute. Changeover from one cap to another takes less than five (5) minutes. The cleated elevator belt has a nominal cleat height of 2.00" and a cleat pitch of 4.00" allowing for maximum product loading. It is recommended that the cap diameter not exceed 3.50" with the standard belt, however, other belt sizes are available. Note: Tooling is not included with this unit.

Part Number	FCCPSTRDSA (right hand unit)	FCCPSTLDSA (left hand unit)
Motor Style	DC	DC
Motor Voltage	90V	90V
Horsepower - Horizontal Belt	1/8hp	1/8hp
Horsepower - Elevator Belt	1/5hp	1/5hp

Standard Features:

- Polypropylene modular plastic belt
- Manually adjustable discharge height
- FDA approved white urethane cover continuous belt
- No tool changeover
- Small footprint
- Mounted encased controller
- Hopper agitator
- Casters and fixed feet

Available Options:

- Elevator extensions
- Continuous welded hopper seams
- Elevator/hopper covers
- Washdown motors

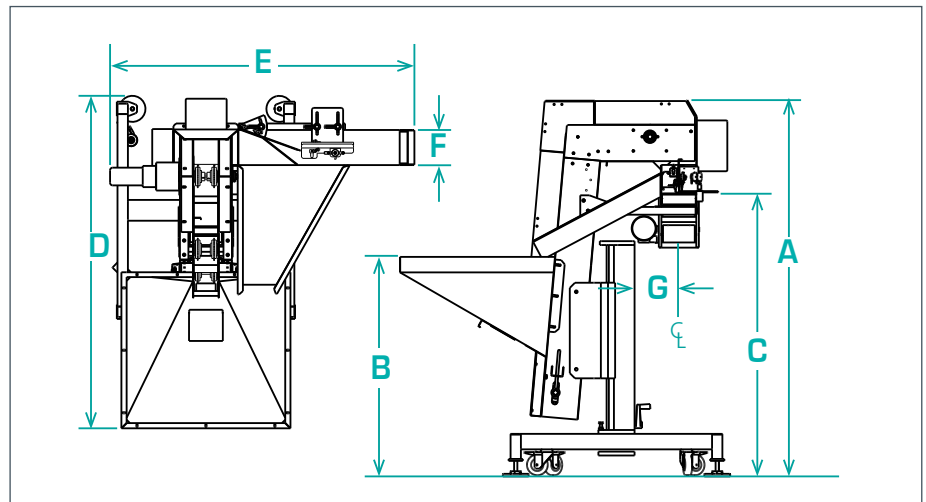

Product Specifications	ANSI	Metric
A Overall Height	65.13" - 81.13"	1655.0 - 2060.0mm
B Load Height	35.75" - 51.73"	908.0 - 1314.0mm
C Discharge Height	46.22" - 62.20"	1174.0 - 1580.0mm
D Overall Length	60.47"	1536.0mm
E Overall Width	54.00"	1371.0mm
F Belt Width	6.00"	152.0mm
G Conveyor Belt Center Line	7.00"	178.0mm

CapStar Cap Feeder Technical Specifications

Cap Sizes, Rates and Orientation

Shibuya Hoppmann has tested these different cap sizes and verified the corresponding rates and orientations. The results for you, however, may vary depending upon part material/construction, weight bias and other uncontrolled factors.

Cap Size	Feed Rate	Orientation
1.25" tall x 1.63" diameter	100 ppm	diameter to diameter : cavity down
1.56" tall x 2.13" diameter	80 pps	diameter to diameter : cavity up
1.00" tall x 1.38" diameter	110 ppm	diameter to diameter : cavity up
1.00" tall x 1.38" diameter	62 ppm	diameter to diameter : cavity down
.50" tall x 1.63" diameter	360 ppm	diameter to diameter : cavity up
.50" tall x 1.63" diameter	203 ppm	diameter to diameter : cavity down
.68" tall x 1.09" diameter	260 ppm	diameter to diameter : cavity up
.68" tall x 1.09" diameter	125 ppm	diameter to diameter : cavity down
.75" tall x 1.25" diameter	420 ppm	diameter to diameter : cavity up
.75" tall x 1.25" diameter	85 ppm	diameter to diameter : cavity down
.63" tall x 1.81" diameter	115 ppm	diameter to diameter : cavity up
.63" tall x 1.81" diameter	225 ppm	diameter to diameter : cavity down
.63" tall x 1.75" diameter	225 ppm	diameter to diameter : cavity up
.63" tall x 1.75" diameter	75 ppm	diameter to diameter : cavity down
.63" tall x 1.38" diameter	365 ppm	diameter to diameter : cavity up
.63" tall x 1.38" diameter	130 ppm	diameter to diameter : cavity down
.43" tall x 1.18" diameter	600 ppm	diameter to diameter : cavity up
.43" tall x 1.18" diameter	215 ppm	diameter to diameter : cavity down
.43" tall x 1.88" diameter	200 ppm	diameter to diameter : cavity up
.43" tall x 1.88" diameter	90 ppm	diameter to diameter : cavity down
.88" tall x 1.93" diameter	55 ppm	diameter to diameter : cavity up
.88" tall x 1.75" diameter	40 ppm	diameter to diameter : cavity up
.56" tall x 1.43" diameter	440 ppm	diameter to diameter : cavity up
.56" tall x 1.43" diameter	200 ppm	diameter to diameter : cavity down
.56" tall x 2.25" diameter	200 ppm	diameter to diameter : cavity up
.56" tall x 2.25" diameter	100 ppm	diameter to diameter : cavity up

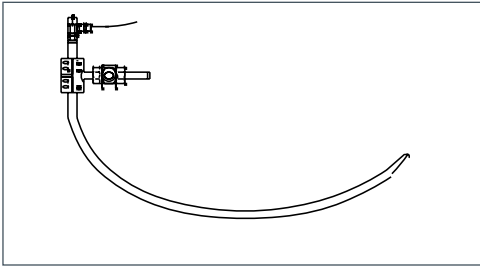

Air Ramps for FR Feeders

Air Ramps for the FR-20 and FR-30 Centrifugal Feeders:

FR-20 Air Ramp (Clockwise)	ARCWFR20SU
FR-20 Air Ramp (Counter-Clockwise)	ARCCFR20SU
FR-30 Air Ramp (Clockwise)	ARCWFR30SU
FR-30 Air Ramp (Counter-Clockwise)	ARCCFR30SU

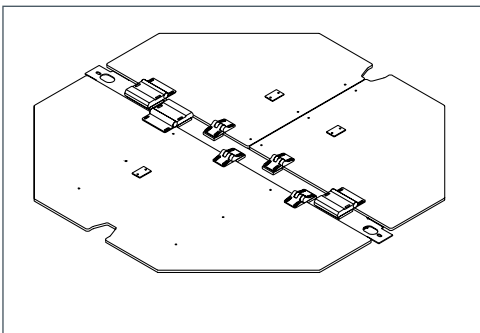

Feeder Safety Covers

Lexan Safety Covers:

FT-20 Lexan Bowl Covers	CVXXFT20LU
FT-30 Lexan Bowl Covers	CVXXFT30LU
FT-40 Lexan Bowl Covers	CVXXFT40LU
FT-50 Lexan Bowl Covers	CVXXFT50LU
CapStar Lexan Cover (4ft ³ Hopper)	CVCPST04LU
CapStar Lexan Cover (6ft ³ Hopper)	CVCPST06LU

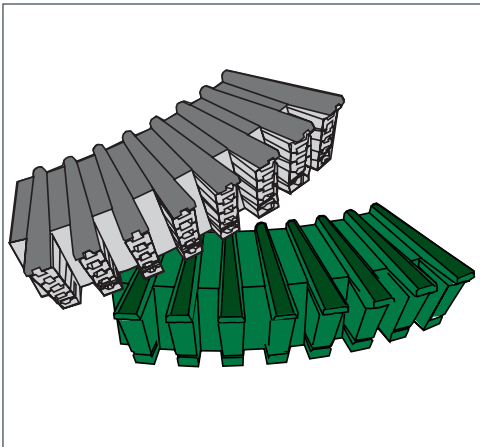

Urethane Scallop Kits

Urethane Scallops for the FS Series and FRS Series Feeders:

FS-30 (36) Scallop & Segment Plates	FS30SCAL36
FS-30 (48) Scallop & Segment Plates	FS30SCAL48
FS-30 (54) Scallop & Segment Plates	FS30SCAL54
FS-30 (60) Scallop & Segment Plates	FS30SCAL60
FS-30 (72) Scallop & Segment Plates	FS30SCAL72

FS-40 (36) Scallop & Segment Plates	FS40SCAL36
FS-40 (48) Scallop & Segment Plates	FS40SCAL48
FS-40 (54) Scallop & Segment Plates	FS40SCAL54
FS-40 (60) Scallop & Segment Plates	FS40SCAL60
FS-40 (72) Scallop & Segment Plates	FS40SCAL72

FS-50 (36) Scallop & Segment Plates	FS50SCAL36
FS-50 (48) Scallop & Segment Plates	FS50SCAL48
FS-50 (54) Scallop & Segment Plates	FS50SCAL54
FS-50 (60) Scallop & Segment Plates	FS50SCAL60
FS-50 (72) Scallop & Segment Plates	FS50SCAL72

FS-40 Segment Plates	URTHCAST10
FS-40 Individual Scallops	URTHCAST70
FS-50 Segment Plates	URTHCAST17
FS-50 Individual Scallops	URTHCAST82

FRS Individual Scallops	URTHCAST64
-------------------------	------------

Model No.	SHC Motor Part No.	Motor H.P.	SHC Reducer Part No.	Reducer Ratio	Estimated Weight (lbs/kg)	Bowl Inner Diameter	Bowl Outer Diameter
FT-10 (DC)	MOTRP.20HP	1/5	NMRV30M020	20:1	125 / 57	10"	13"
FT-15 (DC)	MOTRP.20HP	1/5	NMRV30M020	20:1	134 / 61	16"	20.5"
FT-15 (AC)	MOTRMAC.25	1/4	NMRV30M020	20:1	134 / 61	16"	20.5"
FT-20 (DC)	MOTRP.20HP	1/5	NMRV30M030	30:1	150 / 68	20.25"	25.75"
FT-20 (AC)	MOTRMAC.25	1/3	NMRV30M030	30:1	150 / 68	20.25"	25.75"
FT-30 (DC)	MOTRP.33HP	1/3	NMRL500030	30:1	350 / 159	28.80"	36.13"
FT-30 (AC)	MOTRAC0033-M	1/3	NMRL500030	30:1	350 / 159	28.80"	36.13"
FT-40 (DC) - Single and Dual Drive	MOTRPM0102	1/2	NMRL500040	40:1	850 / 385	36.25"	43.46"
FT-40 (AC) - Single and Dual Drive	MOTRAC0050-M	1/2	NMRL500040	40:1	850 / 385	36.25"	43.46"
FT-50 (DC) -Single and Dual Drive	MOTRPM0102	1/2	NMRL500040	40:1	1050 / 476	47.75"	56.0"
FT-50 (AC) - Single and Dual Drive	MOTRAC0050-M	1/2	NMRL500040	40:1	1050 / 476	47.75"	56.0"
FT-60 (DC)	MOTRPM0304	3/4	NMRL630040	40:1	1400 / 635	60"	70"
FT-60 (AC)	MOTRAC0075-M	3/4	NMRL630040	40:1	1400 / 635	60"	70"
FT-60 (DC) Dual Dr. Disc Drive Motor Bowl Drive Motor	MOTRPM0102 MOTRPM0304	1/2 3/4	NMRL500040 NMRL630040	40:1 40:1	1450 / 658	60"	70"
FT-60 (AC) Dual Dr. Disc Drive Motor Bowl Drive Motor	MOTRAC0050-M MOTRAC0075-M	1/2 3/4	NMRL500040 NMRL630040	40:1 40:1	1450 / 658	60"	70"
FS-20 (DC)	MOTRP.33HP	1/3	NMRV500100	100:1	400 / 181	20.25"	25.50"
FS-20 (AC)	MOTRAC0033-M	1/3	NMRV500100	100:1	400 / 181	20.25"	25.50"
FS-30 (DC)	MOTRP.33HP	1/3	NMRV500100	100:1	450 / 204	28.79"	36.00"
FS-30 (AC)	MOTRAC0033-M	1/3	NMRV500100	100:1	450 / 204	28.79"	36.00"

Model No.	SHC Motor Part No.	Motor H.P.	SHC Reducer Part No.	Reducer Ratio	Estimated Weight (lbs/ kg)	Bowl Inner Diameter	Bowl Outer Diameter
FS-40 (DC)	MOTRPM0102	1/2	NMRV630100	100:1	1050 / 476	36.25"	43.46"
FS-40 (AC)	MOTRAC0050-M	1/2	NMRV630100	100:1	1050 / 476	36.25"	43.46"
FS-50 (DC)	MOTRPM0304	3/4	NMRV630100	100:1	1200 / 545	47.75"	55.90"
FS-50 (AC)	MOTRAC0075-M	3/4	NMRV630100	100:1	1200 / 545	47.75"	55.90"
FS-60 (DC)	CDP3445	1.0	NMRV750100	100:1	3500 / 1587	60.00"	70.00"
FS-60 (AC)	MOTRAC0100-M	1.0	NMRV750100	100:1	3500 / 1587	60.00"	70.00"
FR-20 (DC)	MOTRP.20HP	1/5	NMRV30M030	30:1	210 / 95	20.17"	24.81"
FR-20 (AC)	MOTRMAC.25	1/4	NMRV30M030	30:1	210 / 95	20.17"	24.81"
FR-30 (DC)	MOTRP.20HP	1/5	NMRV30M030	30:1	350 / 159	28.87	36.13"
FR-30 (AC)	MOTRMAC.25	1/4	NMRV30M030	30:1	350 / 159	28.87	36.13"
FTF-30 (DC)	MOTRPMWD33	1/3	NMRL500030	30:1	345 / 156	28.79"	36.13"
FTF-40 (DC)	MOTRPMWD50	1/2	NMRL500040	40:1	850 / 385	36.25"	43.46"
FTF-50 (DC)	MOTRPMWD50	1/2	NMRL500040	40:1	1050 / 476	47.75	56.0"

*For more specific information on the individual specifications of each motor, please see Motor Specifications.

Labelers

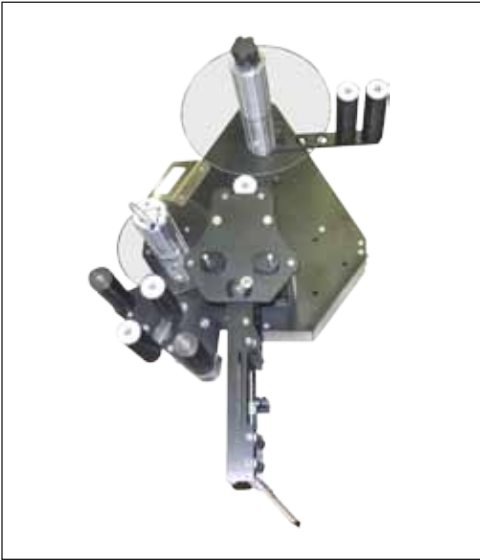

Pressure Sensitive Labeler

Shibuya Hoppmann has designed and built custom labelers and labeling systems for a variety of needs: from harsh environment applications to full color print and apply. We can integrate container unscrambling and labeling systems, part feeding systems, case handling systems and individual workstations or even completely automated systems.

The Print & Apply label applicators are modular in design and created so that they can be used in almost any application where a print and apply pressure sensitive label is required. A variety of printer options and assortment of interchangeable application modules are available. Systems can handle media widths up to 7 inches, at print speeds up to 12 inches per second. Software for all available modules lies resident in the base unit, allowing existing systems to be easily re-configured or upgraded without programming changes.



Print & Apply Labeler

The Pressure Sensitive label heads are available in both high-speed system configuration or as stand-alone heads. With label speed capabilities ranging from 1,850 to 3,543 inches per minute, these robust units are suitable for almost any application. Stand-alone systems are available with tamp-on, blow-on or tamp-blow application accessories.

There are other labeling systems, from rotary stand alone units to inline labelers. Our systems can be fully configured and are designed with the needs of the contract packager and the demanding end-user in mind.

L200A Label Applicator



Product Overview:

The L200A pressure sensitive label applicator is the proven, economical solution designed to meet the demands of expanding labeling requirements and higher production speeds. Durable, industrial-grade construction assures you that the L200A label applicator will provide around-the-clock operation you can depend on. The easy to use operator interface allows for quick changes to label speeds and position. Flexible design features and multiple application options allow you to easily tailor the L200A to cover your specific labeling needs.

Labeling Rate (PPM)	150ppm to 300ppm *
Label Head Speed	1,000"/min (423mm/sec)
Accuracy	± 0.02" (± 0.5mm)
Controls	Programmable Logic Controller
Label Drive Motor	High Torque Micro Stepper
Unwind Roll Diameter	12" (305mm) OD x 3" (76mm) ID
Label Detection	Photo Electric
Power Requirements	115/230VAC, 50/60 Hz, 8 Amp
Environment	41-104°F (5-40°C), 25-85% relative humidity

*Dependent upon label and application

Standard Features:

- On board diagnostics
- Product recipe capabilities
- On-the-fly label adjustments
- No tool required label changeover
- Streamline footprint
- Assortment of modules including Tamp

Available Options:

- Tamp-On, Blow-On, Tamp-Blow and Wipe-On modules
- Swing arm pallet labeler
- Wipe-On brush accessory kits
- Harsh environment head
- Line encoder kit upgrades
- Label low level sensor & beacon fault upgrades
- Adjustable stands and machine mount supports

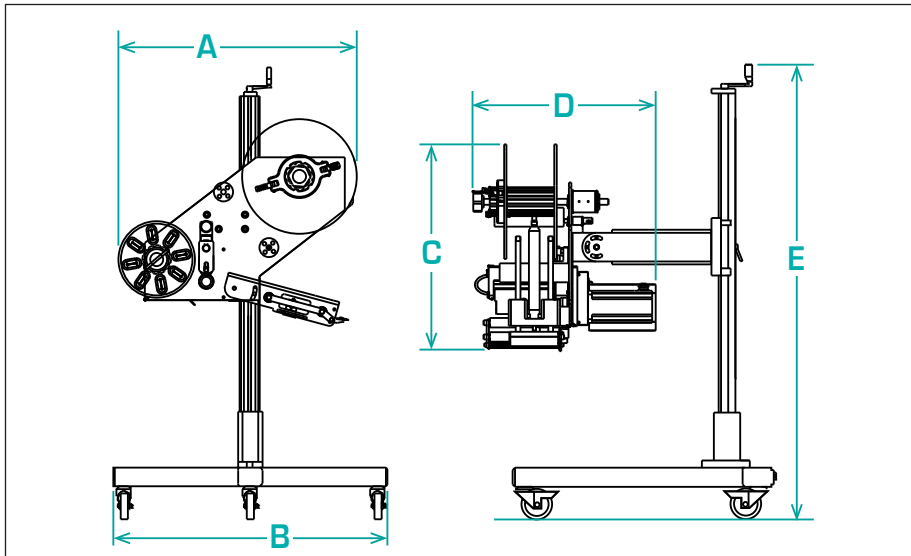

Product Specifications		ANSI	Metric
A	Length - Rewind Wheel to Peeler Plate	26.1"	663mm
B	Length - Rewind Wheel to Unwind Wheel	24.9"	633mm
C	Applicator Height	23.3"	592mm
D	Applicator Depth	19.2"	488mm
E	Overall Height (Stand)	67.77"	1721mm

L410A Label Applicator



Product Overview:

The L410A pressure sensitive label applicator is the proven, robust solution designed to meet the demands of expanding labeling requirements and higher production speeds. Durable, industrial-grade construction assures you that the L410A label applicator will provide around-the-clock operation you can depend on. The easy to use operator interface allows for quick changes to label speeds and position. Flexible design features and multiple application options allow you to easily tailor the L410A to cover your specific labeling needs.

Labeling Rate (PPM)	150ppm to 300ppm *
Label Head Speed	2,400"/min (1016mm/sec)
Accuracy	± 0.02" (± 0.5mm)
Controls	Programmable Logic Controller
Label Drive Motor	High Torque Micro Stepper
Unwind Roll Diameter	14" (376mm) OD x 3" (76mm) ID
Label Detection	Photo Electric
Power Requirements	115VAC, 50/60Hz, 6 Amp, or 230VAC, 50/60 Hz, 3 Amp
Environment	41-104°F (5-40°C), 25-85% relative humidity

*Dependent upon label and application

Standard Features:

- On board diagnostics
- Product recipe capabilities
- On-the-fly label adjustments
- No tool required label changeover
- Dual nip roller for less web breakage
- Streamline footprint
- Assortment of modules including Tamp
- Right-hand and left-hand
- Coding/inspection accommodation

Available Options:

- Tamp-On, Blow-On, Tamp-Blow and Wipe-On modules
- Swing arm pallet labeler
- Wipe-On brush accessory kits
- Harsh environment head
- Line encoder kit upgrades
- Label low level sensor & beacon fault upgrades
- Adjustable stands and machine mount supports

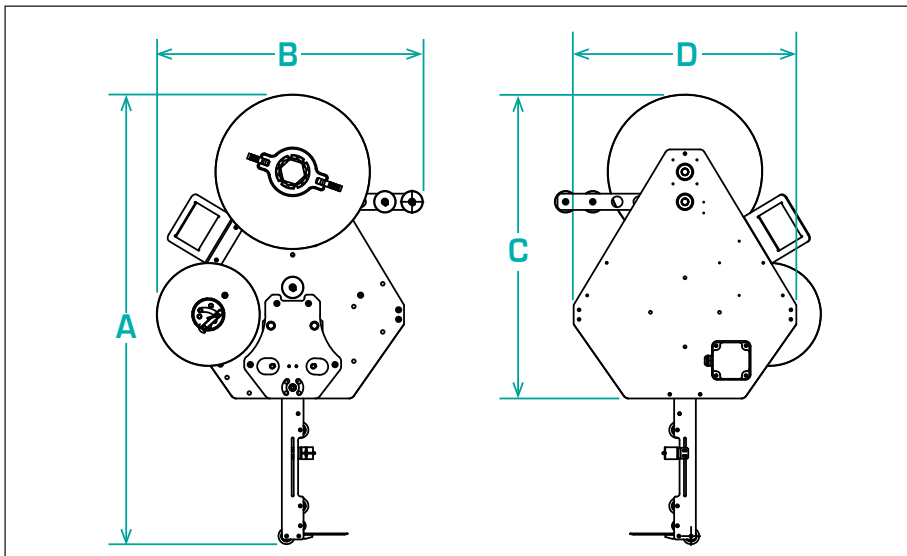

Product Specifications		ANSI	Metric
A	Overall Height - Peeler Tip to Unwind Wheel	41.4"	1052mm
B	Overall Width - Rewind Wheel to Dancer Arm	24.5"	622mm
C	Applicator Height	23.0"	584mm
D	Applicator Width	20.5"	521mm

Shibuya Hoppmann™

L510A Label Applicator

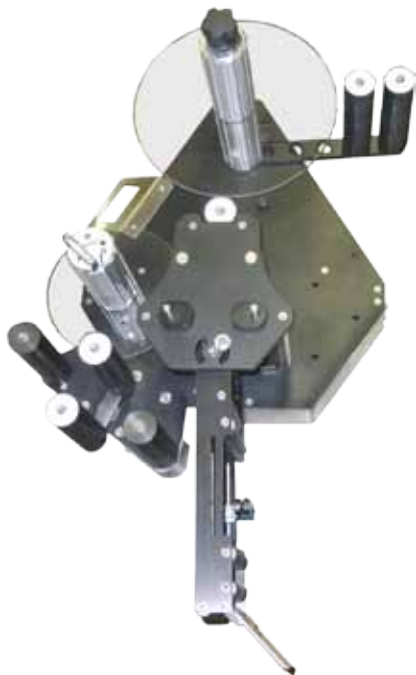

Product Overview:

The L510A pressure sensitive label head is designed to meet the needs of stand-alone applications, or the integration of multiple label heads into high speed product handling systems. The L510A label applicators are ergonomically designed to provide user friendly, seamless solutions for today's most demanding labeling applications. The unprecedented convertibility of the L510A chassis allows the label head to be converted from right-hand to left-hand justified, or vice versa.

Labeling Rate (PPM)	Up to 800ppm *
Label Head Speed	3,500"/min (1482mm/sec)
Accuracy	± 0.02" (± 0.5mm)
Controls	Stepper Controller
Label Drive Motor	High Torque Micro Stepper
Unwind Roll Diameter	14" (376mm) OD x 3" (76mm) ID
Label Detection	Photo Sensor
Power Requirements	115 VAC, 50/60 Hz, 6 Amps or 230 VAC, 50/60 Hz, 3 Amps
Environment	41-104°F (5-40°C), 25-85% relative humidity

*Dependent upon label and application

Standard Features:

- On board diagnostics
- Advance through missing labels
- Product recipes
- On-the-fly web adjustments
- No tool required label changeover
- Label head applicator widths in 4", 6" and 8"
- Dual nip roller for less web breakage
- Coding/inspection accommodation
- Streamline footprint
- Assortment of modules including Tamp
- Right-hand and left-hand

Available Options:

- Tamp-On, Blow-On, Tamp-Blow and Wipe-On modules
- Wash-down head
- Harsh environment head
- Line encoder kit upgrades
- Various label applicator accessories: brush, roller, etc.
- Label low level sensor & beacon fault upgrades
- Adjustable stands and machine mount supports

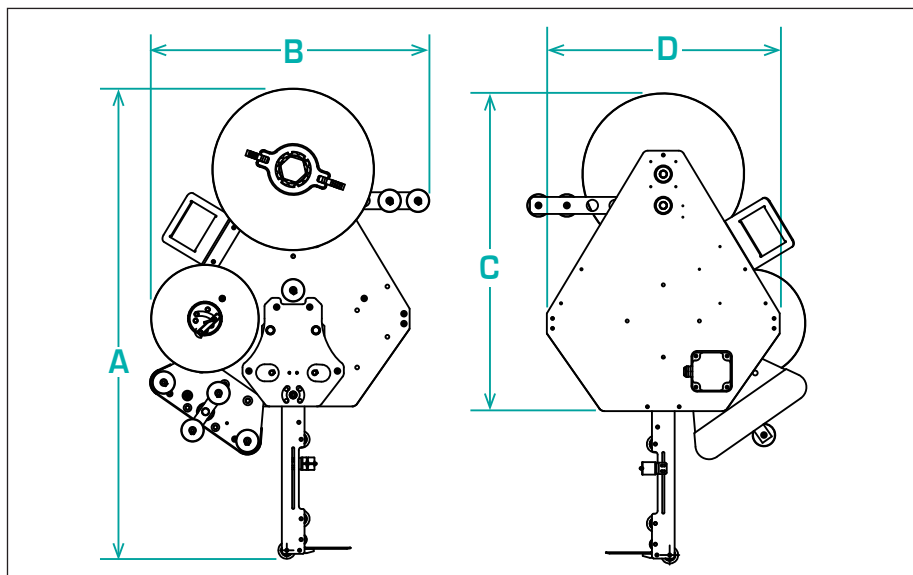

Product Specifications		ANSI	Metric
A	Overall Height	41.4"	1052mm
B	Overall Width	24.6"	625mm
C	Labeler Base Height	23.0"	584mm
D	Labeler Base Width	20.5"	521mm

L3500PA Label Applicator

Product Overview:

The L3500PA redefines the economics of printer applicators. Available with multiple printer options and a variety of application choices including tamp-on, blow-on and wipe-on, the L3500PA provides you with flexibility to meet all your labeling needs. The robust construction protects key components from the rigors of industrial use. Label speeds are determined by the print engine manufacturer.



Accuracy	± 0.032" (± 0.81mm)
Controls	PLC based control, HMI Touchscreen Interface
Unwind Roll Diameter	12" (305mm) OD x 3" (76mm) ID
Product Detection	Photo Eye
Machine Interface	External Sub D Connectors
Air Requirements	80 psi @ 2.2 CFM
Power Requirements	115 or 220 VAC, 50/60 Hz, 6 Amps
Environment	41-104°F (5-40°C), 25-85% relative humidity

Standard Features:

- No tool label roll changeover
- Rugged construction: solid aluminum front plate, 1" x 2" solid steel U-Arm
- Standard 12" (305mm) label supply roll
- HMI touchscreen interface
- Stainless steel and black anodized construction
- Multi-language menu display

Available Upgrades:

- Tamp-On, Blow-On, Tamp-Blow and Corner-Wrap modules
- Soft-Tamp module detects product locations
- Extended length tamp modules (up to 24")
- Remote operator panel
- Horizontal positioning device
- Label low level sensor & beacon fault upgrades
- Adjustable stands and machine mount supports
- Auxiliary air valve for add-on modules or for product handling pneumatics
- Optional 18" (457mm) supply roll upgrade
- Powered unwind and rewind spools

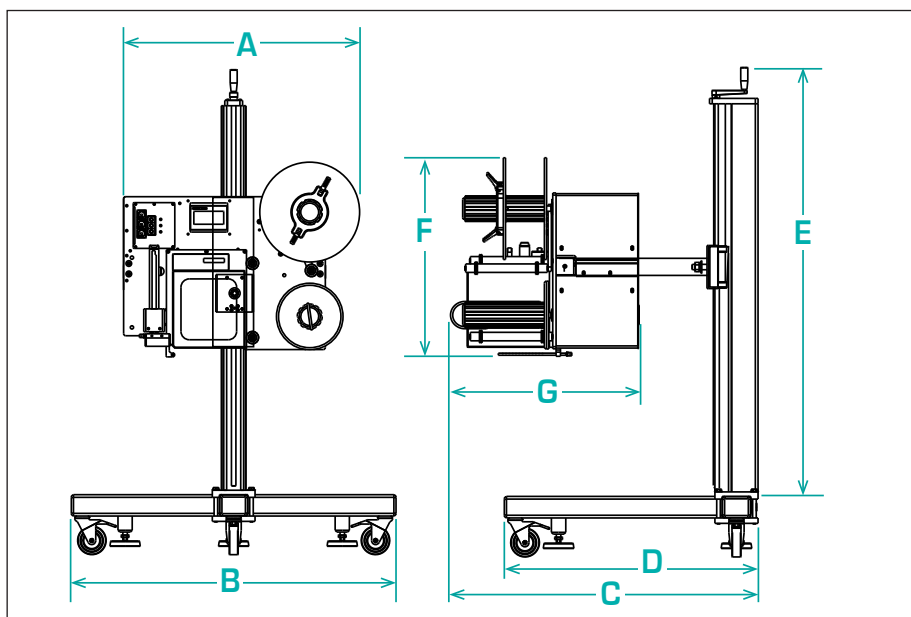

Product Specifications		ANSI	Metric
A	Applicator Width	30.38"	772mm
B	Overall Width	45.50"	1156mm
C	Overall Depth	38.4"	976mm
D	Frame Depth	34.25"	870mm
E	Stand Height	62.52"	1588mm
F	Applicator Height	24.15"	613mm
G	Applicator Depth	21.45"	545mm

Shibuya Hoppmann Part #: MOTR010875	
Specification Number	4175
Horsepower	1/8hp
Armature Voltage	130
Hertz	60
RPM	8.3
Frame Size	42 A
Rating	-----
Enclosure	
Manufacturer	Bodine 4175

Shibuya Hoppmann Part #: MOTR013021	
Specification Number	1LPWZ
Horsepower	1/30hp
Armature Voltage	90
Hertz	60
RPM	21
Frame Size	-----
Rating	40C
Enclosure	TENV
Manufacturer	Grainger 1LPWZ

Shibuya Hoppmann Part #: MOTR013021	
Specification Number	1LPWZ
Horsepower	1/30hp
Armature Voltage	90
Hertz	60
RPM	21
Frame Size	-----
Rating	40C
Enclosure	TENV
Manufacturer	Grainger 1LPWZ

Shibuya Hoppmann Part #: MOTRP.20HP	
Specification Number	24A757Z243
Horsepower	1/5hp
Armature Voltage	90
Hertz	60
RPM	1800
Frame Size	M63B14
Rating	40C
Enclosure	TENV
Manufacturer	Baldor 24A757Z243

Shibuya Hoppmann Part #: MOTRAC25HP	
Specification Number	33E178W020G1
Horsepower	1/4hp
Armature Voltage	208-230/460, 3 Phase
Hertz	60
RPM	1725
Frame Size	42 CZ
Rating	40C
Enclosure	TENV
Manufacturer	Baldor 33E178W020G1

Shibuya Hoppmann Part #: MOTRP.25HP	
Specification Number	33-2024Z118
Horsepower	1/4 (0.25) hp
Armature Voltage	90
Hertz	60
RPM	1750
Frame Size	56C
Rating	40C
Enclosure	TENV
Manufacturer	Baldor CDP3310

Shibuya Hoppmann Part #: MOTRAC0025	
Specification Number	34A63-894
Horsepower	1/4 (0.25) hp
Armature Voltage	230/460
Hertz	60
RPM	1725
Frame Size	56C
Rating	40C AMB-CONT
Enclosure	TEFC
Manufacturer	Baldor KM3454

Shibuya Hoppmann Part #: MOTRP33HP	
Specification Number	33-2024Z102
Horsepower	0.33hp
Armature Voltage	90
Hertz	60
RPM	1750
Frame Size	56C
Rating	40C
Enclosure	TENV
Manufacturer	Baldor CDP3320

Shibuya Hoppmann Part #: MOTRAC0033	
Specification Number	34A63-884
Horsepower	0.33hp
Armature Voltage	230/460
Hertz	60
RPM	1725
Frame Size	56C
Rating	40C AMB-CONT
Enclosure	TEFC
Manufacturer	Baldor VM3534

Shibuya Hoppmann Part #: MOTRAC0075	
Specification Number	24A63-883
Horsepower	3/4hp
Armature Voltage	208-230/460, 3 Phase
Hertz	60
RPM	1725
Frame Size	56C
Rating	40C AMB-CONT
Enclosure	TEFC
Manufacturer	Baldor VM3542

Shibuya Hoppmann Part #: MOTRPM0102	
Specification Number	33-2024Z122
Horsepower	1/2 (0.50)hp
Armature Voltage	90
Hertz	60
RPM	1750
Frame Size	56C
Rating	40C
Enclosure	TENV
Manufacturer	Baldor CDP3330

Shibuya Hoppmann Part #: MOTRAC0050	
Specification Number	34A63-872
Horsepower	1/2 (0.50)hp
Armature Voltage	230/460
Hertz	60
RPM	1725
Frame Size	56C
Rating	40C AMB-CONT
Enclosure	TEFC
Manufacturer	Baldor VM3538

Shibuya Hoppmann™

Warranty

Shibuya Hoppmann Corporation warrants that each item of its own manufacture delivered hereunder shall, at the time of delivery and for a period of twelve (12) months thereafter, be free from defects in materials or workmanship; and if any such item shall prove to be defective in material or workmanship under normal intended usage and maintenance during the warranty period, upon examination by Shibuya Hoppmann Corporation, then Shibuya Hoppmann Corporation shall repair or replace, at its sole option, such defective item at its own expense; provided, however, that the owner shall be required to ship such defective item, freight prepaid, to Shibuya Hoppmann Corporation's plant in Virginia. The warranty on components not manufactured by Shibuya Hoppmann Corporation, but a part of the system, is limited to the warranty provided by the original manufacturer of said components to the extent, and only to the extent, that such original manufacturer actually honors such warranty.

ALL WARRANTIES HEREUNDER ARE EXPRESSLY LIMITED TO THE REPAIR OR REPLACEMENT OF DEFECTIVE ITEMS AS SET FORTH HEREIN, AND IN NO EVENT SHALL SHIBUYA HOPPMANN CORPORATION BE LIABLE FOR SPECIAL, INCIDENTAL OR CONSEQUENTIAL DAMAGES BY REASON OF ANY BREACH OF WARRANTY OR DEFECT IN MATERIAL OR WORKMANSHIP. SHIBUYA HOPPMANN CORPORATION SHALL NOT BE RESPONSIBLE FOR REPAIR OR REPLACEMENT OF ITEMS WHICH HAVE BEEN SUBJECTED TO NEGLIGENCE, ACCIDENT OR IMPROPER USE, OR WHICH HAVE BEEN ALTERED BY OTHER THAN AUTHORIZED SHIBUYA HOPPMANN CORPORATION PERSONNEL.

THIS WARRANTY IS IN LIEU OF OTHER WARRANTIES, EXPRESS OR IMPLIED. ALL IMPLIED WARRANTIES, INCLUDING BUT NOT LIMITED TO THE IMPLIED WARRANTIES OF MERCHANTABILITY AND FITNESS FOR A PARTICULAR PURPOSE, ARE HEREBY EXCLUDED.

Shibuya Hoppmann™

7849 Coppermine Drive, Manassas, VA 20109
800.368.3582 | Sales@ShibuyaHoppmann.com

www.ShibuyaHoppmann.com

Follow us on Facebook, Twitter and YouTube for more information!



Facebook.com/
ShibuyaHoppmann



Twitter.com/
ShibuyaHoppmann



YouTube.com/
ShibuyaHoppmann