

As a global market leader and expert in automated handling systems, CSI palletising offers innovative, efficient, cost-effective and reliable solutions for customers worldwide. We offer tailor-made systems with high performance and first-class components. Delivering a high level of reliability requires good understanding of our customers' needs. Creating solutions together, through smart data analysis and intensive collaboration with customers and product specialists, guarantees an automated system that is optimally geared to the stretch targets set by our customers.

## Multi line robotic palletising

- ✓ boosting the efficiency of your production line
- ✓ always a perfect fit in the space
- ✓ short installation time
- ✓ short payback time
- ✓ user friendly handling

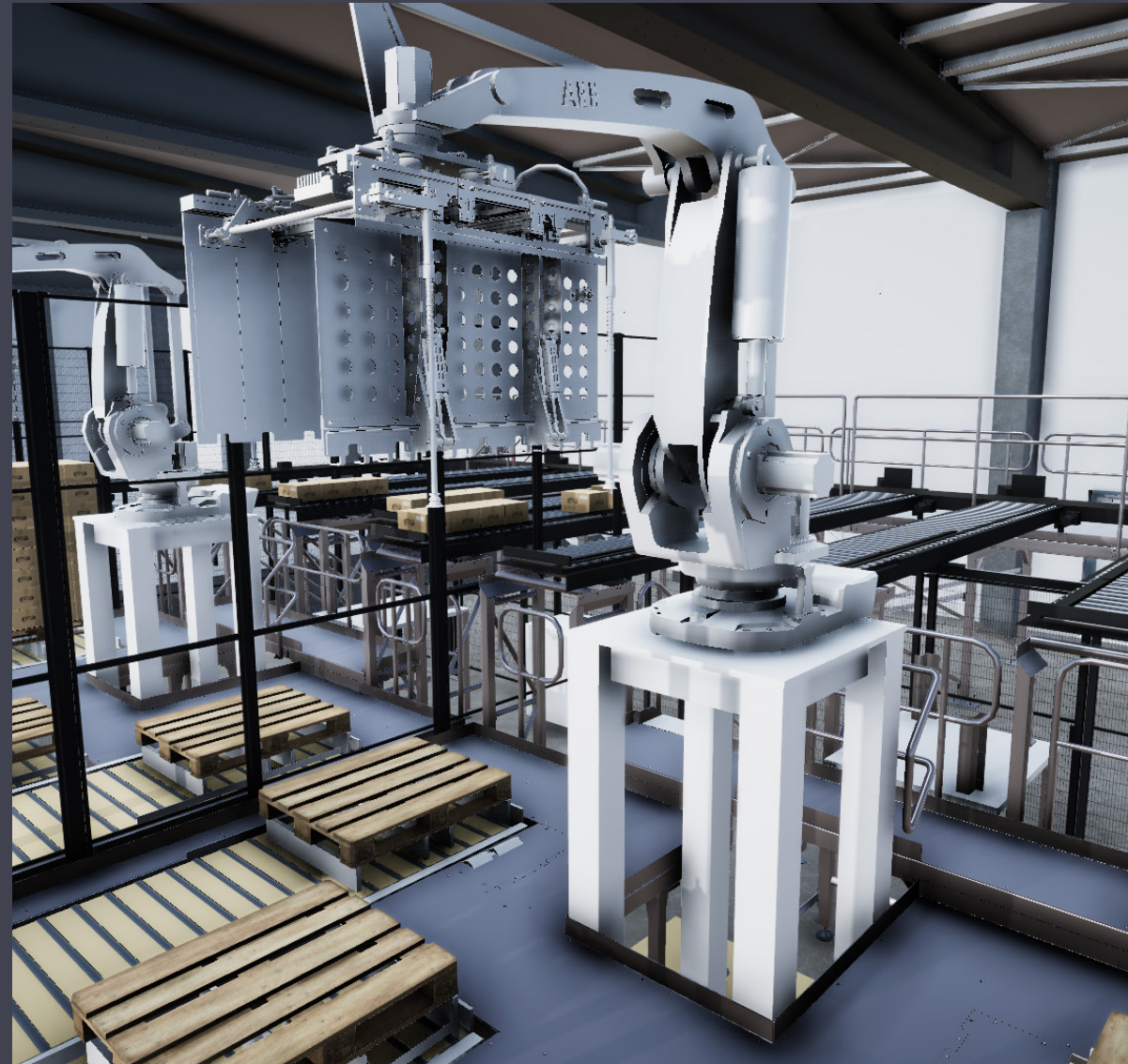

# LINE<sup>X</sup>

LINE<sup>X</sup> is a freely and flexibly configurable robot palletising cell. The cells are configured on the basis of standardized, proven modules, produced in our low-cost manufacturing plant. This results in very competitive palletiser units. The LINE<sup>X</sup> can be used as an end-of-line solution or centrally located in a multi-line system. All product handling grippers are suitable for the reliable and secure handling of a wide range of products.

## High efficiency

LINE<sup>X</sup> offers different palletiser configurations that suit your production and integrates the latest ABB/FANUC technology in robotics to ensure high efficiency and reliability.

## 3-year warranty

With almost 60 years of experience, we have a high-quality standard. All our palletisers come with a standard 3-year warranty.

## Infinite possibilities

The exponentiation to the variable power X represents the numerous possibilities and variety of configurations LINE<sup>X</sup> has to offer. The specific needs of our customers can therefore always be met.

## Characteristics

- high safety levels according to performance level PLD
- savings because of compact footprint
- flexible layout
- multi-line connections
- prepared for connections with upstream and downstream
- tailor-made concepts with standardised modules
- enabling vertical start-up

<b>Pallet transport height</b>	500 - 1000 mm
<b>Product infeed height</b>	2600 - 3000 mm
<b>Line connection</b>	1 - 4
<b>Capacity</b>	up to 10 strokes per minute 1200 mm per stroke
<b>Loading height</b>	Up to 2650 mm
<b>Robot</b>	ABB or Fanuc
<b>Controls platform</b>	Allen Bradley or Siemens
<b>Footprint</b>	2 lines: W3.8 x L6.8m 4 lines: W6.2 x L6.8m
<b>Product dimensions</b>	Min L150 x W120 x H80 mm Max L800 x W600 x H600 mm
<b>Product weight</b>	Max 65kg per stroke
<b>Product types</b>	Cartons, trays, shrink packs and crates
<b>Pallet types</b>	Euro, CHEP, GMA, Düsseldorfer, plastic pallets
<b>Pallet weight</b>	Max. 1300kg

## Options

- Slipsheets
- Pallet dispensing
- Double stacking of pallets
- Label / display orientation
- cULus listed, fit for the US and Canadian market
- Patternware, easy programming of new pallet patterns
- Remote service VPN connection

Start saving money, go to [CSiportal.com](http://CSiportal.com) and lease or buy your own smart palletiser today.



**CSi palletising**

internet [CSiportal.com](http://CSiportal.com) • e-mail [info@CSiportal.com](mailto:info@CSiportal.com)